

LOCAL AGENCY FORMATION COMMISSION OF MARIN COUNTY

RESOLUTION NO. 74-30

RESOLUTION MAKING DETERMINATIONS AND APPROVING THE ANNEXATION OF
TERRITORY DESIGNATED AS DIABLO AVENUE ANNEXATION 1974-7
TO SANITARY DISTRICT NO. 6

WHEREAS, a proposal for the annexation of certain territory to Sanitary District No. 6 in the County of Marin, has been filed with the Executive Officer of this Commission; and

WHEREAS, said proposal was made in the form of Resolution No. 1456, a resolution of application adopted by the Board of Directors of Sanitary District No. 6, and requesting the initiation of annexation proceedings pursuant to the District Reorganization Act of 1965, Division 1 (commencing with Section 56000) of Title 6 of the Government Code; and

WHEREAS, said resolution of application was accompanied by written consent signed by all owners of land within the territory proposed to be annexed; and

WHEREAS, pursuant to Government Code Section 56261, when a resolution of application is accompanied by written consent of all owners of land within the territory proposed to be annexed, this Commission may make determinations with respect to said application without notice and hearing,

NOW THEREFORE, the Local Agency Formation Commission of the County of Marin, DOES HEREBY RESOLVE, DETERMINE AND ORDER as follows:

1. Subject to the terms and conditions hereinafter specified the proposal made by Resolution No. 1456 adopted by the Board of Directors of Sanitary District No. 6 is approved.
2. The boundaries of the territory proposed to be annexed shall be those set forth in the proposal filed with this Commission; and said territory shall be designated as Diablo Avenue Annexation 1974-7 and is found to be uninhabited.
3. Any resolution ordering the annexation approved by this resolution shall provide that such annexation is ordered subject to terms and conditions specified in the resolution of application.
4. Sanitary District No. 6 is designated as the conducting district for further proceedings; and the Board of Directors of said district is hereby directed to initiate proceedings in compliance with this resolution, and is authorized to proceed without notice or hearing pursuant to Government Code Section 56261.
5. The Executive Officer is hereby authorized and directed to mail certified copies of this resolution in the manner and as described in Section 56272 of the Government Code.

PASSED AND ADOPTED by the Marin County Local Agency Formation Commission
on this 17th day of July, 1974, by the following vote:

AYES: Commissioners Baptist, Jones, Mulryan and Marchant

NOES: None

ABSENT: Commissioner Giacomini

ABSTAIN:



Hugh G. Marchant Chairman, Local Agency
Formation Commission of the County of Marin

ATTEST:



Lari Sheehan, Executive Officer

SANITARY DISTRICT NO. 6 OF MARIN COUNTY

DIABLO AVENUE ANNEXATION 1974-7

EXHIBIT "A"

Beginning at a point on the centerline of Diablo Avenue, distant thereon North 29° 15' East 539.30 feet from the southwest corner of Lot 97, as said Avenue and Lot are shown upon that certain map entitled, "Map of Subdivisions 'A' and 'B' of the Novato Ranch, Marin County, California", filed November 18, 1909 in Volume 3 of Maps at page 36, Marin County Records; running thence from said point of beginning along said Sanitary District boundary and along said centerline of Diablo Avenue, South 29° 15' West 269.30 feet; thence leaving said centerline of Diablo Avenue and continuing along said Sanitary District boundary South 60° 45' East 330 feet; thence North 29° 15' East 156 feet to the centerline of the drainage ditch (Warner Creek) running through said lot; thence leaving said Sanitary District boundary and running northwesterly along the center of said drainage ditch to the point of beginning.

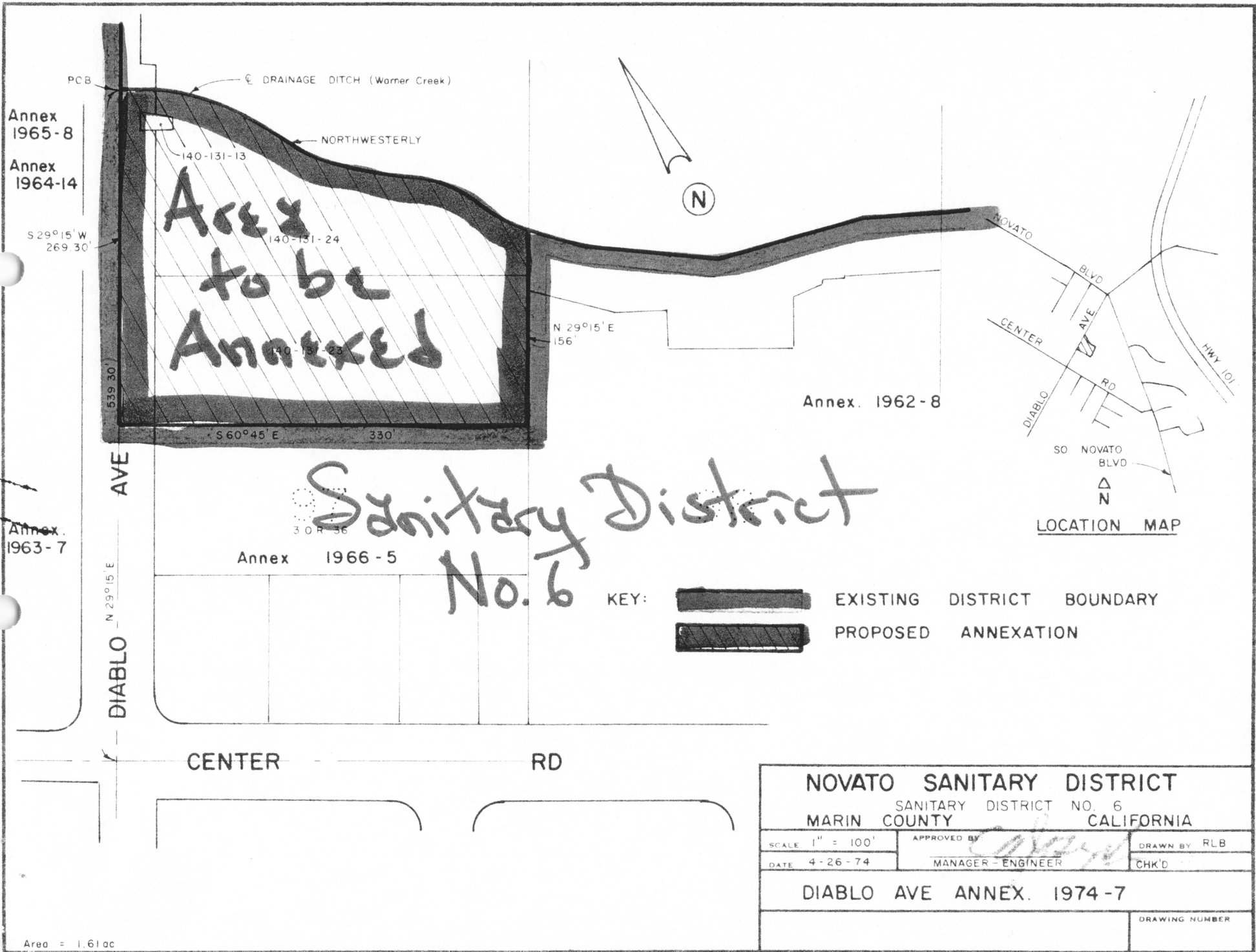

Annex
1965-8

Annex
1964-14

S 29° 15' W
269.30'

**Area
to be
Annexed**

DIABLO AVE
N 29° 15' E

Annex.
1963-7

Annex 1966-5

**Sanitary District
No. 6**

KEY: EXISTING DISTRICT BOUNDARY
 PROPOSED ANNEXATION

LOCATION MAP

NOVATO SANITARY DISTRICT
SANITARY DISTRICT NO. 6
MARIN COUNTY CALIFORNIA

SCALE 1" = 100'	APPROVED BY	DRAWN BY RLB
DATE 4-26-74	MANAGER-ENGINEER	CHK'D

DIABLO AVE ANNEX. 1974-7

DRAWING NUMBER

Area = 1.6100