

LOCAL AGENCY FORMATION COMMISSION OF MARIN COUNTY

RESOLUTION NO. 84-18

RESOLUTION MAKING DETERMINATIONS APPROVING WITH AMENDMENT
ANNEXATION TO THE NOVATO SANITARY DISTRICT

Vineyard Road Annexation 1984-6 (Rebelo)

WHEREAS, a proposal for the annexation of certain territory to the Novato Sanitary District in the County of Marin has been filed with the Executive Officer of this Commission; and

WHEREAS, said proposal was made in the form of Resolution No. 2090, a Resolution of Application adopted by the Board of Directors of the Novato Sanitary District, and requesting the initiation of annexation proceedings pursuant to the District Reorganization Act of 1965, Division 1 (commencing with Section 56000) of Title 6 of the Government Code; and

WHEREAS, the Executive Officer, pursuant to Government Code Section 56262, set December 13, 1984, as the hearing date on this proposal and gave the required notice of hearing; and

WHEREAS, the Executive Officer, pursuant to Government Code Section 54794, has reviewed this proposal and prepared a report including his recommendations thereon, and has furnished a copy of this report to each person entitled to a copy; and

WHEREAS, this Commission conducted a public hearing on December 13, 1984, heard from the interested parties, considered the proposal and the report of the Executive Officer, and considered the factors determined by the Commission to be relevant to this proposal.

NOW, THEREFORE, the Local Agency Formation Commission of the County of Marin DOES HEREBY RESOLVE, DETERMINE AND ORDER as follows:

Section 1. Subject to the terms and conditions hereinafter specified, the proposal made by Resolution No. 2090, adopted by the Board of Directors of the Novato Sanitary District, is approved with amendment.

Section 2. The boundaries of the territory to be annexed shall be those set forth in Exhibit A, attached hereto and incorporated herein; and said territory shall be designated as the "Vineyard Road Annexation 1984-6."

Section 3. Said territory is found to be inhabited.

Section 4. Any resolution ordering the annexation approved by this resolution shall provide that such annexation is ordered subject to Novato Sanitary District's terms and conditions as set forth in Exhibit B, attached hereto and incorporated herein.

Section 5. The Novato Sanitary District is designated as the conducting district for further proceedings, and the Board of Directors of said District is hereby directed to initiate proceedings in compliance with this resolution.

Section 6. In accordance with the California Environmental Quality Act (CEQA), the County of Marin is lead agency and LAFCo, acting as responsible agency, has considered the environmental effects of the annexation. The County has issued the project a Negative Declaration.

Section 7. The Executive Officer is hereby authorized and directed to mail certified copies of the resolution in the manner prescribed by Section 56272 of the Government Code.

PASSED AND ADOPTED by the Marin County Local Agency Formation Commission on this 13th day of December 1984 by the following vote:

AYES: Commissioners Boessenecker, Breiner, Bull, Giacomini and Stockwell

NOES: None

ABSENT: Commissioner McCart



ROBERT B. STOCKWELL, Chairman Pro Tem
Marin Local Agency Formation Commission

ATTEST:



WARREN K. NELSON, Executive Officer

DATE: December 14, 1984

Revised July 9, 1985

NOVATO SANITARY DISTRICT

VINEYARD ROAD ANNEX 1984-6

Exhibit "A"

Beginning at a point on the existing boundary of Novato Sanitary District, said point being on the westerly line of Lot 266, distant thereon South 23° 53' 25" West 1130.86 feet, South 19° 06' 19" East 256.08 feet and South 23° 24' 58" West 61.85 feet from the northwesterly corner of said Lot, as said Lot is shown upon that certain map entitled "Map of Subdivision 'F' of the Novato Ranch, Marin County, California", filed July 6, 1910 in Book 3 of Maps at Page 55, Marin County Records, said point also being the most southerly corner of that certain parcel shown upon that "Record of Survey of Portion of 'F' Ranch of the Rancho Nicasio, 3 R.O.S. 38, Marin County, California, filed March 14, 1975 in Book 12 of Surveys at Page 71, Marin County Records; thence leaving said westerly line of Lot 266 and running along said Sanitary District boundary and said westerly line of said "Record of Survey" parcel (12 O.S. 71) to the most westerly corner of said parcel; thence continuing along said Sanitary District boundary Southeasterly 395.91 feet; thence Northeasterly 100.82 feet; thence Northeasterly 313 feet, more or less; thence Northeasterly 155.10 feet; thence Northeasterly 130 feet, more or less; thence Northwesterly 240 feet, more or less; thence Southwesterly 215 feet, more or less; thence Northwesterly 128.20 feet; thence Northwesterly 55.91 feet; thence Northwesterly 66.82 feet; thence Southwesterly 344.72 feet; thence Northeasterly 143.75 feet; thence Northeasterly 211.16 feet; thence Southwesterly 569.47 feet; thence Southwesterly 360 feet; thence Northwesterly 350.02 feet; thence Northwesterly 176.19 feet to the most Northerly corner of Parcel 1 as said parcel is shown upon that certain Parcel Map entitled "Parcel Map, Division Of A Portion Of The Lands Of Mae Sanchez Being Part Of 'E' Ranch In Novato, County Of Marin, California", filed October 29 in Book 13 of Parcel Maps at Page 12, Marin County Records, said point also being a point on the easterly line of Parcel 2 of that certain Parcel Map entitled "Parcel Map, Lands Of Marin County Open Space District And North Marin County Water District Parcel 1 (O.R. 3312 Pg 607) Lands of Frank Rebelo Et. Ux. Parcel 2 (Remainder of O.R. 642 Pg 437) Marin County, California, recorded August 7th 1980 in Book 18 of Parcel Maps at Page 35, Marin County Records, running thence along said easterly line of Parcel 2 (18 P.M. 35) Northwesterly 526.38 feet, more or less to the most Northeasterly corner of said Parcel 2 (18 P.M. 35) thence leaving said Sanitary District boundary and running along the northerly, easterly, and westerly boundary of said Parcel 2 (18 P.M. 35) West 289.65 feet; thence South 31° 35' 21" West 775.12 feet; thence South 48° 15' 22" West 800.20 feet; thence South 11° 55' 00" West 260.30 feet; thence leaving said westerly line of Parcel 2 (18 P.M. 35) South 64° 18' 18" East 239.78 feet; thence South 47° 28' 34" East 328.96 feet; thence North 76° 53' 07" East 70.00 feet; thence South 22° 52' 26" East 77.53 feet; thence South 3° 58' 17" West 200.38 feet; thence South 22° 11' 53" West 195.39 feet; thence South 70° 41' 54" East 409.43 feet; thence North 13° 25' 07" East 150.57 feet; thence North 43° 58' 56" East 403.52 feet; thence South 38° 31' 49"

Vineyard Road Annex 1984-6

Revised July 9, 1985

East 564.55 feet; thence South $10^{\circ} 08' 27''$ East 329.26 feet; thence South $76^{\circ} 55' 32''$ East 630.01 feet; thence North $80^{\circ} 54' 58''$ East 672.23 feet, more or less to the easterly boundary of said Parcel 2 (18 P.M. 35); thence running along said easterly boundary South $28^{\circ} 07' 52''$ East 119.00 feet; thence South $50^{\circ} 43' 51''$ East 55.48 feet to a point on said westerly line of Lot 266 (3 O.R. 55); and on said Sanitary District boundary; thence leaving said easterly line of Parcel 2 (18 P.M. 35) and running along said westerly line of Lot 266 (3 O.R. 55) and along said Sanitary District boundary Northerly 125.94 feet to the point of beginning.

Containing 98 acres, more or less.

EXHIBIT B

NOVATO SANITARY DISTRICT

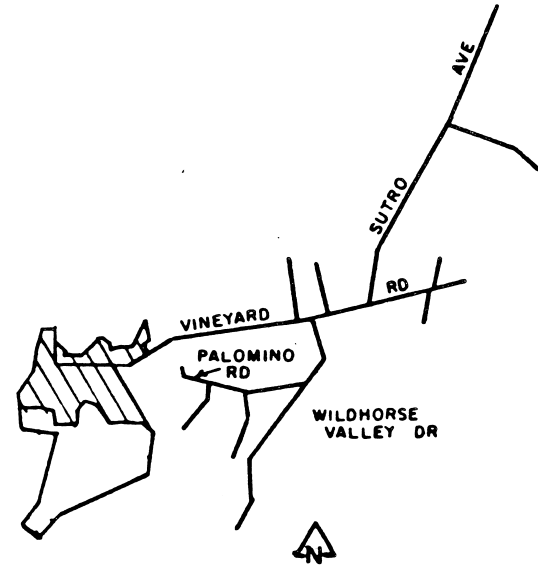
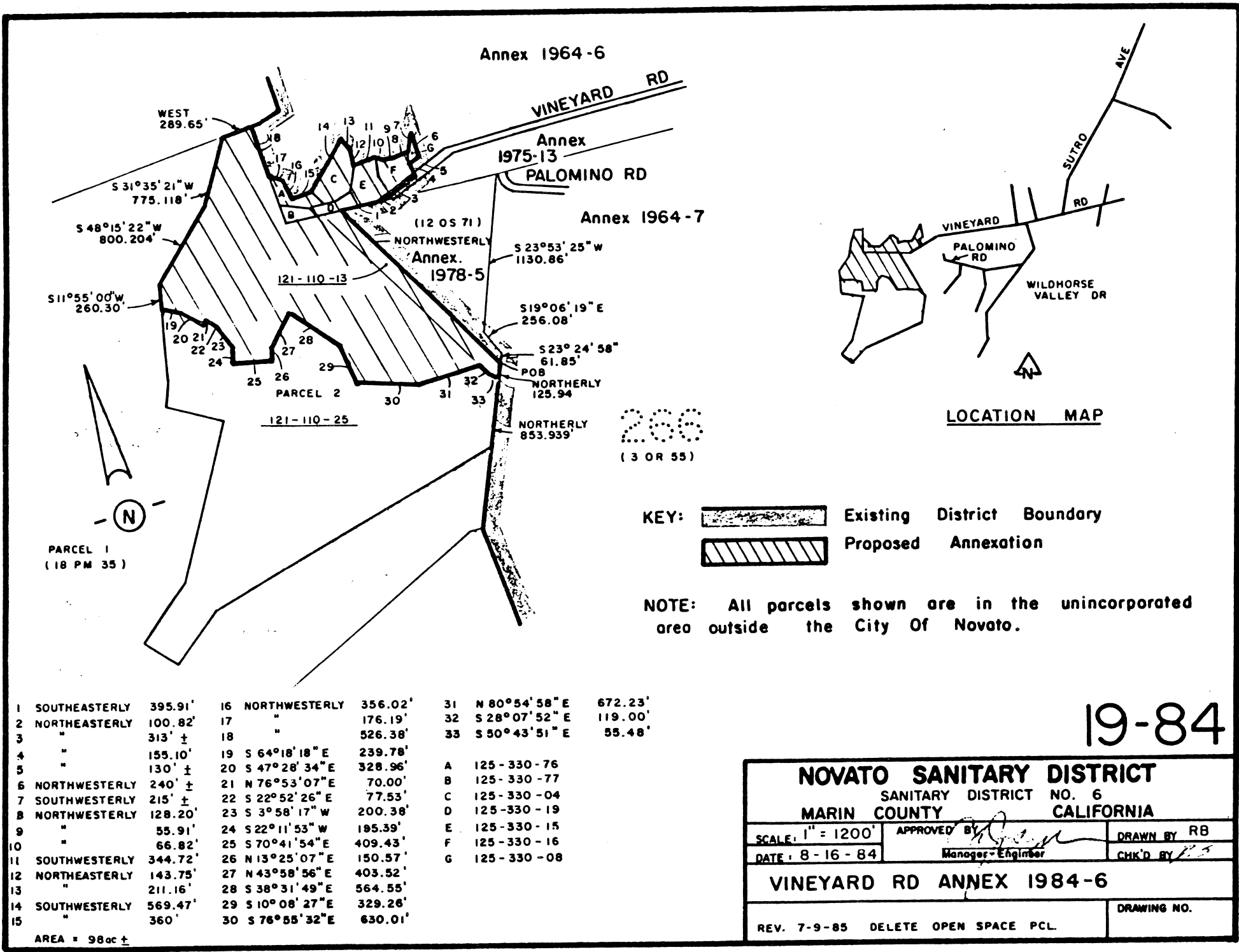

The annexation shall be subject to the following terms and conditions:

1. In the event that pursuant to rules, regulations or ordinances of the District, as now or hereafter amended, the District shall require any payment of a fixed or determinable amount of money, either as a lump sum or in installments, for the acquisition, transfer, use or right of use of all or any part of the existing property, real or personal, of the District; such payment will be made to the District in the manner and at the time as provided by the rules, regulations or ordinances of the District, as now or hereafter amended.
2. Upon and after the effective date of said annexation, the territory, all inhabitants within such territory, and all persons entitled to vote by reason of residing or owning land within the territory, shall be subject to the jurisdiction of the District; shall have the same rights and duties as if the territory has been a part of the District upon its original formation; shall be liable for the payment of principal, interest, and any other amounts which shall become due on account of any outstanding or then authorized but thereafter issued bonds, including revenue bonds, or other contracts or obligations of the District; shall be subject to the levying or fixing and collection of any and all taxes, assessments, service charges, rentals or rates as may be necessary to provide for such payment; and shall be subject to all of the rates, rules, regulations and ordinances of the District, as now or hereafter amended.



LOCATION MAP

286
(3 OR 55)

KEY:  Existing District Boundary
 Proposed Annexation

NOTE: All parcels shown are in the unincorporated area outside the City Of Novato.

1	SOUTHEASTERLY	395.91'	16	NORTHWESTERLY	356.02'	31	N 80°54'58"E	672.23'
2	NORTHEASTERLY	100.82'	17	"	176.19'	32	S 28°07'52"E	119.00'
3	"	313' ±	18	"	526.38'	33	S 50°43'51"E	55.48'
4	"	155.10'	19	S 64°18'18"E	239.78'	A	125-330-76	
5	"	130' ±	20	S 47°28'34"E	328.96'	B	125-330-77	
6	NORTHWESTERLY	240' ±	21	N 76°53'07"E	70.00'	C	125-330-04	
7	SOUTHWESTERLY	215' ±	22	S 22°52'26"E	77.53'	D	125-330-19	
8	NORTHWESTERLY	128.20'	23	S 3°58'17"W	200.38'	E	125-330-15	
9	"	55.91'	24	S 22°11'53"W	195.39'	F	125-330-16	
10	"	66.82'	25	S 70°41'54"E	409.43'	G	125-330-08	
11	SOUTHWESTERLY	344.72'	26	N 13°25'07"E	150.57'			
12	NORTHEASTERLY	143.75'	27	N 43°58'56"E	403.52'			
13	"	211.16'	28	S 38°31'49"E	564.55'			
14	SOUTHWESTERLY	569.47'	29	S 10°08'27"E	329.26'			
15	"	360'	30	S 76°55'32"E	630.01'			

AREA = 98ac ±

19-84

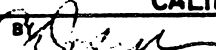
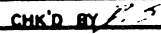
NOVATO SANITARY DISTRICT		
SANITARY DISTRICT NO. 6		
MARIN COUNTY CALIFORNIA		
SCALE: 1" = 1200'	APPROVED BY 	DRAWN BY RB
DATE: 8-16-84	Manager-Engineer	CHK'D BY 
VINEYARD RD ANNEX 1984-6		
REV. 7-9-85 DELETE OPEN SPACE PCL.		DRAWING NO.

A5038245