

LOCAL AGENCY FORMATION COMMISSION OF MARIN COUNTY

RESOLUTION NO. 76-13

RESOLUTIONS MAKING DETERMINATIONS AND APPROVING THE ANNEXATION OF
TERRITORY DESIGNATED AS BEL MARIN KEYS ANNEXATION (1975-4)
TO SANITARY DISTRICT NO. 6

WHEREAS, a proposal for the annexation of certain territory to Sanitary District No. 6 in the County of Marin, has been filed with the Executive Officer of this Commission; and

WHEREAS, said proposal was made in the form of Resolution No. 1551, a resolution of application adopted by the Board of Directors of Sanitary District No. 6, and requesting the initiation of annexation proceedings pursuant to the District Reorganization Act of 1965, Division 1 (commencing with Section 56000) of Title 6 of the Government Code; and

WHEREAS, said resolution of application was accompanied by written consent signed by all owners of land within the territory proposed to be annexed; and

WHEREAS, pursuant to Government Code Section 56261, when a resolution of application is accompanied by written consent of all owners of land within the territory proposed to be annexed, this Commission may make determinations with respect to said application without notice or hearing,

NOW, THEREFORE, the Local Agency Formation Commission of the County of Marin, DOES HEREBY RESOLVE, DETERMINE AND ORDER as follows:

1. Subject to the terms and conditions hereinafter specified, the proposal made by Resolution No. 1551, adopted by the Board of Directors of Sanitary District No. 6 is approved.
2. The boundaries of the territory proposed to be annexed shall be those set forth in Exhibit A attached hereto and incorporated herein; and said territory shall be designated as "Bel Marin Keys Blvd. Annexation (1975-4)"; and is found to be uninhabited.
3. Any resolution ordering the annexation approved by this resolution shall provide that such annexation is ordered subject to the terms and conditions specified in the resolution of application.

4. Sanitary District No. 6 is designated as the conducting district for further proceedings; and the Board of Directors of said district is hereby directed to initiate proceedings in compliance with this resolution, and is authorized to proceed without notice or hearing pursuant to Government Code Section 56261.

5. The environmental documents relevant to the proposed annexation have been reviewed and considered by the Commission in making its final determination.

6. The Executive Officer is hereby authorized to mail certified copies of this resolution in the manner and as described in Section 56272 of the Government Code.

PASSED AND ADOPTED by the Marin Local Agency Formation Commission on this 17th day of March, 1976, by the following vote:

AYES: Commissioners Baptiste, Giacomini, Mulryan, Violich and Jones

NOES: None

ABSENT: None

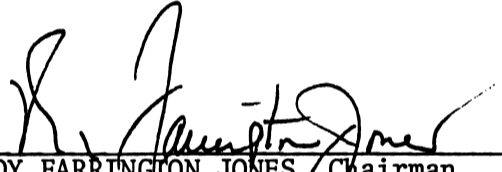

ROY FARRINGTON JONES, Chairman
Local Agency Formation Commission
of the County of Marin

ATTEST:



LARI I. SHEEHAN, Executive Officer

SANITARY DISTRICT NO. 6 OF MARIN COUNTY
BEL MARIN KEYS BOULEVARD ANNEXATION 1975-4
EXHIBIT "A"

Beginning at a point on the existing boundary of Sanitary District No. 6 of Marin County, said point being the southeasterly corner of Lot 45 of Ignacio Industrial Park Unit 2 as recorded in Book 16 of Maps at page 45, Marin County Records; thence along the easterly line of said Lot 45 along a curve concave to the east having a radius of 900 feet, an arc distance of 33 feet more or less to the point of intersection with existing boundary of Sanitary District No. 6; thence southwesterly and northeasterly along said existing Sanitary District No. 6 boundary to the point of beginning.

generally practices no. 5 provided to the Board of directors
consequently and consequently should also exist
existing property of generally practices no. 5. Hence
that none of these to the Board of directors with
each having a value of 300 feet in the distance of 33
generally practice no. 5 and a value of 300 feet to the
at 300 feet. Many county records hence should the
indicated that this is recorded in book 12 of maps
return the consequently corner of lot 42 of 10000
generally practices no. 5 of many county, and hence
returned at a Board on the existing property of

EXHIBIT "A"

SEE MAPS AND RECORDS OF THE COUNTY OF ...

GENERALLY PRACTICES NO. 5 OF MANY COUNTY

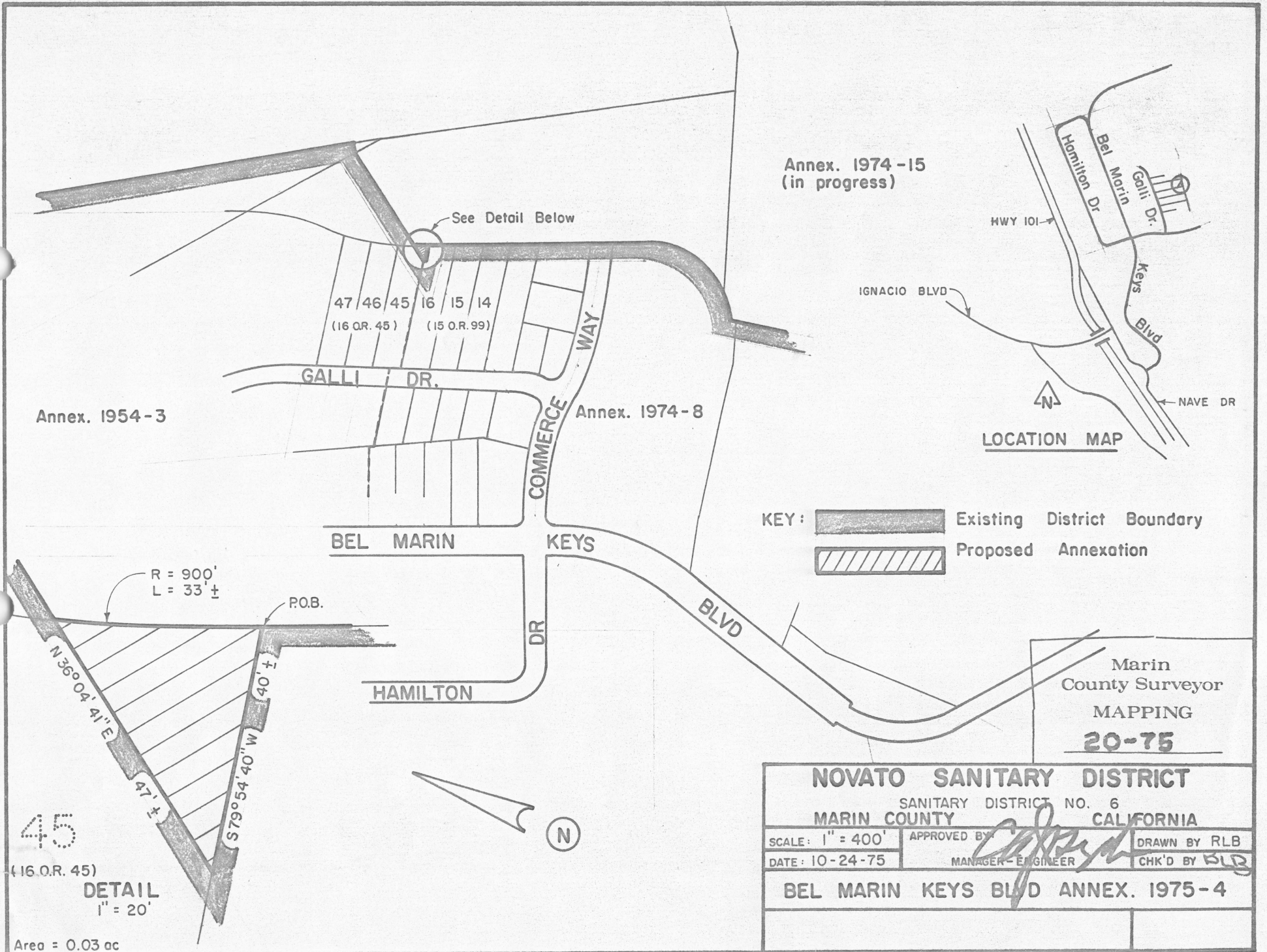



Annex. 1954-3

Annex. 1974-15
(in progress)

Annex. 1974-8

LOCATION MAP

KEY:  Existing District Boundary
 Proposed Annexation

Marin County Surveyor
MAPPING
20-75

NOVATO SANITARY DISTRICT			
SANITARY DISTRICT NO. 6			
MARIN COUNTY		CALIFORNIA	
SCALE: 1" = 400'	APPROVED BY	<i>[Signature]</i>	
DATE: 10-24-75	MANAGER-ENGINEER		
BEL MARIN KEYS BLVD ANNEX. 1975-4			

45
(16 O.R. 45)
DETAIL
1" = 20'
Area = 0.03 ac