

LOCAL AGENCY FORMATION COMMISSION OF MARIN COUNTY

RESOLUTION NO. 84-1

RESOLUTION MAKING DETERMINATIONS AND APPROVING ANNEXATION
WITH WAIVER OF NOTICE, HEARING AND ELECTION
TO THE NOVATO SANITARY DISTRICT

EUCALYPTUS AVENUE ANNEXATION 1983-7

WHEREAS, a proposal for the annexation of certain territory to the Novato Sanitary District in the County of Marin has been filed with the Executive Officer of this Commission; and

WHEREAS, said proposal was made in the form of Resolution 2042, a resolution of application adopted by the Board of Directors of the Novato Sanitary District, requesting the initiation of annexation proceedings pursuant to the District Reorganization Act of 1965, Division 1 (commencing with Section 56000) of Title 6 of the Government Code; and

WHEREAS, said resolution of application was accompanied by written consent signed by all owners of land within the territory proposed to be annexed; and

WHEREAS, pursuant to Government Code Section 56261, when a resolution of application is accompanied by written consent of all owners of land within the territory proposed to be annexed, this Commission may make determinations with respect to said annexation without notice and hearing.

NOW, THEREFORE, the Local Agency Formation Commission of the County of Marin DOES HEREBY RESOLVE, DETERMINE AND ORDER as follows:

Section 1. Subject to the terms and conditions hereinafter specified, the proposal made by Resolution No. 2042, adopted by the Board of Directors of the Novato Sanitary District, is approved.

Section 2. The boundaries of the territory proposed to be annexed shall be those set forth in Exhibit A, attached hereto and incorporated herein; and said territory shall be designated as the "Eucalyptus Avenue Annexation 1983-7."

Section 3. Said territory is found to be uninhabited.

Section 4. Any resolution ordering the annexation approved by this resolution shall provide that such annexation is ordered subject to Novato Sanitary District's terms and conditions as set forth in Exhibit B, attached hereto and incorporated herein.

Section 5. The Novato Sanitary District is designated as the conducting district for further proceedings, and the Board of Directors of said

District is hereby directed to initiate proceedings in compliance with this resolution and is authorized to proceed without notice, or election, pursuant to Government Code Section 56261.

Section 6. The project is categorically exempt pursuant to provisions of the California Environmental Quality Act and the Commission's Environmental Guidelines.

Section 7. The Executive Officer is hereby authorized and directed to mail certified copies of the resolution in the manner prescribed by Section 56272 of the Government Code.

PASSED AND ADOPTED by the Marin County Local Agency Formation Commission on this 12th day of January 1984 by the following vote:

AYES: Commissioners Breiner, Giacomini, McCart, Stockwell, and Boessenecker

NOES: None

ABSENT: None

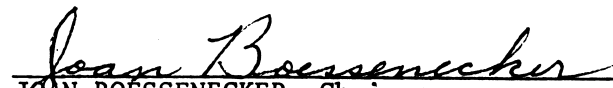
JOAN BOESSENECKER, Chairman
Marin Local Agency Formation Commission

ATTEST:

WARREN K. NELSON, Executive Officer

DATE: January 12, 1984

November 21, 1983

NOVATO SANITARY DISTRICT
EUCALYPTUS AVENUE ANNEX 1983-7



Exhibit "A"

Beginning at a point on the existing boundary of Novato Sanitary District, said point being on the westerly line of Eucalyptus Avenue distant thereon South $10^{\circ} 22'$ West 487.47 feet from its intersection with the southerly line of Center Road as said Avenue and Road is shown upon that certain map entitled, "Amended Map No. 1 of Subdivision 'E' of the Novato Ranch, Marin County, Cal.", filed July 6, 1910 in Book 3 of Maps at Page 54, Marin County Records; thence leaving said westerly line of Eucalyptus Avenue and running along said Sanitary District boundary, crossing said Eucalyptus Avenue Southeasterly 30 feet to a point on the easterly line of said Eucalyptus Avenue; thence leaving said easterly line of Eucalyptus Avenue and continuing along said Sanitary District boundary Southeasterly 173.74 feet; thence Southwesterly 60 feet; thence leaving said Sanitary District boundary North $78^{\circ} 28'$ West 175.611 feet to a point on said easterly line of Eucalyptus Avenue; thence leaving said easterly line of Eucalyptus Avenue North $79^{\circ} 40'$ West 30 feet to a point on said westerly line of Eucalyptus Avenue and on said Sanitary District boundary; running thence along said westerly line of Eucalyptus Avenue and along said Sanitary District boundary Northeasterly to the point of beginning.

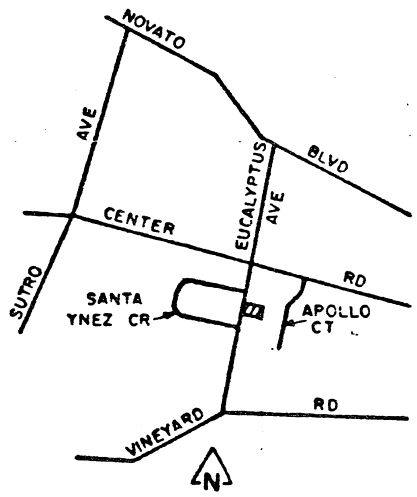
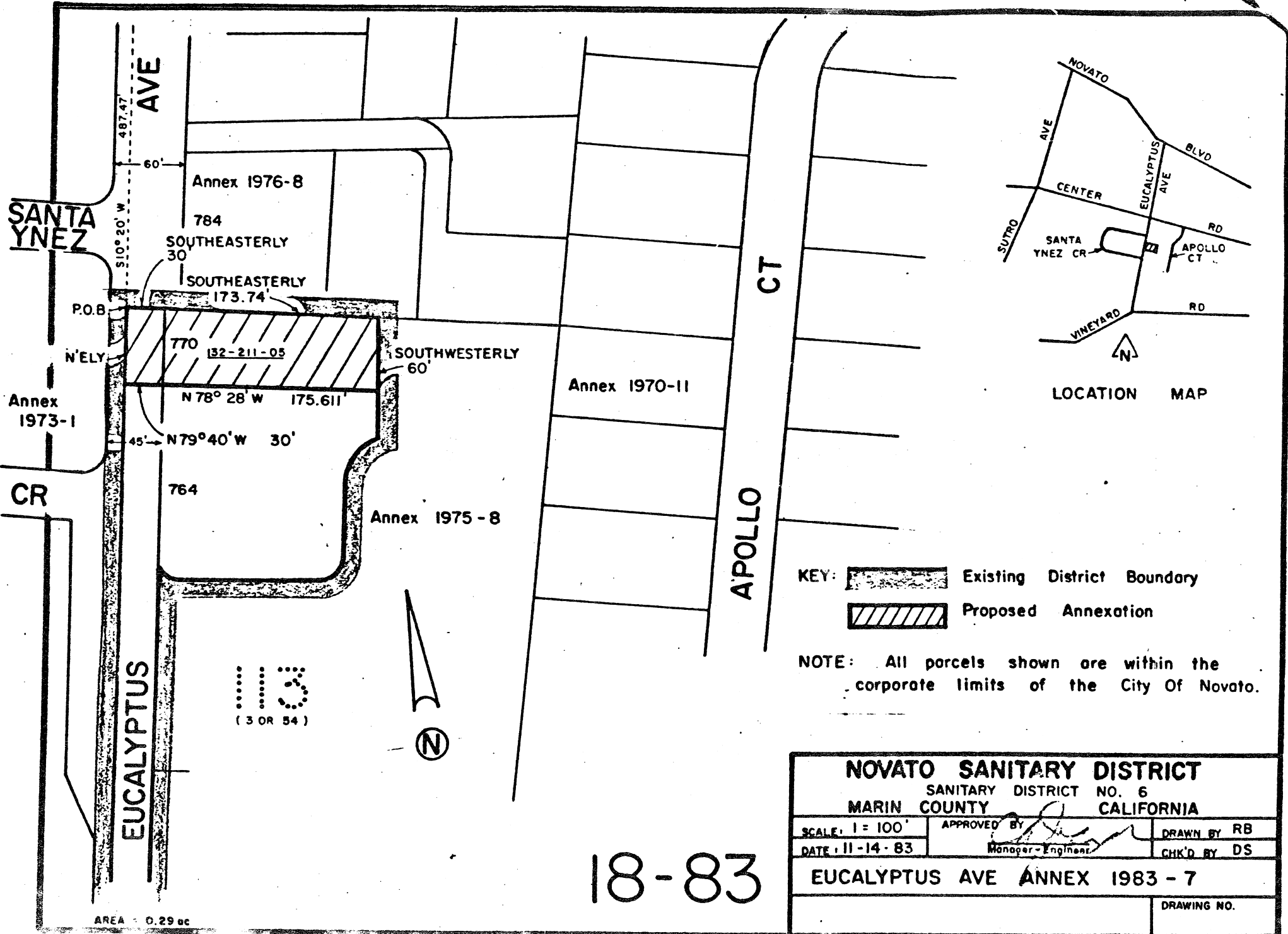
Containing 0.29 acres, more or less.



LOCATION MAP

- KEY:
-  Existing District Boundary
 -  Proposed Annexation

NOTE: All parcels shown are within the corporate limits of the City Of Novato.

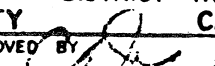
NOVATO SANITARY DISTRICT		
SANITARY DISTRICT NO. 6		
MARIN COUNTY		CALIFORNIA
SCALE: 1 = 100'	APPROVED BY 	DRAWN BY RB
DATE: 11-14-83	Manager-Engineer	CHK'D BY DS
EUCALYPTUS AVE ANNEX 1983 - 7		
		DRAWING NO.

18-83

AREA - 0.29 ac

4011335