

LOCAL AGENCY FORMATION COMMISSION OF MARIN COUNTY

RESOLUTION NO. 76-40

RESOLUTION MAKING DETERMINATIONS AND APPROVING THE ANNEXATION OF
TERRITORY DESIGNATED AS "McCLAY ROAD ANNEXATION (1976-4)"
TO SANITARY DISTRICT NO. 6

WHEREAS, a proposal for the annexation of certain territory to Sanitary District No. 6 in the County of Marin, has been filed with the Executive Officer of this Commission; and

WHEREAS, said proposal was made in the form of Resolution No. 1576 a resolution of application adopted by the Board of Directors of Sanitary District No. 6, and requesting the initiation of annexation proceedings pursuant to the District Reorganization Act of 1965, Division 1 (commencing with Section 56000) of Title 6 of the Government Code; and

WHEREAS, said resolution of application was accompanied by written consent signed by all owners of land within the territory proposed to be annexed; and

WHEREAS, pursuant to Government Code Section 56261, when a resolution of application is accompanied by written consent of all owners of land within the territory proposed to be annexed, this Commission may make determinations with respect to said application without notice and hearing,

NOW THEREFORE, the Local Agency Formation Commission of the County of Marin, DOES HEREBY RESOLVE, DETERMINE AND ORDER as follows:

1. Subject to the terms and conditions hereinafter specified, the proposal made by Resolution No. 1576 adopted by the Board of Directors of Sanitary District No. 6 is approved.
2. The boundaries of the territory proposed to be annexed shall be those set forth in Exhibit A attached hereto and incorporated herein; and said territory shall be designated as "McClay Road Annexation (1976-4)", and is found to be uninhabited.
3. Any resolution ordering the annexation approved by this resolution shall provide that such annexation is ordered subject to the terms and conditions specified in the resolution of application.
4. Sanitary District No. 6 is designated as the conducting district for further proceedings; and the Board of Directors of said district is hereby directed to initiate proceedings in compliance with this resolution, and is authorized to proceed without notice or hearing pursuant to Government Code Section 56261.

5. The environmental documents relevant to the proposal have been reviewed and considered by the Commission in making its final determination.

6. The Executive Officer is hereby authorized to mail certified copies of this resolution in the manner as prescribed by law.

PASSED AND ADOPTED by the Marin Local Agency Formation Commission on this 20th day of October, 1976, by the following vote:

AYES: Commissioners Arrigoni, Mulryan, Violich and Jones

NOES: None

ABSENT: Commissioner Giacomini

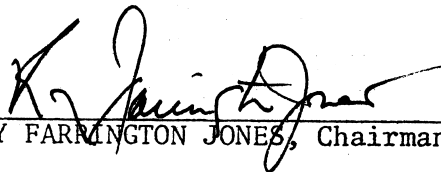

ROY FARRINGTON JONES, Chairman

ATTEST:

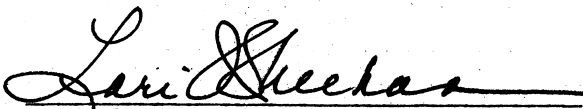

LARI I. SHEEHAN, Executive Officer

SANITARY DISTRICT NO. 6 OF MARIN COUNTY

McCLAY ROAD ANNEXATION 1976-4

EXHIBIT "A"

Beginning at a point on the existing boundary of Sanitary District No. 6 of Marin County, California, said point being on the northwesterly line of McClay Road (Maclay Avenue), distant thereon South 29° 15' West 66 feet from its intersection with the northeasterly line of Lot 82, as said Lot and Road are shown upon that certain Map entitled "Map of Subdivisions 'A' and 'B' of the Novato Ranch, Marin County, California", filed November 18, 1909 in Book 3 of Maps at Page 36 Marin County Records; running thence along said northwesterly line of McClay Road and along said Sanitary District boundary South 29° 15' West 66 feet; thence leaving said northwesterly line and continuing along said Sanitary District boundary North 60° 45' West 315 feet to the northwesterly line of said Lot; thence running along said northwesterly Lot Line North 29° 15' East 66 feet; thence leaving said northwesterly Lot Line South 60° 45' East 315 feet to the point of beginning.

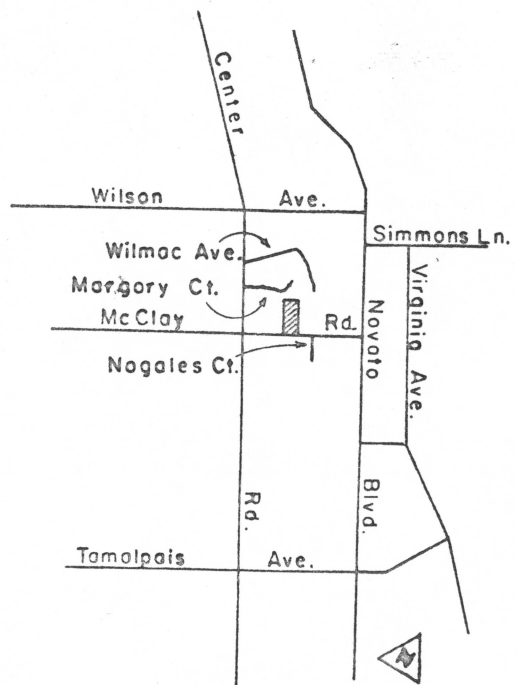
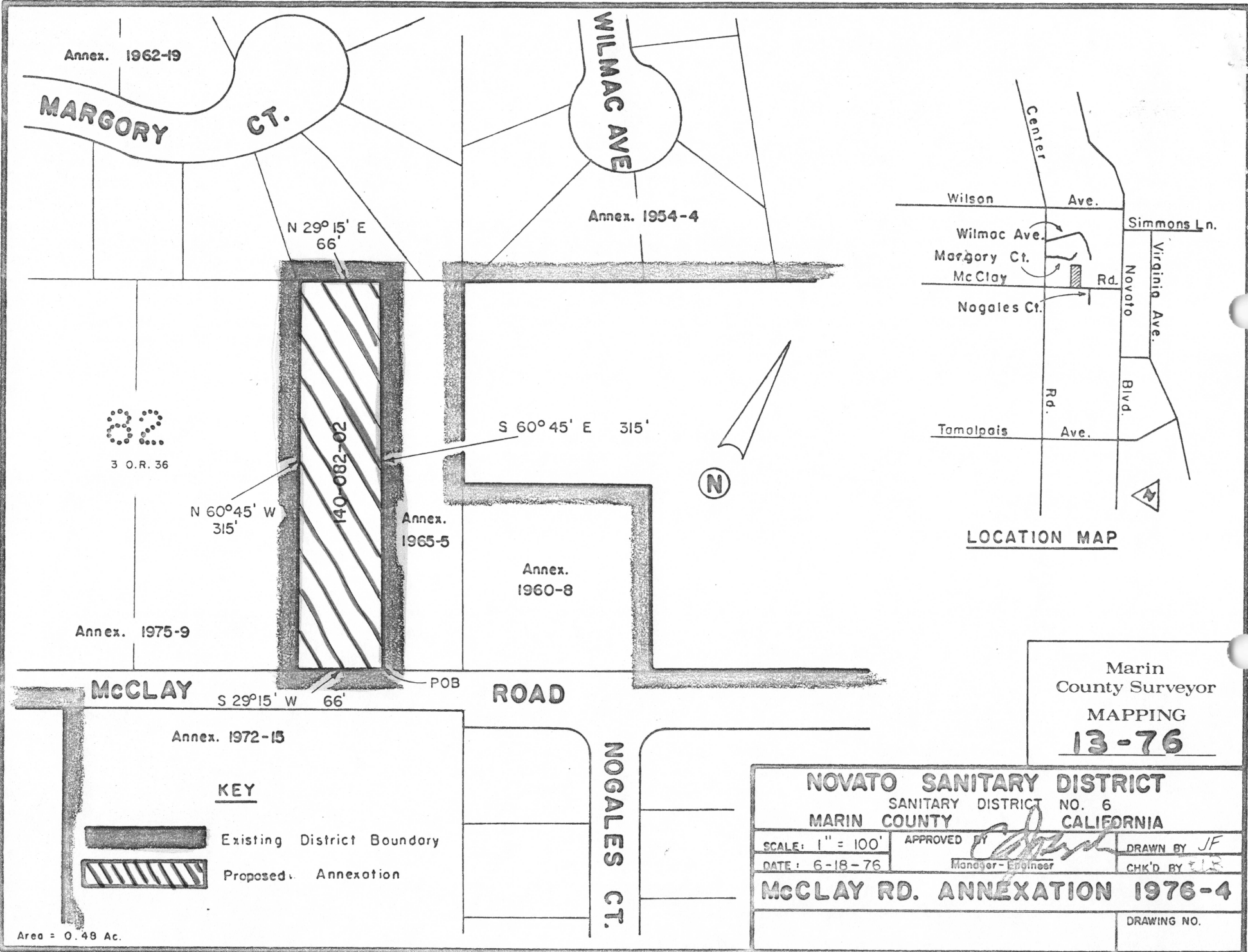

LOCATION MAP

Marin
County Surveyor
MAPPING
13-76

NOVATO SANITARY DISTRICT		
SANITARY DISTRICT NO. 6		
MARIN COUNTY		CALIFORNIA
SCALE: 1" = 100'	APPROVED BY <i>[Signature]</i>	DRAWN BY JF
DATE: 6-18-76	Manager-Engineer	CHK'D BY [Signature]
McCLAY RD. ANNEXATION 1976-4		
		DRAWING NO.