

LOCAL AGENCY FORMATION COMMISSION OF THE COUNTY OF MARIN

RESOLUTION NO. 72-56

RESOLUTION APPROVING THE ANNEXATION OF TERRITORY TO
SANITARY DISTRICT NO. 6

McCLAY ROAD ANNEXATION 1972-15

WHEREAS, a resolution of application No. 1341 has been filed by Sanitary District No. 6, together with evidence of written consent to all owners of property within the proposed annexation; and

WHEREAS, the Commission has found the territory to be annexed to be uninhabited; and

WHEREAS, the Sanitary District No. 6 has not requested the Commission to hold a noticed public hearing in accordance with Government Code Section 56261.

NOW, THEREFORE, BE IT RESOLVED by the Marin County Local Agency Formation Commission, in accordance with the District Reorganization Act of 1965, that it does hereby approve the annexation of territory known as McClary Road Annexation 1972-15 to the Sanitary District No. 6 with the following determination:

1. Sanitary District No. 6 shall be the conducting District for further proceedings to annex this territory and the Board of Directors of that District is directed to initiate annexation proceedings in compliance with this resolution and the resolution of application. Such proceedings may be without notice, without hearing, and without election.
2. The territory proposed for annexation shall be designated as McClay Road Annexation 1972-15.

PASSED AND ADOPTED by the Marin County Local Agency Formation Commission on this 13th day of December, 1972, by the following vote:

AYES: Commissioners Baptiste, Baar, Jones, Marchant

NOES: None

ABSENT: Commissioner Mulryan

ATTEST



Chairman of the Local Agency Formation
Commission of the County of Marin



Executive Officer

SANITARY DISTRICT NO. 6 OF MARIN COUNTY

McCLAY ROAD ANNEXATION 1972-15

EXHIBIT "A"

BEGINNING at a point on the existing boundary of Sanitary District No. 6 of Marin County, said point being on the southeasterly line of McClay Road at its intersection with the northeasterly line of Lot 83 as said Road and Lot are shown upon that certain map entitled "Map of Subdivision's A & B of the Novato Ranch, Marin County, California", filed November 18, 1909 in Book 3 of Maps at Page 36, Marin County Records; running thence from said point of beginning along said Sanitary District boundary and along the northeasterly line of Lots 83 and 84 south $60^{\circ} 45' 00''$ East 447.66 ft; thence leaving said Sanitary District boundary and said northeasterly line of Lots 83 and 84 south $24^{\circ} 36'$ West 323.59 ft; thence North $60^{\circ} 45'$ West 472.11 ft to a point on said southeasterly line of McClay Rd. and said Sanitary District boundary; thence along said Sanitary District boundary and along said southeasterly line of McClay Road North $29^{\circ} 15'$ East 322.5 ft. to the point of beginning.

McCLAY RD. Annex. 1960-8 RD. N 29°15' E 322.5' POB

CENTER RD.

83
(3 O.R. 36)

N 60°45' W
472.11

140-091-Q1

S60°45'00" E
447.66'

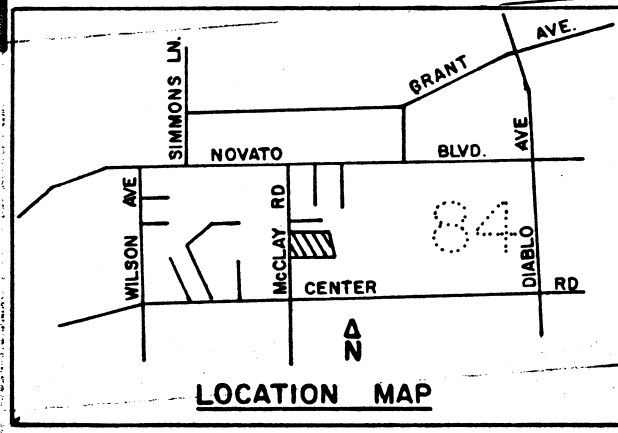

NOGALES CT.

Annex. 1963-4



S24°36' W 323.59'

N

KEY:  Existing District Boundary
 Proposed District Boundary

NOVATO SANITARY DISTRICT		
SANITARY DISTRICT NO. 6		
MARIN COUNTY CALIFORNIA		
SCALE: 1" = 100'	APPROVED BY: 	DRAWN BY: RLB
DATE: 11-3-72	Manager - Engineer	Chk'd. By: RLB
McCLAY RD. ANNEX. 1972-15		
		DRAWING NUMBER

TOTAL AREA = 3.4 ac.