

LOCAL AGENCY FORMATION COMMISSION OF THE COUNTY OF MARIN

RESOLUTION NO. 84-6

RESOLUTION MAKING DETERMINATIONS AND APPROVING ANNEXATION
TO THE NOVATO SANITARY DISTRICT

"SAN MARIN DRIVE ANNEXATION 1983-1"

WHEREAS, a proposal for the annexation of certain territories to the Novato Sanitary District in the County of Marin has been filed with the Executive Officer of this Commission; and

WHEREAS, said proposal was made in the form of Resolution No. 2005, a resolution of application adopted by the Board of Directors of the Novato Sanitary District; and

WHEREAS, at the time and in the form and manner prescribed by law, the Executive Officer has given notice of public hearing by this Commission upon said proposal: and

WHEREAS, the public hearing on said proposal was held by this Commission upon the date and at the time and place specified in said notice of public hearing, and all interested persons present were afforded an opportunity to speak and be heard on the matter.

NOW, THEREFORE, the Local Agency Formation Commission of the County of Marin DOES HEREBY RESOLVE, DETERMINE AND ORDER as follows:

Section 1. Subject to the terms and conditions hereinafter specified, the proposal made by Resolution No. 2005, adopted by the Board of Directors of the Novato Sanitary District, is approved.

Section 2. The boundaries of the territory proposed to be annexed shall be those set forth in Exhibit A, attached hereto and incorporated herein; and said territory shall be designated as the San Marin Drive Annexation 1983-1.

Section 3. Said territory is found to be uninhabited.

Section 4. Any resolution authorizing the annexation approved by this resolution shall impose the Novato Sanitary District's terms and conditions, as set forth in Exhibit B, attached hereto and incorporated herein.

Section 5. The Novato Sanitary District is designated as the conducting district for further proceedings, and the Board of Directors of said District is hereby directed to initiate proceedings in compliance with this resolution, and is authorized to take further proceedings upon said annexation in compliance with applicable provisions of State law.

Section 6. The environmental documents relevant to the proposed annexation as prepared by the City of Novato and Marin Local Agency Formation Commission have been reviewed and considered by the Commission in making its final determination. Pursuant to the California Environmental Quality Act and the Commission's Environmental Guidelines, a Negative Declaration has been issued.

Section 7. The Executive Officer is hereby authorized and directed to mail certified copies of the resolution in the manner prescribed by Section 56272 of the Government Code.

PASSED AND ADOPTED by the Marin County Local Agency Formation Commission on this 12th day of April 1984 by the following vote:

AYES: Commissioners Stockwell, Willmann, and Breiner

NOES: None

ABSENT: Commissioners Boessenecker, Giacomini and McCart

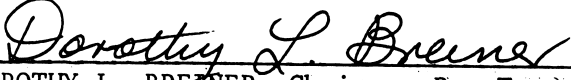

DOROTHY L. BREINER, Chairman Pro Tem
Marin Local Agency Formation Commission

ATTEST:

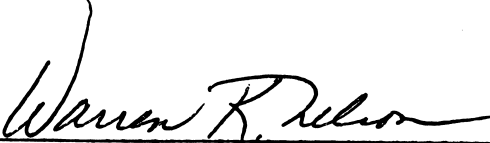

WARREN K. NELSON, Executive Officer

DATE: April 13, 1984

May 17, 1983

NOVATO SANITARY DISTRICT

San Marin Dr. Annex 1983-1

Exhibit "A"

Beginning at a point on the existing boundary of Novato Sanitary District, said point being the intersection of the southerly line of San Marin Dr. (formerly Maybee Road) with the easterly line of Seventh St. (formerly Hill Road), as said Dr. and St. are shown upon that certain map entitled "Subdivision Three, Sweetser Ranch, Novato, Calif.," filed November 14, 1913, in Liber 4 of Maps at Page 60, Marin County Records; and as said Drive is described in that certain corporation Grant Deed from Sunset International Petroleum Corporation to the City of Novato, filed July 9, 1965, in Book 1958 at Page 471, Marin County Records; running thence along said Sanitary District boundary and along said southerly line of San Marin Dr., Westerly to its intersection with the westerly line of Lot 87 as said Lot is shown upon that certain map hereinabove mentioned; thence leaving said southerly line of San Marin Dr. and continuing along said Sanitary District and along said westerly line of Lot 87 Southeasterly to the southwesterly corner of said Lot 87; thence leaving said Sanitary District boundary and running along the southerly line of said Lot North 85° 44' East 305 ft.; thence leaving said southerly line of Lot 87 South 3°18'11" West 248.26 ft.; thence South 56°18'11" East 428.13 ft.; thence North 33°41'49" East 90 ft. to a point on the westerly line of said Seventh St.; thence crossing said Seventh St. North 33°41'49" East 50 ft. to a point on the easterly line of said Seventh St, and to a point on said Sanitary District boundary; thence running along said easterly line northwesterly and northeasterly to the point of beginning.

Containing 13.98 acres, more or less.

EXHIBIT B

NOVATO SANITARY DISTRICT

The annexation shall be subject to the following terms and conditions:

1. In the event that pursuant to rules, regulations or ordinances of the District, as now or hereafter amended, the District shall require any payment of a fixed or determinable amount of money, either as a lump sum or in installments, for the acquisition, transfer, use or right of use of all or any part of the existing property, real or personal, of the District; such payment will be made to the District in the manner and at the time as provided by the rules, regulations or ordinances of the District, as now or hereafter amended.
2. Upon and after the effective date of said annexation, the territory, all inhabitants within such territory, and all persons entitled to vote by reason of residing or owning land within the territory, shall be subject to the jurisdiction of the District; shall have the same rights and duties as if the territory has been a part of the District upon its original formation; shall be liable for the payment of principal, interest, and any other amounts which shall become due on account of any outstanding or then authorized but thereafter issued bonds, including revenue bonds, or other contracts or obligations of the District; shall be subject to the levying or fixing and collection of any and all taxes, assessments, service charges, rentals or rates as may be necessary to provide for such payment; and shall be subject to all of the rates, rules, regulations and ordinances of the District, as now or hereafter amended.

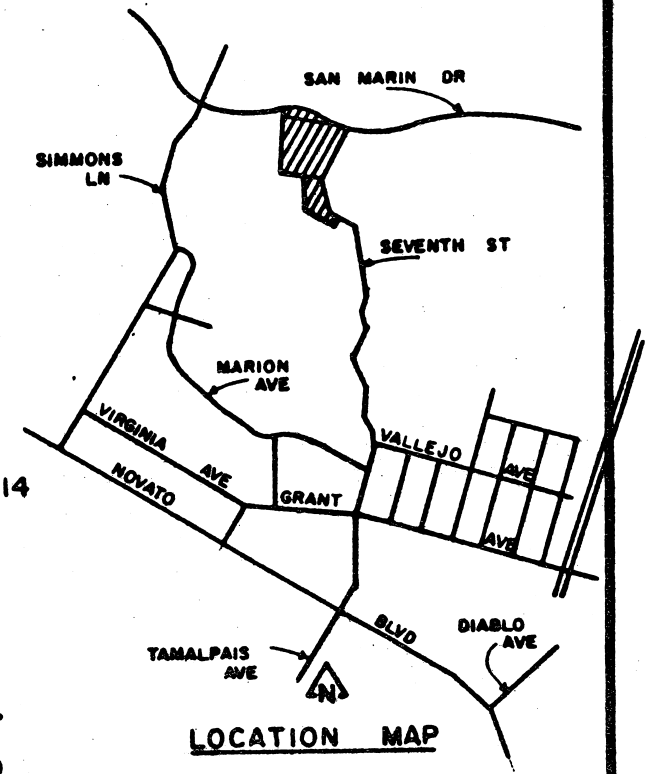
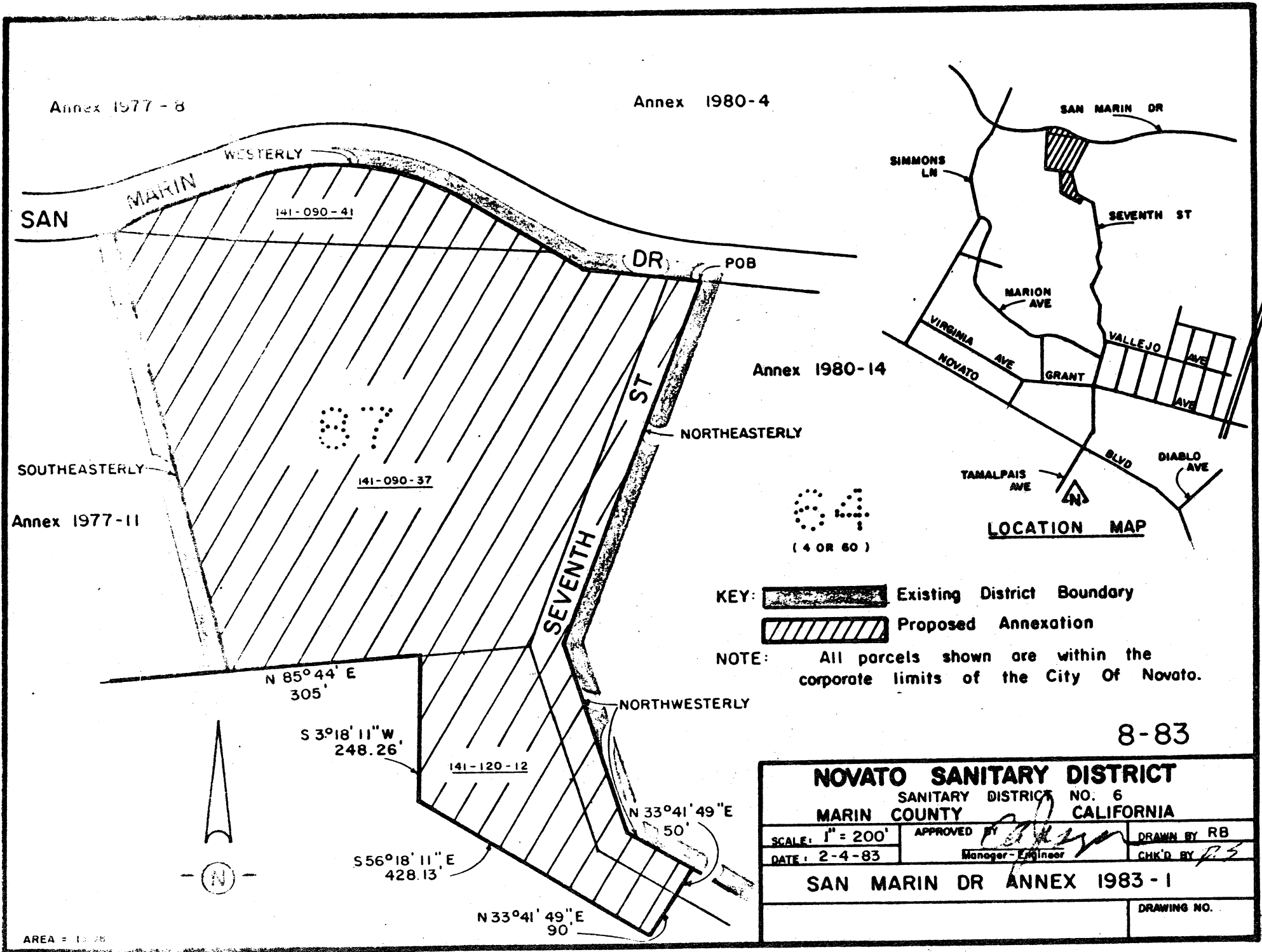

KEY: Existing District Boundary
 Proposed Annexation

NOTE: All parcels shown are within the corporate limits of the City Of Novato.

8-83

NOVATO SANITARY DISTRICT		
SANITARY DISTRICT NO. 6		
MARIN COUNTY CALIFORNIA		
SCALE: 1" = 200'	APPROVED BY	DRAWN BY RB
DATE: 2-4-83	Manager-Engineer	CHK'D BY
SAN MARIN DR ANNEX 1983-1		
		DRAWING NO.

AREA = 13.75

84041073