

LOCAL AGENCY FORMATION COMMISSION OF MARIN COUNTY

RESOLUTION NO. 82-13

RESOLUTION MAKING DETERMINATIONS AND APPROVING ANNEXATION
WITH WAIVER OF NOTICE, HEARING AND ELECTION
TO THE NOVATO SANITARY DISTRICT

TAMALPAIS AVENUE ANNEXATION 1982-1

WHEREAS, a proposal for the annexation of certain territory to the Novato Sanitary District in the County of Marin has been filed with the Executive Officer of this Commission; and

WHEREAS, said proposal was made in the form of Resolution No. 1916, a resolution of application adopted by the Board of Directors of the Novato Sanitary District, and requesting the initiation of annexation proceedings pursuant to the District Reorganization Act of 1965, Division 1 (commencing with Section 56000) of Title 6 of the Government Code; and

WHEREAS, said resolution of application was accompanied by written consent signed by all owners of land within the territory proposed to be annexed; and

WHEREAS, pursuant to Government Code Section 56261, when a resolution of application is accompanied by written consent of all owners of land within the territory proposed to be annexed, this Commission may make determinations with respect to said annexation without notice and hearing.

NOW, THEREFORE, the Local Agency Formation Commission of the County of Marin DOES HEREBY RESOLVE, DETERMINE AND ORDER as follows:

Section 1. Subject to the terms and conditions hereinafter specified, the proposal made by Resolution No. 1916, adopted by the Board of Directors of the Novato Sanitary District, is approved.

Section 2. The boundaries of the territory proposed to be annexed shall be those set forth in Exhibit A, attached hereto and incorporated herein; and said territory shall be designated as the Tamalpais Avenue Annexation 1982-1.

Section 3. Said territory is found to be uninhabited.

Section 4. Any resolution ordering the annexation approved by this resolution shall provide that such annexation is ordered subject to Novato Sanitary District's terms and conditions as set forth in Exhibit B, attached hereto and incorporated herein.

Section 5. The Novato Sanitary District is designated as the conducting district for further proceedings, and the Board of Directors of said District is hereby directed to initiate proceedings in compliance with this

resolution and is authorized to proceed without notice, or election, pursuant to Government Code Section 56261.

Section 6. The project is Categorical Exempt pursuant to provisions of the California Environmental Quality Act and the Commission's Environmental Guidelines.

Section 7. The Executive Officer is hereby authorized and directed to mail certified copies of the resolution in the manner prescribed by Section 56272 of the Government Code.

PASSED AND ADOPTED by the Marin County Local Agency Formation Commission on this 8th day of July 1982 by the following vote:

AYES: Commissioners Aramburu, Breiner, Giacomini, Jones and Boessenecker

NOES: None

ABSENT: Commissioners Boucke and Wilhelm

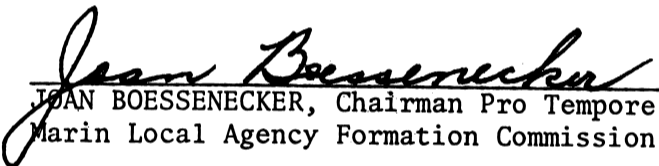
JOAN BOESSENECKER, Chairman Pro Tempore
Marin Local Agency Formation Commission

ATTEST:

WARREN K. NELSON, Executive Officer

DATE: July 9, 1982

3/17/82

NOVATO SANITARY DISTRICT
TAMALPAIS AVENUE ANNEX 1982-1
EXHIBIT "A"

A.P. #140-181-24

Beginning at a point on the existing boundary of Novato Sanitary District, said point being an easterly line of Tamalpais Ave. distant thereon South 29°15' West 200 ft. from its intersection with the southerly line of Center Rd. as said Ave. and Rd. are shown upon that certain map entitled "Map of Subdivisions 'A' and 'B' of the Novato Parcel, Marin County, Calif." filed November 18, 1909, in Volume 3 of Maps at Page 36, Marin County Records; running thence along said Sanitary District boundary and leaving said easterly line of Tamalpais Ave. Southeasterly 195 ft.; thence leaving said Sanitary District boundary South 29°15' West 125 ft.; thence North 60°45' West 195 ft. to a point on said easterly line of Tamalpais Ave. and on said Sanitary District boundary; running thence along said easterly line of Tamalpais Ave. and along said Sanitary District boundary Northeasterly 125 ft. to the point of beginning. Containing 0.56 Acres, more or less.

A.P. #140-181-70

Beginning at a point on the existing boundary of Novato Sanitary District, said point being on the easterly line of Tamalpais Ave. distant thereon North 29°15' East 100 ft. from its intersection with the southwesterly line of Lot 134 as said Ave. and Lot are shown upon that certain map entitled "Map of Subdivisions 'A' and 'B' of the Novato Ranch, Marin County, Calif." filed November 18, 1909, in Volume 3 of Maps at Page 36, Marin County Records; running thence along said Sanitary District boundary and continuing along said easterly line of Tamalpais Ave. Northeasterly 80 ft.; thence leaving said Sanitary District boundary and said easterly line of Tamalpais Ave. South 60°45' East 315 ft. to a point on said Sanitary District boundary and on the southeasterly line of said Lot 134; thence running along said Sanitary District boundary and along said southeasterly line of Lot 134 Southwesterly 80 ft.; thence leaving said Sanitary District boundary and said southeasterly line of Lot 134 North 60°45' West 315 ft. to the point of beginning.

Containing 0.58 Acres, more or less.

82035505

Annex 1953

CENTER RD

RD

1703
Annex 1955-2

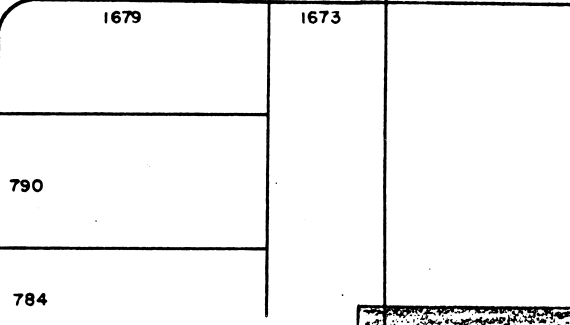

Annex 6-50

POB

Southeasterly 195'

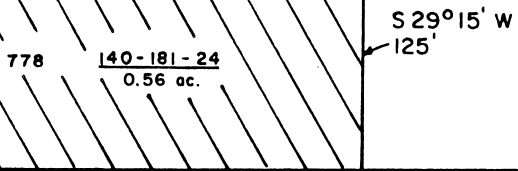

VICTOR CT

Northeasterly 125'

AVE

45'

Northeasterly 80'

MADLINE CT

3

POB

TAMALPAIS

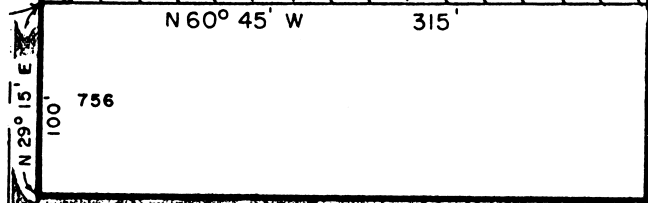



Southwesterly 80'

Annex 1974-10

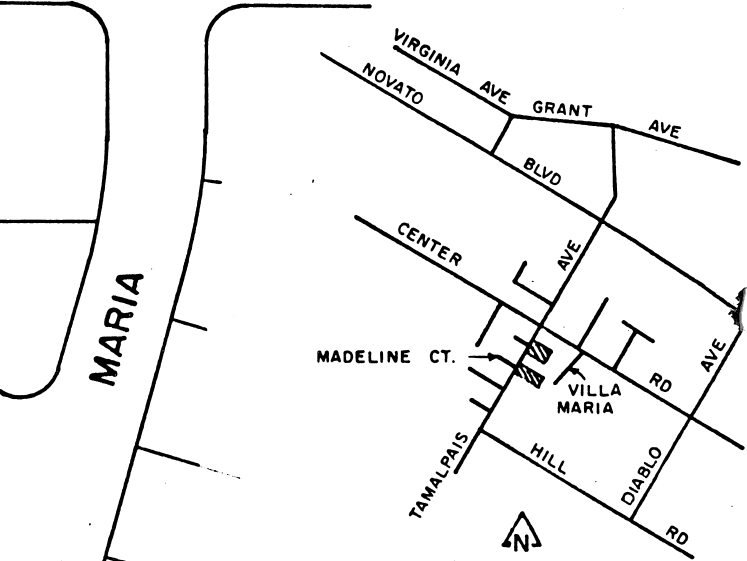
Area = 1.14 ac

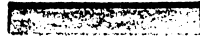

LOCATION MAP

KEY:  Existing District Boundary
 Proposed Annexation

NOTE: All parcels shown are within the corporate limit of the City of Novato

1-82

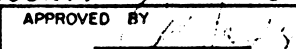
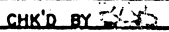
| | | |
|-----------------------------------|--|--|
| NOVATO SANITARY DISTRICT | | |
| SANITARY DISTRICT NO. 6 | | |
| MARIN COUNTY | | CALIFORNIA |
| SCALE: 1" = 100' | APPROVED BY  | DRAWN BY RB |
| DATE: 3-18-82 | Manager-Engineer | CHK'D BY  |
| TAMALPAIS AVE ANNEX 1982-1 | | |
| | | DRAWING NO. |