

LOCAL AGENCY FORMATION COMMISSION OF MARIN COUNTY

RESOLUTION NO. 74-43

RESOLUTION MAKING DETERMINATIONS AND APPROVING THE ANNEXATION OF  
TERRITORY DESIGNATED AS HAMILTON AIR FORCE BASE ANNEXATION (29-74)  
TO THE CITY OF NOVATO

WHEREAS, a proposal for the annexation of certain territory to the City of Novato, County of Marin, has been filed with the Executive Officer of this Commission; and

WHEREAS, said proposal was made in the form of an application made and submitted by the City of Novato in accordance with the provisions of the Knox-Nisbet Act, Chapter 6.6 (commencing with Section 54773), of Division 2, Title 5 of the Government Code; and

WHEREAS, at the time and in the form and manner prescribed by law, the Executive Officer has given notice of a public hearing by this Commission on said proposal; and

WHEREAS, the public hearing by this Commission was held upon the date and at the time specified in said notice of public hearing.

NOW, THEREFORE, the Local Agency Formation Commission of the County of Marin DOES HEREBY RESOLVE, DETERMINE AND ORDER as follows:

1. Subject to the terms and conditions hereinafter specified, the proposal made by application submitted by the City of Novato is approved.
2. The territory proposed for annexation is designated as the Hamilton Air Force Base Annexation (29-74) and is found to be uninhabited.
3. The boundaries of the territory proposed to be annexed shall be those set forth in the proposal filed with this Commission.
4. The annexation is, and shall, not be subject to any terms or conditions.
5. The City of Novato shall be the conducting agency for further proceedings to annex this territory; and the City Council of Novato is hereby authorized to take further proceedings upon said annexation in compliance with this resolution, the proposal application, and, applicable provisions of State law.

PASSED AND ADOPTED by the Marin County Local Agency Formation Commission on this 16th day of October, 1974, by the following vote:

AYES: Commissioners Baptiste, Giacomini, Jones, Mulryan and Marchant  
NOES: None  
ABSENT: None

  
\_\_\_\_\_  
Hugh G. Marchant, Chairman, Local Agency  
Formation Commission of the County of Marin

ATTEST:

  
\_\_\_\_\_  
Lari Sheehan, Executive Officer

Exhibit A

Legal Description

Hamilton Air Force Base Annexation No. 1

That certain property situate in the County of Marin, State of California, described as follows:

Beginning at the Southeast corner of that certain parcel of land known as "Hamilton Field, California" officially surveyed and recorded on October 13, 1933 in Book 2, Licensed Surveys at Page 77, official records of Marin County, California, said corner being on the Eastwest centerline of Sections 2 and 3, Township 2 North, Range 6 West, Mount Diablo Base and Meridian, said point being on the Northerly boundary of the property of the Roman Catholic Archbishop of San Francisco as per Quit Claim Deed recorded September 28, 1937, in Book 349 of Official Records at Page 109, Marin County Records, California; thence East 1,000 feet to a point in San Pablo Bay; thence North  $17^{\circ}42'05''$  East 7,678.16 feet to a point in San Pablo Bay; thence North  $74^{\circ}50'00''$  West 4,057.00 feet; thence South  $18^{\circ}49'00''$  West 1,650.00 feet; thence South  $15^{\circ}09'00''$  West 2,100.00 feet to a point on the Corporate City Limit Line; thence along said Corporate Limit Line South  $73^{\circ}43'00''$  East 1,255.00 feet; thence North  $19^{\circ}08'00''$  East 93.84 feet; thence East 509.61 feet; thence North 527.00 feet; thence East 286.60 feet; thence North  $60^{\circ}00'00''$  East 1,951.68 feet; thence South  $19^{\circ}49'04''$  West 2,236.71 feet; thence North  $73^{\circ}43'00''$  West 205.00 feet; thence South  $40^{\circ}00'00''$  West 158.00 feet; thence South  $25^{\circ}30'00''$  West 310.00 feet; thence South  $08^{\circ}30'00''$  West 990.00 feet; thence South  $18^{\circ}20'00''$  West 1,276.49 feet; thence South  $24^{\circ}00'00''$  West 376.20 feet; thence South  $15^{\circ}00'00''$  West 765.60 feet; thence South  $05^{\circ}30'00''$  East 462.00 feet (306.63 feet on incorporation map) to the point of beginning.

Said parcel containing 404.31 acres more or less.

... ..

... ..

... ..

... ..

... ..



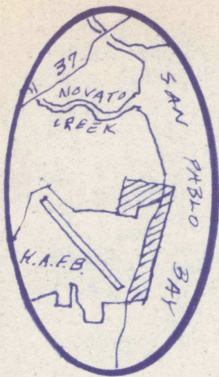

LOCATION MAP  
- NO SCALE

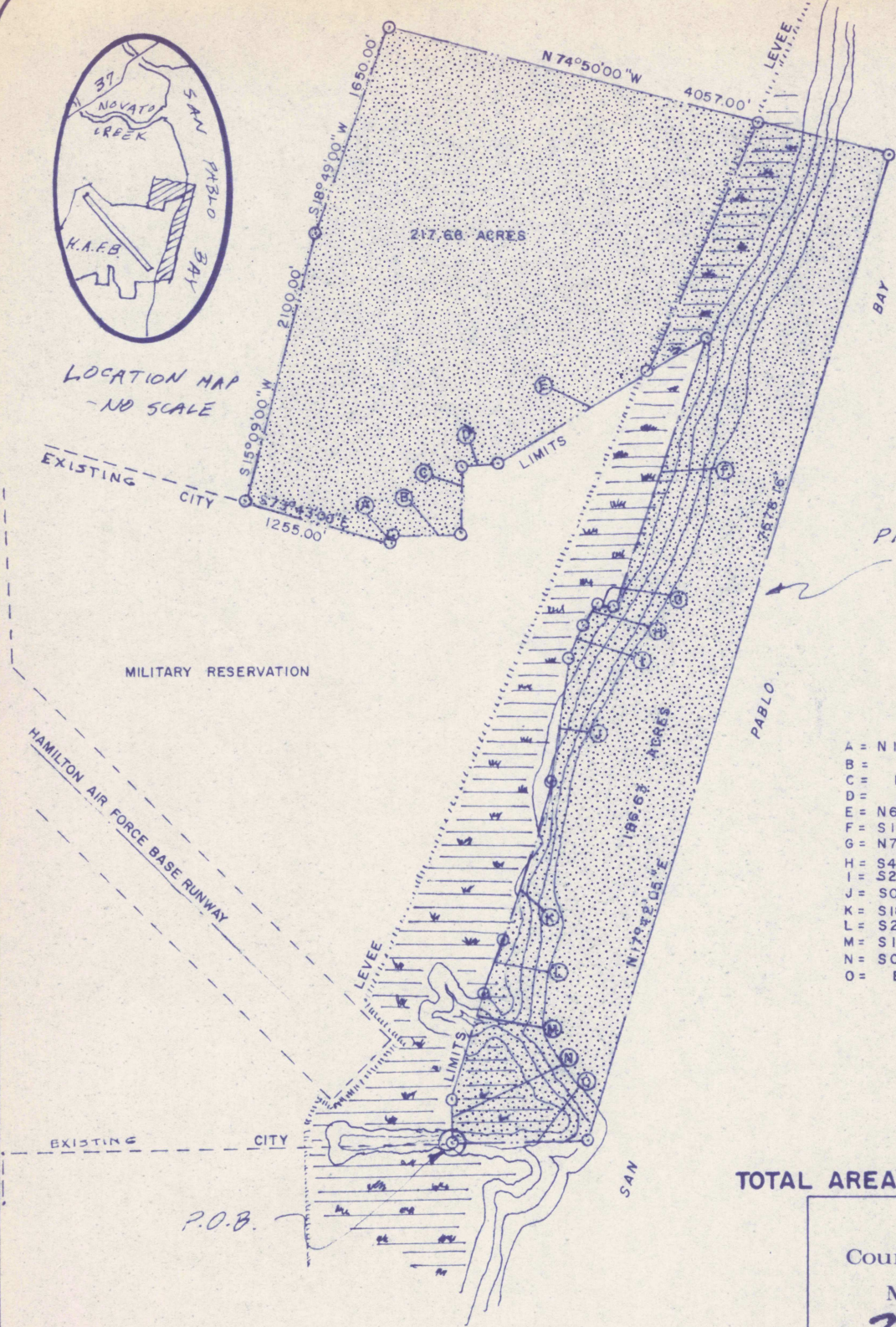
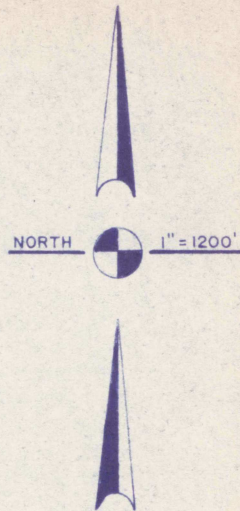

A =	N 19°08'00" E	93.84'
B =	EAST	509.61'
C =	NORTH	527.00'
D =	EAST	286.60'
E =	N 60°00'00" E	1951.68'
F =	S 19°49'04" W	2236.71'
G =	N 73°43'00" W	205.00'
H =	S 40°00'00" W	158.00'
I =	S 25°30'00" W	310.00'
J =	S 08°30'00" W	990.00'
K =	S 18°20'00" W	1276.49'
L =	S 24°00'00" W	376.20'
M =	S 15°00'00" W	765.60'
N =	S 05°30'00" E	462.00' (306.63')
O =	EAST	1000.00'

TOTAL AREA = 404.31 ACRES

Marin  
County Surveyor  
MAPPING  
**29-74**

NOVATO PLANNING DEPT. - CITY OF NOVATO - MARIN COUNTY, CALIF.

SCALE: 1" = 1200'  
DATE: DEC. 3, 1973  
DWG. NO. 77A

HAMILTON AIR FORCE  
BASE ANNEXATION # 1

DRAWN: J. PERRY  
CHECKED: D. WHITE  
APPROVED: *[Signature]*