

LOCAL AGENCY FORMATION COMMISSION OF THE COUNTY OF MARIN

RESOLUTION NO. 69-41

RESOLUTION APPROVING THE ANNEXATION OF TERRITORY TO  
SANITARY DISTRICT NO. 6

MC CLAY ROAD ANNEXATION 1969-14

WHEREAS, a resolution of application No. 1109 has been filed by Sanitary District No. 6, together with evidence of written consent of all owners of property within the proposed annexation; and

WHEREAS, the Commission has found the territory to be annexed to be uninhabited; and

WHEREAS, the Sanitary District No. 6 has not requested the Commission to hold a noticed public hearing in accordance with Government Code Section 56261.

NOW, THEREFORE, BE IT RESOLVED by the Marin County Local Agency Formation Commission, in accordance with the District Reorganization Act of 1965, that it does hereby approve the annexation of territory known as McClay Road Annexation 1969-14 to Sanitary District No. 6 with the following determinations:

1. Sanitary District No. 6 shall be the conducting District for further proceedings to annex this territory and the Board of Directors of that District is directed to initiate annexation proceedings in compliance with this resolution and the resolution of application. Such proceedings may be without notice, without hearing, and without election.

2. The territory proposed for annexation shall be designated as McClay Road Annexation 1969-14.

PASSED AND ADOPTED by the Marin County Local Agency Formation Commission on this 13th day of November, 1969 by the following vote:

AYES: Commissioners Arrigoni, Dyk, Wornum, Marchant

NOES: None

ABSENT: Commissioner Womack

  
Chairman of the Local Agency Formation  
Commission of the County of Marin

ATTEST:

  
Executive Officer

SANITARY DISTRICT NO. 6 OF MARIN COUNTY

McCLAY ROAD ANNEX 1969-14

EXHIBIT "A"

BEGINNING at a point on the existing boundary of Sanitary District No. 6 of Marin County, said point being distant North 29° 15' East 300 feet and North 60° 45' West 115 feet from the intersection of the Southerly line of Lot 162 with the Westerly line of McClay Road as said Lot and Road are shown upon that certain map entitled "Map of Subdivisions 'A' and 'B' of the Novato Ranch, Marin County, California", filed November 18, 1909 in Book 3 of Maps at Page 36, Marin County Records; running thence along said Sanitary District boundary North 29° 15' East 100 feet; thence leaving said Sanitary District boundary South 60° 45' East 115 feet to a point on said Westerly line of McClay Road; thence along said Westerly line of McClay Road South 29° 15' West 100 feet; thence leaving said Westerly line of McClay Road North 60° 45' West 115 feet to the point of beginning.

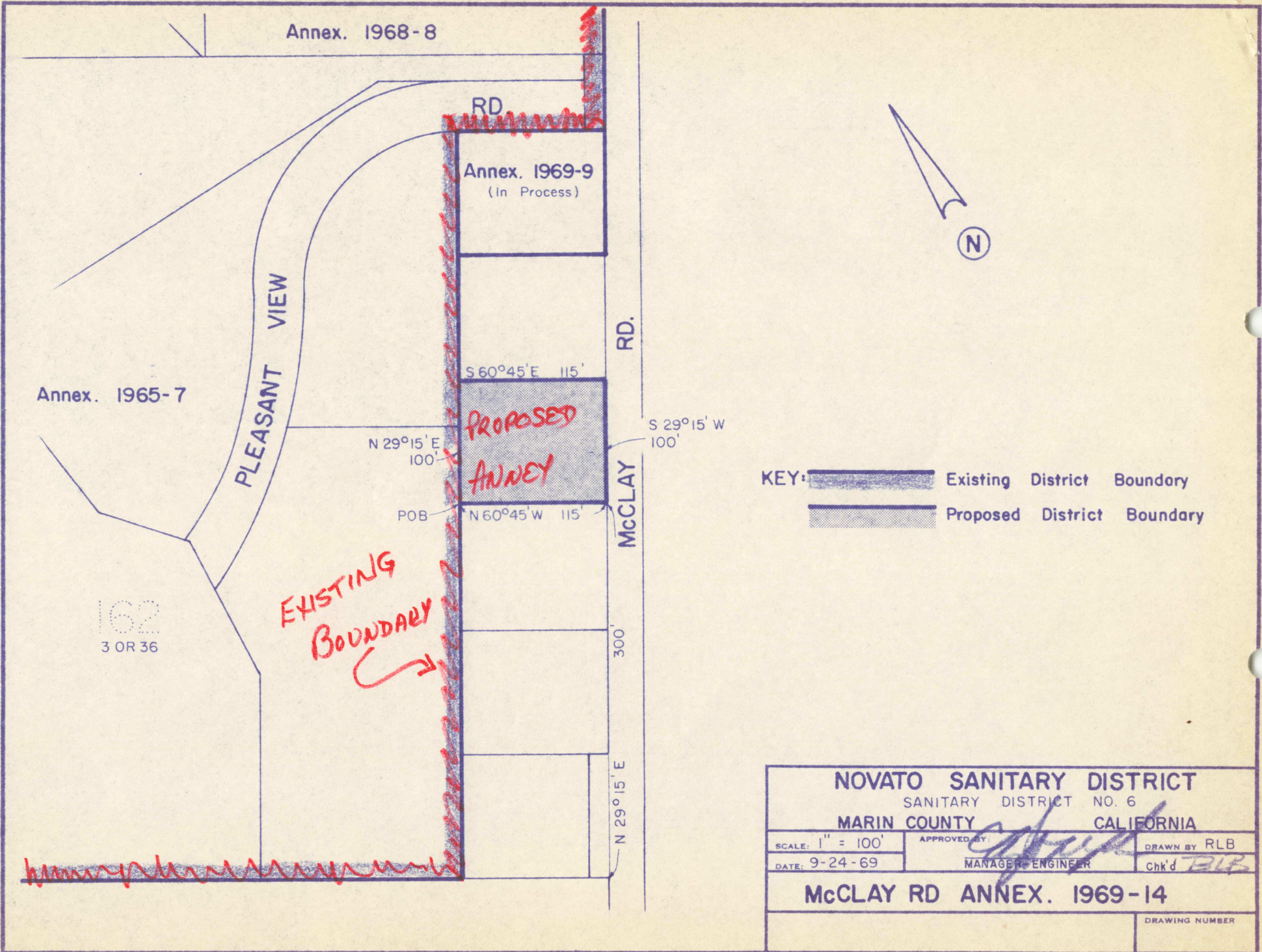

Annex. 1968-8

RD

Annex. 1969-9  
(In Process)

Annex. 1965-7

PLEASANT VIEW

S 60°45' E 115'

N 29°15' E 100'

PROPOSED ANNEX

S 29°15' W 100'

POB

N 60°45' W 115'

RD.

McCLAY



300'

N 29°15' E

162  
3 OR 36

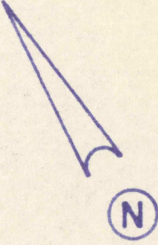
EXISTING BOUNDARY



KEY:  Existing District Boundary  
 Proposed District Boundary

**NOVATO SANITARY DISTRICT**

SANITARY DISTRICT NO. 6

MARIN COUNTY CALIFORNIA

SCALE: 1" = 100'	APPROVED BY: 	DRAWN BY RLB
DATE: 9-24-69	MANAGER-ENGINEER	Chk'd RLB

**McCLAY RD ANNEX. 1969-14**

DRAWING NUMBER