

LOCAL AGENCY FORMATION COMMISSION OF MARIN COUNTY

RESOLUTION NO. 76-45

RESOLUTION MAKING DETERMINATIONS AND APPROVING THE ANNEXATION OF
TERRITORY DESIGNATED AS "EUCALYPTUS AVENUE ANNEXATION (1976-8)"
TO SANITARY DISTRICT NO. 6

WHEREAS, a proposal for the annexation of certain territory to Sanitary District No. 6 in the County of Marin, has been filed with the Executive Officer of this Commission; and

WHEREAS, said proposal was made in the form of Resolution No. 1582 a resolution of application adopted by the Board of Directors of Sanitary District No. 6, and requesting the initiation of annexation proceedings pursuant to the District Reorganization Act of 1965, Division 1 (commencing with Section 56000) of Title 6 of the Government Code; and

WHEREAS, said resolution of application was accompanied by written consent signed by all owners of land within the territory proposed to be annexed; and

WHEREAS, pursuant to Government Code Section 56261, when a resolution of application is accompanied by written consent of all owners of land within the territory proposed to be annexed, this Commission may make determinations with respect to said application without notice and hearing,

NOW THEREFORE, the Local Agency Formation Commission of the County of Marin, DOES HEREBY RESOLVE, DETERMINE AND ORDER as follows:

1. Subject to the terms and conditions hereinafter specified, the proposal made by Resolution No. 1582 adopted by the Board of Directors of Sanitary District No. 6 is approved.
2. The boundaries of the territory proposed to be annexed shall be those set forth in Exhibit A attached hereto and incorporated herein; and said territory shall be designated as "Eucalyptus Avenue Annexation (1976-8)", and is found to be uninhabited.
3. Any resolution ordering the annexation approved by this resolution shall provide that such annexation is ordered subject to the terms and conditions specified in the resolution of application.
4. Sanitary District No. 6 is designated as the conducting district for further proceedings; and the Board of Directors of said district is hereby directed to initiate proceedings in compliance with this resolution, and is authorized to proceed without notice or hearing pursuant to Government Code Section 56261.

5. The environmental documents relevant to the proposed annexation have been reviewed and considered by the Commission in making its final determination.

6. The Executive Officer is hereby authorized to mail certified copies of this resolution in the manner as prescribed by law.

PASSED AND ADOPTED by the Marin Local Agency Formation Commission on this 20th day of October, 1976, by the following vote:

AYES: Commissioners Arrigoni, Mulryan, Violich and Jones

NOES: None

ABSENT: Commissioner Giacomini

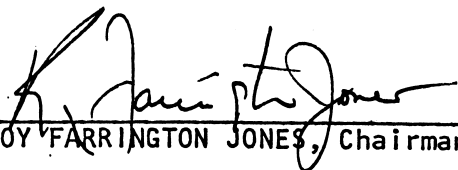

ROY FARRINGTON JONES, Chairman

ATTEST:



LARI J. SHEEHAN, Executive Officer

SANITARY DISTRICT NO. 6 OF MARIN COUNTY

EUCALYPTUS AVENUE ANNEXATION 1976-8

EXHIBIT "A"

Beginning at a point on the existing boundary of Sanitary District No. 6 of Marin County, said point being on the dividing line between Lot 114 and 113, distant thereon South 14° 15' West 298.90 feet from its intersection with the southerly line of Center Road as said Lots and Road are shown upon that certain map entitled "Amended Map No. 1 of Subdivision 'E' of the Novato Ranch, Marin County, California", filed July 6, 1910 in Book 3 of Maps at Page 54, Marin County Records; running thence along said Sanitary District boundary and along said dividing line South 14° 15' West 175.1 feet; thence leaving said dividing line and continuing along said Sanitary District boundary North 77° 38' West 146.33 feet; thence leaving said Sanitary District boundary North 77° 38' West 173.74 feet to a point on the easterly line of Eucalyptus Avenue (30R54); thence crossing said Avenue North 79° 38' West 30 feet to the westerly line of said Avenue and to a point on said Sanitary District boundary; running thence along said Sanitary District boundary and along said westerly line North 10° 22' East 153.39 feet; thence leaving said westerly line of Eucalyptus Avenue and continuing along said Sanitary District boundary South 79° 38' East 30 feet to said easterly line of Eucalyptus Avenue; thence South 81° 25' 30" East 332.65 feet to the point of beginning.

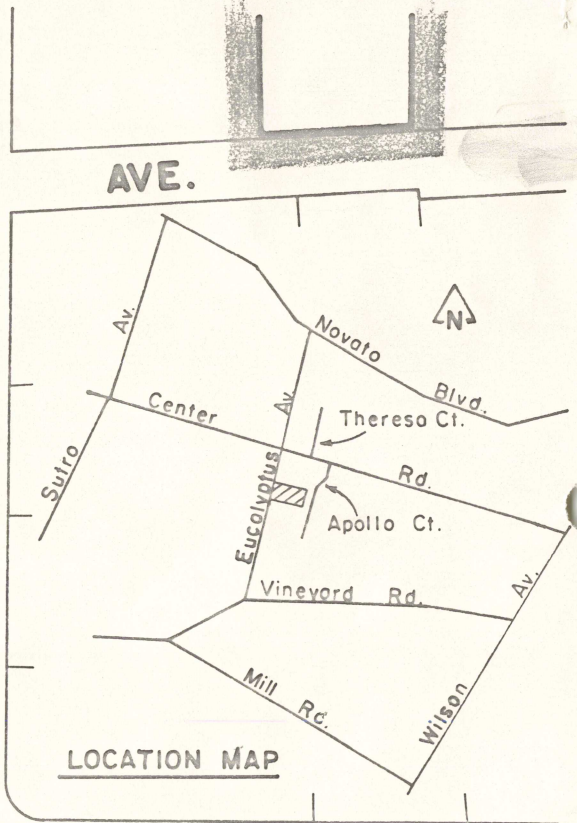
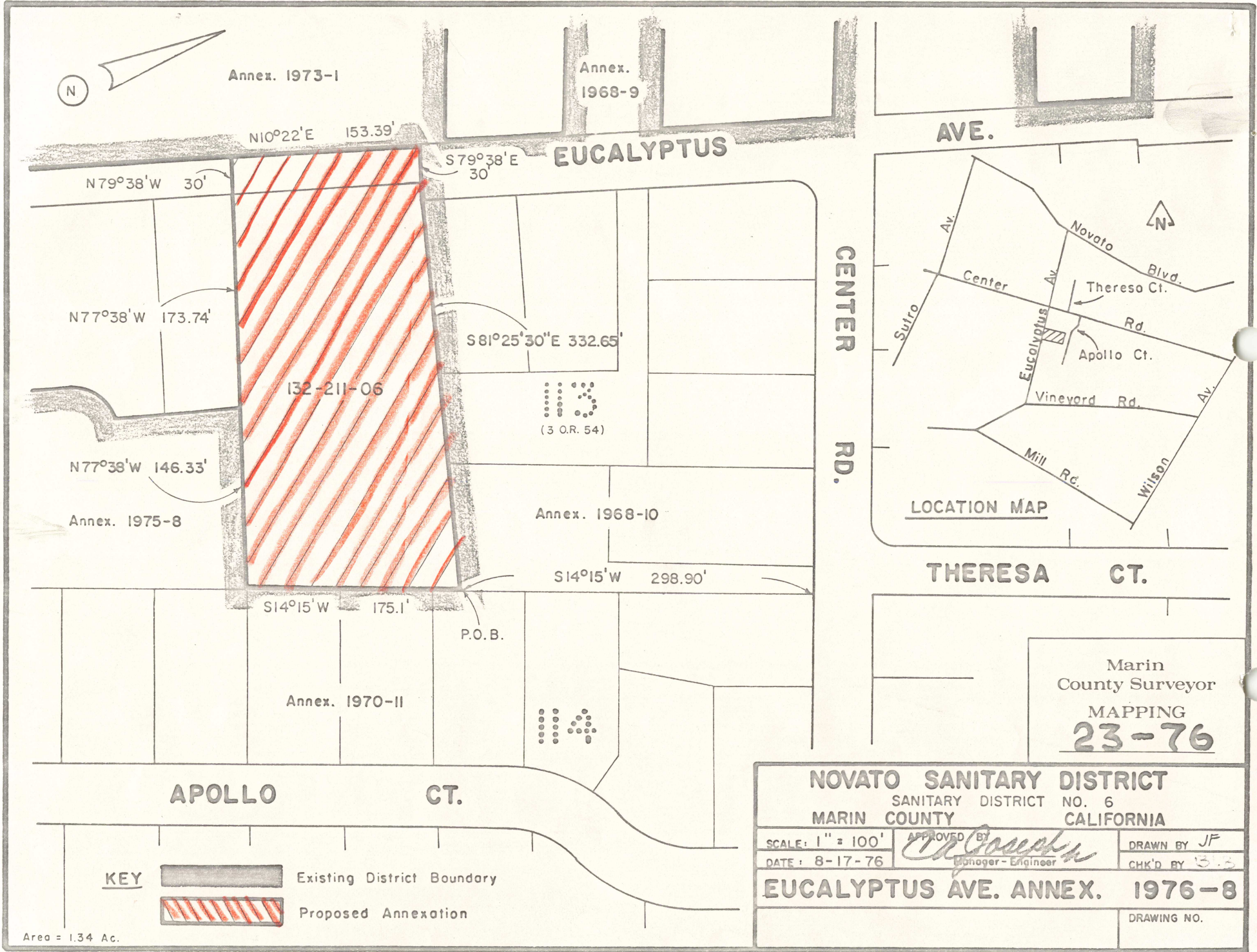

KEY

 Existing District Boundary

 Proposed Annexation

Area = 1.34 Ac.

NOVATO SANITARY DISTRICT		
SANITARY DISTRICT NO. 6		
MARIN COUNTY		CALIFORNIA
SCALE: 1" = 100'	APPROVED BY <i>McJoseph</i> Manager - Engineer	DRAWN BY JF
DATE: 8-17-76		CHK'D BY <i>3.5</i>
EUCALYPTUS AVE. ANNEX. 1976-8		DRAWING NO.