

MARIN LOCAL AGENCY FORMATION COMMISSION

RESOLUTION NO. 00-13

**RESOLUTION MAKING DETERMINATIONS AND APPROVING ANNEXATION
WITH WAIVER OF NOTICE, HEARING AND ELECTION
TO THE NOVATO SANITARY DISTRICT**

“Annexation of the Lands of Ravicz/Jackson to Novato Sanitary District (File #1180)”

WHEREAS, a proposal for the annexation of certain territory to the Novato Sanitary District has been filed with the Executive Officer of the Marin Local Agency Formation Commission pursuant to Title 5, Division 3, commencing with Section 56000 of the Government Code; and

WHEREAS, said proposal was made in the form of a petition, filed by the property owners; and

WHEREAS, said a petition of application was signed by all owners of land within the territory proposed to be annexed; and

WHEREAS, pursuant to Government Code Section 56837, when a petition of application is accompanied by written consent signed by all owners of land within the Territory proposed to be annexed, this Commission may make determination with respect to said annexation without notice and hearing; and

WHEREAS, the Executive Officer has reviewed the proposal and prepared a report, including a recommendation thereon, the proposal and report having been presented to and considered by this Commission; and

NOW THEREFORE, the Marin Local Agency Formation Commission **DOES HEREBY RESOLVE, DETERMINE AND ORDER** as follows:

Section 1. Subject to the terms and conditions hereinafter specified, the proposed annexation is approved.

Section 2. The boundaries, as set forth in the proposal, are hereby approved as submitted and are as described in Exhibits “A” and “B” attached hereto and by this reference incorporated herein.

The foregoing instrument is a correct copy of the original on record in the office of the Local Agency Formation Commission of the County of Marin, State of California.

By _____

Dory Adams

Section 3. The territory includes 2.26 acres, is found to be uninhabited, and is assigned the following distinctive short form designation: "Annexation of the Lands of Ravicz/Jackson to Novato Sanitary District (File #1180)."

Section 4. The proposal is consistent with the adopted sphere of influence for the Novato Sanitary District.

Section 5. Any resolution authorizing the annexation approved by this resolution shall impose the following terms and conditions:

The applicant will provide a revised map and legal description with the assigned short form title of "Annexation of the Lands of Ravicz/Jackson to Novato Sanitary District (File #1180)" and meeting the technical requirements of the State Board of Equalization.

Section 6. The Novato Sanitary District is designated as the conducting authority for further proceedings, and the Board of said District is hereby directed to initiate proceedings in compliance with this resolution and is authorized to proceed without notice, hearing or election, pursuant to Government Code Section 56837.

Section 7. The Executive Officer is hereby authorized and directed to mail certified copies of the resolution in the manner prescribed by Section 56853 of the Government Code.

PASSED AND ADOPTED by the Marin Local Agency Formation Commission on this 10th day of August, 2000 by the following vote:

AYES: Commissioners Blanchfield, Chapman, Heller, Hennessy, Kress, Murray and Ware

NOES: None

ABSENT: None



JEFFRY BLANCHFIELD, Chairperson

ATTEST:

PETER V. BANNING, Executive Officer

August 14, 2000

**Lands of Ravicz and Jackson Annexation of the
To the Novato Sanitary District**

Exhibit "A"

Mapping No. 11 / 00

Being a portion of lot 104 as shown on that certain map entitled "Amended Map No 1 of Subdivision "E" of the Novato Ranch, Marin County, California. Filed July 5, 1910 in Book 3 of Maps Page 54, Marin County Records. More particularly described as follows.

Beginning at a point on the existing boundary of the Novato Sanitary District, said point being at the most northerly corner of said Lot 104. Thence from said Point of Beginning along the Northeasterly line of Lot 104 South 75° 45' East 260.36 feet to a point on the Northeasterly boundary of Lot 104; thence from said point South 14° 15' West 184.63 feet to the terminus of the Southerly right of way of Mendocino Lane (45' wide) with Lot 104; Said point also being the Northwesterly corner of Lot 1 as shown on Map recorded in book 4 of Parcel maps at Page 59; thence from said point South 75° 45' East along the aforementioned southerly right of way 75.00' to the Northeasterly corner of Lot 1; thence from said Northeasterly corner South 14° 15' South 148.83 feet to the Southeasterly corner of said parcel; thence North 75° 45' West 335.36 feet to a point on the westerly boundary of the aforementioned Lot 104; thence North 14° 15' East 334.62 feet more or less to the Point of Beginning.

Said Annexation contains 2.26 acres, more or less

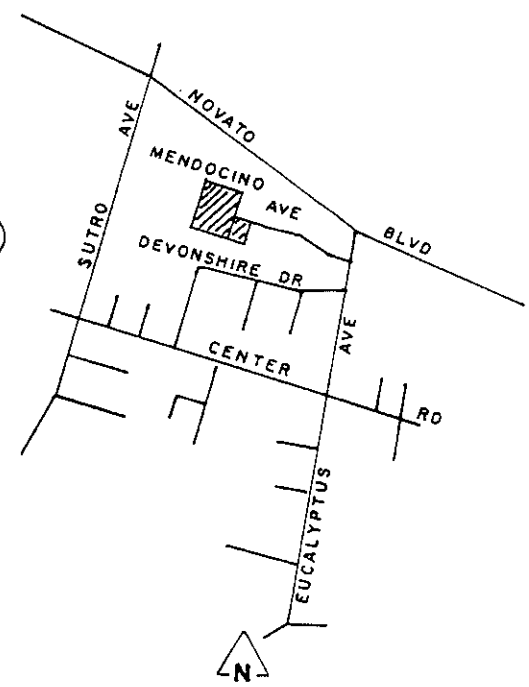
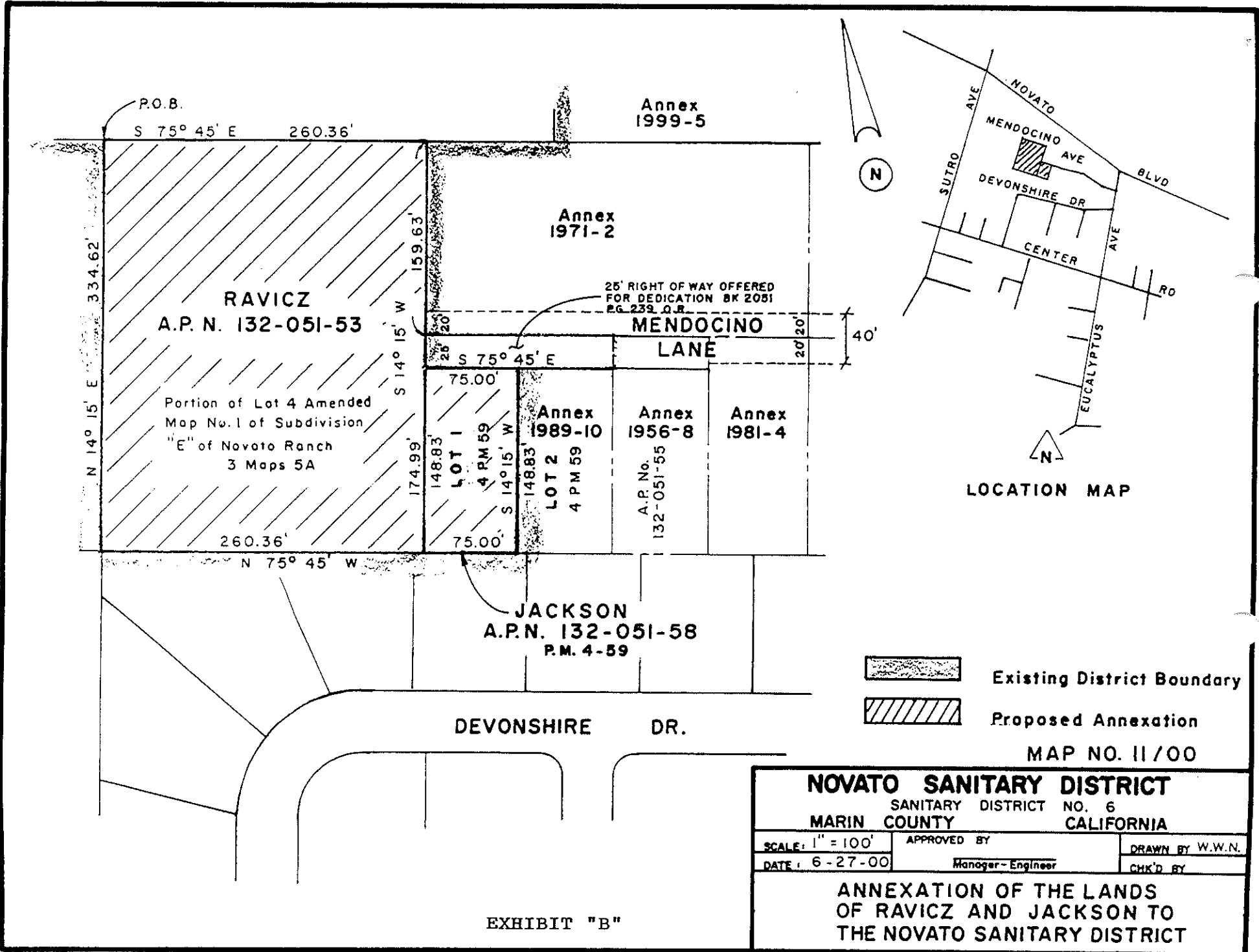

MAP NO. 11/00

NOVATO SANITARY DISTRICT
SANITARY DISTRICT NO. 6
MARIN COUNTY CALIFORNIA

SCALE: 1" = 100'	APPROVED BY	DRAWN BY W.W.N.
DATE: 6-27-00	Manager-Engineer	CHK'D BY

ANNEXATION OF THE LANDS OF RAVICZ AND JACKSON TO THE NOVATO SANITARY DISTRICT

EXHIBIT "B"