

LOCAL AGENCY FORMATION COMMISSION OF MARIN COUNTY

RESOLUTION NO. 78-37

RESOLUTION MAKING DETERMINATIONS AND APPROVING ANNEXATION
WITH WAIVER OF NOTICE, HEARING, AND ELECTION
TO THE NOVATO SANITARY DISTRICT

BENTON LANE ANNEXATION 1978-9

WHEREAS, a proposal for the annexation of certain territory to the Novato Sanitary District, in the County of Marin, has been filed with the Executive Officer of this Commission; and,

WHEREAS, said proposal was made in the form of Resolution No. 1737, a resolution of application adopted by the Board of Directors of the Novato Sanitary District, and requesting the initiation of annexation proceedings pursuant to the District Reorganization Act of 1965, Division 1 (commencing with Section 56000) of Title 6 of the Government Code; and,

WHEREAS, said resolution of application was accompanied by written consent signed by all owners of land within the territory proposed to be annexed; and,

WHEREAS, pursuant to Government Code Section 56261, when a resolution of application is accompanied by written consent of all owners of land within the territory proposed to be annexed, this Commission may make determinations with respect to said annexation without notice and hearing;

NOW, THEREFORE, the Local Agency Formation Commission of the County of Marin, DOES HEREBY RESOLVE, DETERMINE AND ORDER as follows:

Section 1. Subject to the terms and conditions hereinafter specified, the proposal made by Resolution No. 1737 adopted by the Board of Directors of the Novato Sanitary District is approved.

Section 2. The boundaries of the territory proposed to be annexed shall be those set forth in Exhibit A, attached hereto and incorporated herein; and, said territory, which is uninhabited, shall be designated as the "Benton Lane Annexation 1978-9".

Section 3. Any resolution ordering the annexation approved by this resolution shall provide that such annexation is ordered subject to the terms and conditions specified in the resolution of application.

Section 4. The Novato Sanitary District is designated as the conducting district for further proceedings; and, the Board of Directors of said District is hereby directed to initiate proceedings in compliance with this resolution, and is authorized to proceed without notice or hearing pursuant to Government Code Section 56261.

Section 5. The environmental documents relevant to the proposed annexation have been reviewed and considered by the Commission in making its final determination. Pursuant to the California Environmental Quality Act and the Commission's Environmental Guidelines, Lafco has certified a Negative Declaration issued by the City of Novato which is the project's lead agency.

Section 6. The Executive Officer is hereby authorized to mail certified copies of this resolution in the manner and as prescribed by law.

PASSED AND ADOPTED by the Marin Local Agency Formation Commission on this 13th day of December 1978 by the following vote:

AYES: Commissioners Baptiste, Haehl, Rice, Violich and Mulryan

NOES: None

ABSENT: None



LAWRENCE E. MULRYAN, Chairman
Marin Local Agency Formation Commission

ATTEST:



WARREN K. NELSON, Executive Officer

DATE: December 14, 1978

NOVATO SANITARY DISTRICT
BENTON LANE ANNEXATION 1978-9

EXHIBIT "A"

Beginning at a point on the existing boundary of Novato Sanitary District, said point being on the northerly line of that certain 50 foot Right-of-Way, now called Benton Lane, at its intersection with the westerly line of Lot 83 as said Benton Lane and Lot are shown upon that certain map entitled "Subdivision Three, Sweetser Ranch, Novato, California", filed November 14, 1913 in Liber 4 of Maps at Page 60, Marin County Records; thence running along said Sanitary District boundary and said northerly line of Benton Lane easterly to its intersection with the southeasterly line of said Lot 83; thence leaving said northerly line of Benton Lane and continuing along said Sanitary District boundary and running along said southeasterly line of Lot 83 northeasterly to the most easterly corner of said Lot; thence leaving said Sanitary District boundary and running along the northeasterly line of said Lot 83 north $49^{\circ} 19'$ West 595.3 feet to a point on said Sanitary District boundary; thence running along said Sanitary District boundary and along the northerly line and said westerly line of said Lot 83 to the point of beginning.

CONTAINING 12.7 acres

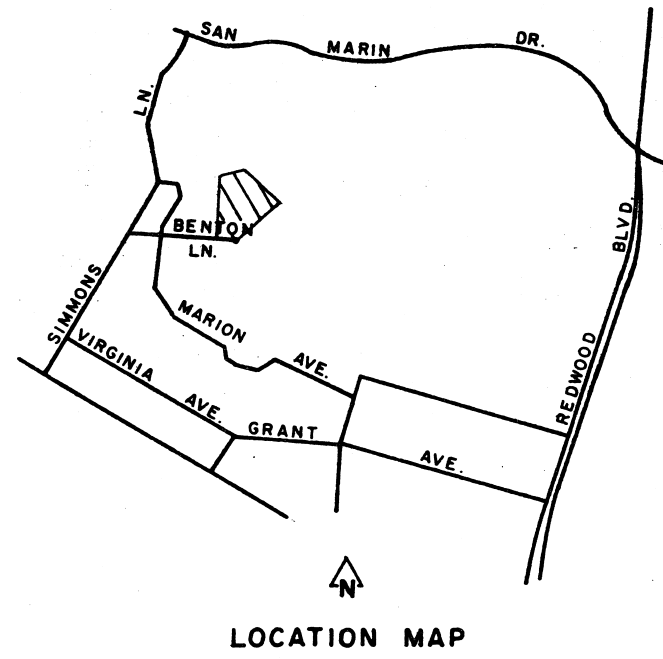
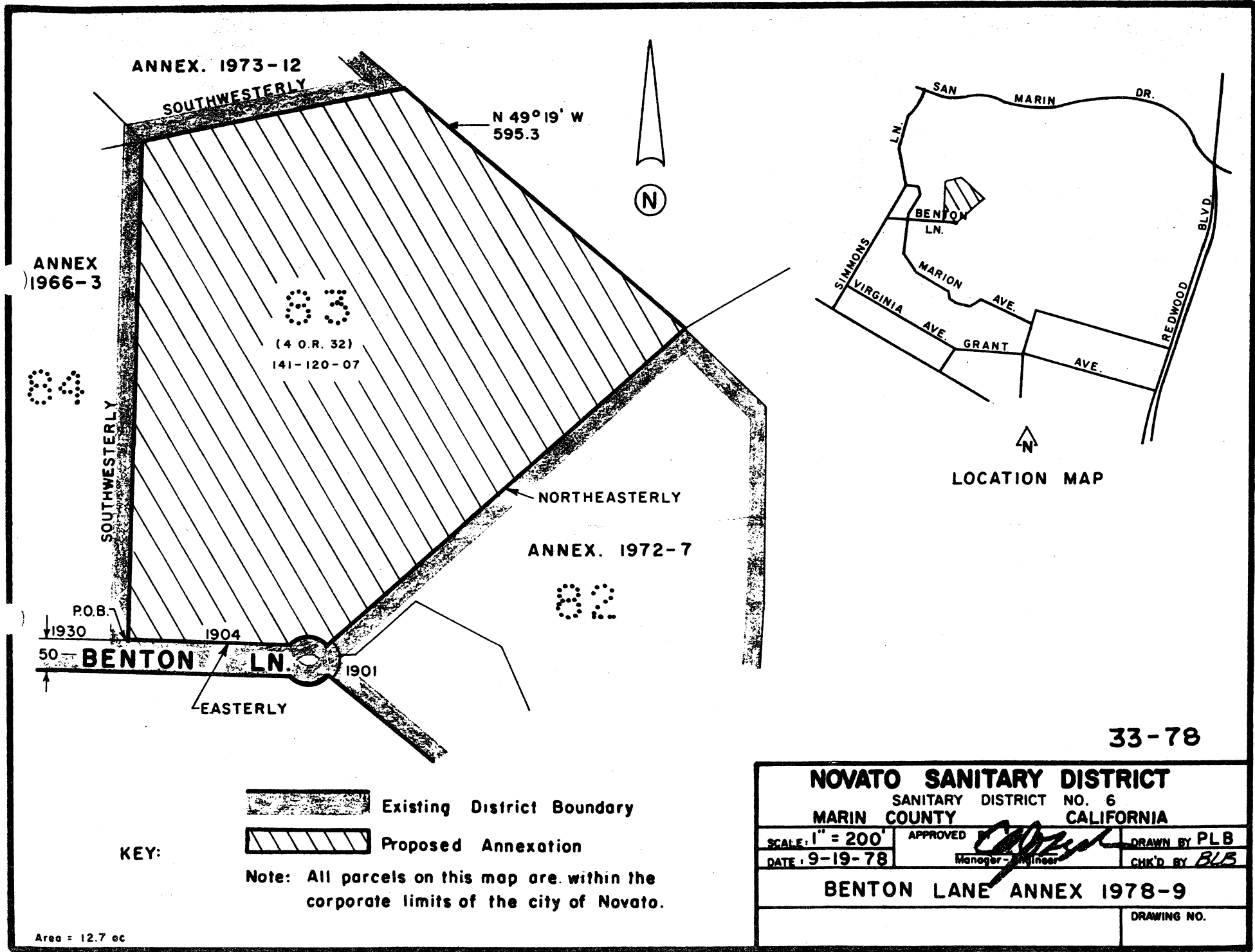

33-78

KEY:

 Existing District Boundary

 Proposed Annexation

Note: All parcels on this map are within the corporate limits of the city of Novato.

Area = 12.7 ec

NOVATO SANITARY DISTRICT		
SANITARY DISTRICT NO. 6		
MARIN COUNTY CALIFORNIA		
SCALE: 1" = 200'	APPROVED 	DRAWN BY PLB
DATE: 9-19-78	Manager-Engineer	CHK'D BY BLB
BENTON LANE ANNEX 1978-9		
		DRAWING NO.