

LOCAL AGENCY FORMATION COMMISSION OF MARIN COUNTY

RESOLUTION NO. 74-24

RESOLUTION MAKING DETERMINATIONS AND APPROVING THE ANNEXATION OF
TERRITORY DESIGNATED AS WILSON AVENUE ANNEXATION NO. 1974-5
TO SANITARY DISTRICT NO. 6

WHEREAS, a proposal for the annexation of certain territory to Sanitary District No. 6 in the County of Marin, has been filed with the Executive Officer of this Commission; and

WHEREAS, said proposal was made in the form of Resolution No. 1449, a resolution of application adopted by the Board of Directors of Sanitary District No. 6, and requesting the initiation of annexation proceedings pursuant to the District Reorganization Act of 1965, Division 1 (commencing with Section 56000) of Title 6 of the Government Code; and

WHEREAS, said resolution of application was accompanied by written consent signed by all owners of land within the territory proposed to be annexed; and

WHEREAS, pursuant to Government Code Section 56261, when a resolution of application is accompanied by written consent of all owners of land within the territory proposed to be annexed, this Commission may make determinations with respect to said application without notice and hearing,

NOW, THEREFORE, the Local Agency Formation Commission of the County of Marin, does hereby resolve, determine and order as follows:

1. Subject to the terms and conditions hereinafter specified the proposal made by Resolution No. 1449 adopted by the Board of Directors of Sanitary District No. 6 is approved.

2. The boundaries of the territory proposed to be annexed shall be those set forth in the proposal filed with this Commission; and said territory shall be designated as Wilson Avenue Annexation 1974-75 and is found to be uninhabited.

3. Any resolution ordering the annexation approved by this resolution shall provide that such annexation is ordered subject to terms and conditions specified in the resolution of application.

4. Sanitary District No. 6 is designated as the conducting district for further proceedings; and the Board of Directors of said district is hereby directed to initiate proceedings in compliance with this resolution, and is authorized to proceed without notice or hearing pursuant to Government Code Section 56261.

5. The executive Officer is hereby authorized and directed to mail certified copies of this resolution in the manner and as described in Section 56272 of the Government Code.

PASSED AND ADOPTED by the Marin County Local Agency Formation Commission on this 19th day of June, 1974, by the following vote:

AYES: Commissioners Giacomini, Jones, Sestak and Marchant

NOES: None

ABSENT: Commissioner Baptiste

ABSTAIN:



Hugh S. Marchant, Chairman, Local Agency
Formation Commission of the County of Marin

ATTEST:



Executive Officer

SANITARY DISTRICT NO. 6 OF MARIN COUNTY

WILSON AVENUE ANNEXATION 1974-5

EXHIBIT "A"

Beginning at a point on the existing boundary of Sanitary District No. 6 of Marin County, said point being on the northwesterly line of Wilson Avenue, (40 feet wide), at its intersection with the southerly line of Lot 121, as said Avenue and Lot are shown upon that certain map entitled "Amended Map No. 1 of Subdivision 'E' of the Novato Ranch, Marin County, California", filed July 6, 1910 in Book 3 of Maps at Page 54, Marin County Records; thence leaving said northwesterly line of Wilson Avenue and running along said Sanitary District boundary and said southerly line of Lot 121 North $84^{\circ} 08' 24''$ West 476.2 feet, more or less, to the southwest corner of said Lot; running thence along the westerly line of said Lot North $14^{\circ} 15'$ East 195.9 feet; thence South $75^{\circ} 39'$ East 506.0 feet to said northwesterly line of Wilson Avenue, (40 feet wide); thence along said northwesterly line South $29^{\circ} 15'$ West 126.33 feet to the point of beginning.

Annex. 1973-4
(in progress)

2
3 OR 54

Annex. 1964-11

N 14° 15' E
195.9'

132-231-06

S 29° 15' W
126.33'

Area to be Annexed

Sanitary District

Annex. 1970-2

No. 6

158

Annex. 1954-8

VINEYARD RD.

RD.

WILSON

AVE

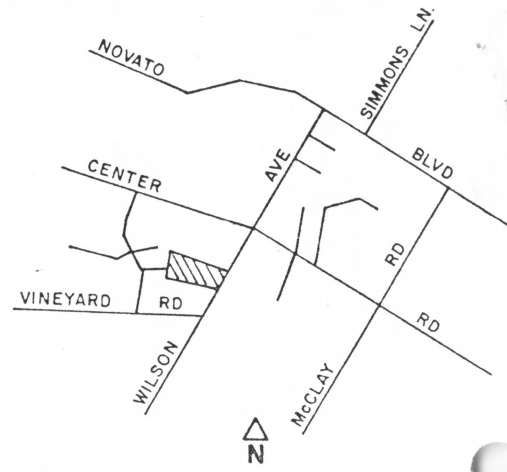

LOCATION MAP

KEY: Existing District Boundary
 Proposed Annexation

NOVATO SANITARY DISTRICT		
SANITARY DISTRICT NO 6		
MARIN COUNTY		CALIFORNIA
SCALE: 1" = 100'	APPROVED BY:	DRAWN BY RLB
DATE: 3-16-74	Manager - Engineer	Chk'd By F.L.L.
WILSON AVE. ANNEX. 1974-5		
		DRAWING NUMBER

Area = 1.84 ac