

LOCAL AGENCY FORMATION COMMISSION OF MARIN COUNTY

RESOLUTION NO. 76-9

RESOLUTION MAKING DETERMINATIONS AND APPROVING THE ANNEXATION OF
TERRITORY DESIGNATED AS NIKE CONTROL SITE ANNEXATION
TO THE CITY OF SAN RAFAEL

WHEREAS, a proposal for the annexation of territory to the City of San Rafael has been filed with the Executive Officer of this Commission; and

WHEREAS, said proposal was made in the form of application submitted by the City of San Rafael in accordance with the provisions of the Knox-Nisbet Act, Chapter 6.6 (commencing with Section 54773) of Division 2, Title 5 of the Government Code; and

WHEREAS, said resolution of application was accompanied by written consent signed by all owners of land within the territory proposed to be annexed; and

WHEREAS, pursuant to Government Code Section 54797.1 when a resolution of application is accompanied by written consent of all owners of land within the territory proposed to be annexed, this Commission may make determinations with respect to said application without notice and hearing.

NOW THEREFORE, the Local Agency Formation Commission of the County of Marin DOES HEREBY RESOLVE, DETERMINE AND ORDER as follows:

1. Subject to the terms and conditions hereinafter specified, the proposal made by application submitted by the City of San Rafael is approved.
2. The boundaries of the territory proposed to be annexed shall be those set forth in Exhibit A attached hereto and incorporated herein; and said territory shall be designated as the "Nike Control Site Annexation".
3. The Nike Control Site Annexation is, and shall, not be subject to any terms and conditions.
4. The City of San Rafael shall be the conducting agency for further proceedings to annex this territory; and the City Council of San Rafael is hereby directed to take further proceedings upon said annexation in compliance with this resolution, and is authorized to proceed without notice or hearing pursuant to Government Code Section 54797.1.
5. The environmental documents relevant to the proposed annexation have been reviewed and considered by the Commission in making its final determination.

PASSED AND ADOPTED by the Marin County Local Agency Formation
Commission on this 18th day of February 1976, by the following vote:

AYES: Commissioners Arrigoni, Giacomini, Violich and Jones

NOES: None

ABSTAIN: Commissioner Mulryan

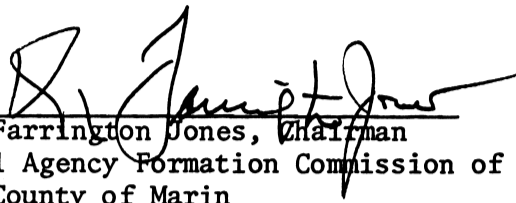

Roy Farrington Jones, Chairman
Local Agency Formation Commission of
the County of Marin

ATTEST:



Lari Sheehan, Executive Officer

DESCRIPTION OF "NIKE CONTROL SITE"
ANNEXATION TO THE CITY OF SAN RAFAEL
1-76

Beginning at a point on the existing San Rafael City Limit line, said point being the intersection of the courses South $77^{\circ}25'20''$ East, 259.05 feet and North $32^{\circ}41'20''$ East, 25.03 feet, said intersection being the most northwesterly corner of the parcel described in Book 2645 of Deeds, at page 11, Marin County Records; thence leaving said existing San Rafael City Limit line, and proceeding North $32^{\circ}41'20''$ East, 87.22 feet; thence North $85^{\circ}35'00''$ East, 244.08 feet; thence South $30^{\circ}00'00''$ East, 369.92 feet; thence South $44^{\circ}00'00''$ West, 138.96 feet; to a point on the existing San Rafael City Limit line; said point being the intersection of the courses South $36^{\circ}48'50''$ East, 19.19 feet; and South $44^{\circ}00'$ West, 21.11 feet as said intersection is described in Book 2645 of Deeds, at page 11, Marin County Records; thence northwesterly along the San Rafael City Limit to the point of beginning.

Parcel contains approximately 1.43 acres more or less.



SCALE: 1"=100'

ANNEXATION OF "NIKE CONTROL SITE" TO THE CITY OF SAN RAFAEL

PREPARED BY:

CITY OF SAN RAFAEL
DEPARTMENT OF PUBLIC WORKS
SAN RAFAEL, CALIFORNIA
NOVEMBER, 1975

Marin
County Surveyor

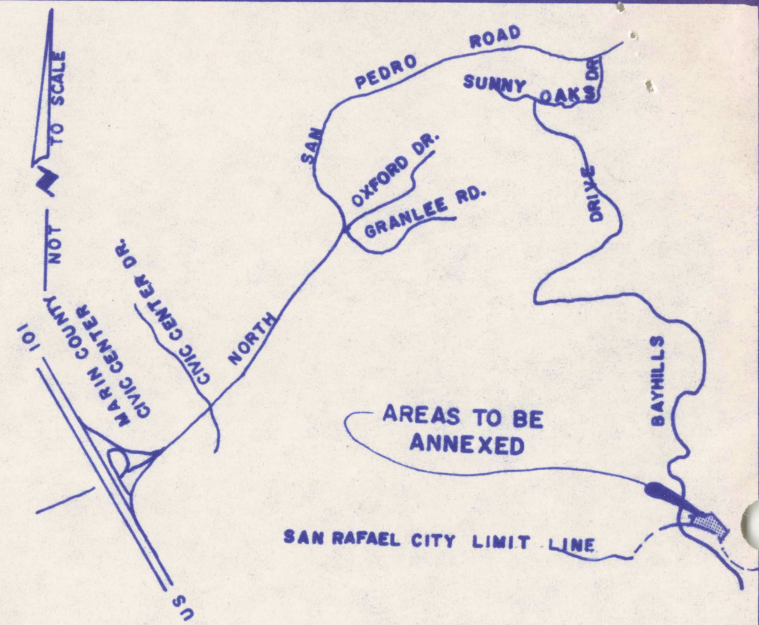
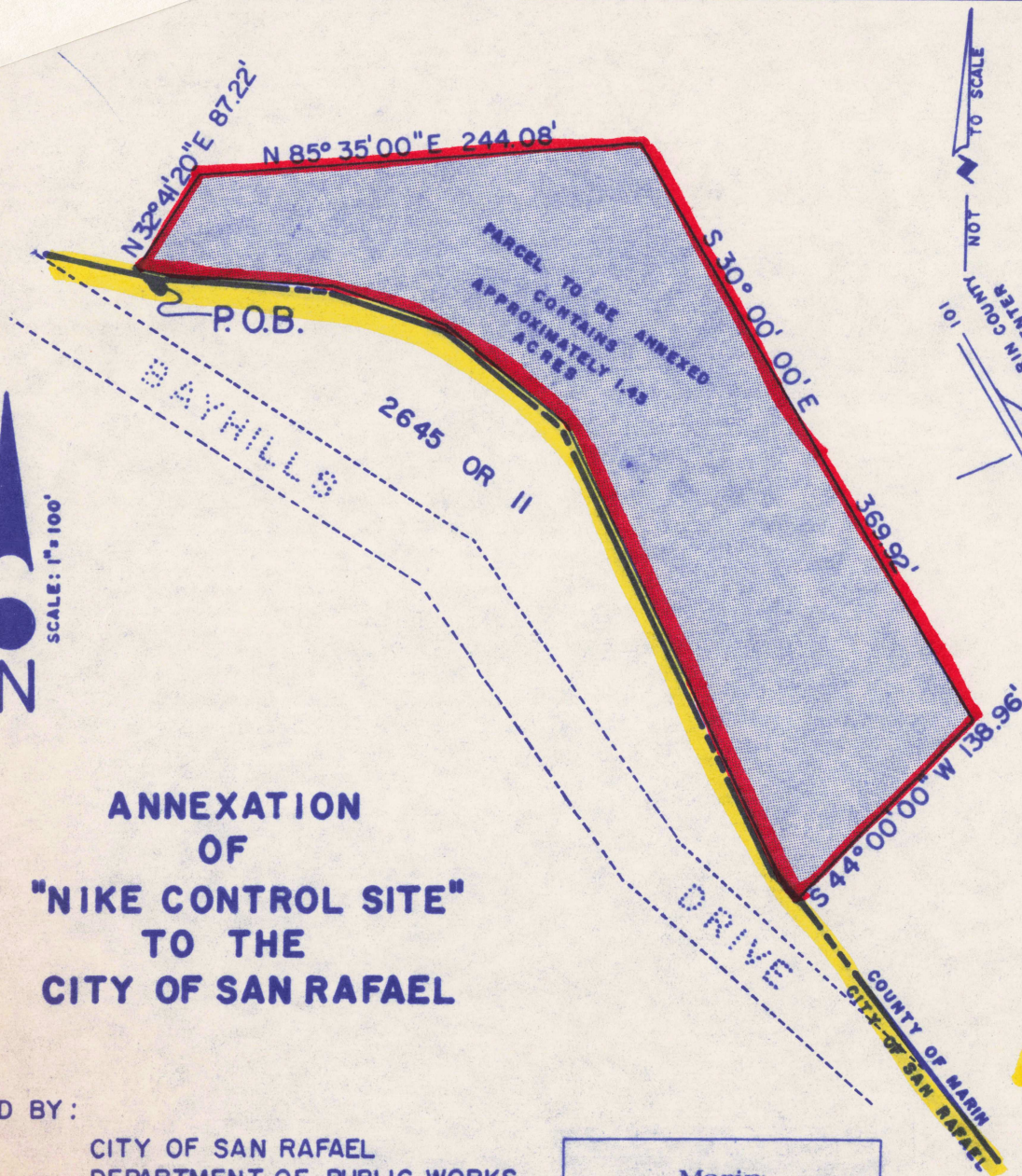

MAPPING

1-76



VICINITY MAP

LEGEND

-  LANDS TO BE ANNEXED TO THE CITY OF SAN RAFAEL
-  EXISTING CITY LIMIT LINE