

LOCAL AGENCY FORMATION COMMISSION OF THE COUNTY OF MARIN

RESOLUTION NO. 71-3

RESOLUTION APPROVING THE ANNEXATION OF TERRITORY TO
SANITARY DISTRICT NO. 6

VINEYARD ROAD ANNEX 1970-7

WHEREAS, a resolution of application No. 1175 has been filed by
Sanitary District No. 6, together with evidence of written
consent of all owners of property within the proposed annexation; and

WHEREAS, the Commission has found the territory to be annexed to be
uninhabited; and

WHEREAS, the Sanitary District No. 6
has not requested the Commission to hold a noticed public hearing in accordance
with Government Code Section 56261.

NOW, THEREFORE, BE IT RESOLVED by the Marin County Local Agency Forma-
tion Commission, in accordance with the District Reorganization Act of 1965, that
it does hereby approve the annexation of territory known as Vineyard Road
Annex 1970-7 to Sanitary District No. 6
with the following determinations:

1. Sanitary District No. 6 shall
be the conducting District for further proceedings to annex this territory and
the Board of Directors of that District is directed to initiate annexation pro-
ceedings in compliance with this resolution and the resolution of application.
Such proceedings may be without notice, without hearing, and without election.

2. The territory proposed for annexation shall be designated as
Vineyard Road Annex 1970-7.

PASSED AND ADOPTED by the Marin County Local Agency Formation Commission
on this 13th day of January, 1971 by the following vote:

AYES: Commissioners Arrigoni, Baar, Jones, Womack, Marchant

NOES: None

ABSENT: None

Chairman of the Local Agency Formation
Commission of the County of Marin

ATTEST:

Executive Officer

SANITARY DISTRICT NO. 6 OF MARIN COUNTY

VINEYARD ROAD ANNEX 1970-7

EXHIBIT "A"

BEGINNING at a point on the existing boundary of Sanitary District No. 6 of Marin County, said point being on the northerly line of Vineyard Road (40 feet wide), distant thereon South $89^{\circ} 34' 36''$ West 8.9 feet and South $60^{\circ} 51' 36''$ West 610.45 feet from its intersection with the centerline of Eucalyptus Avenue, as said Road and Avenue are shown upon that certain map entitled "Amended Map No. 1 of Subdivision 'E' of The Novato Ranch, Marin County, California", filed July 6, 1910 in Book 3 of Maps at Page 54, Marin County Records; running thence from said point of beginning, leaving said Sanitary District boundary and said northerly line of Vineyard Road North $13^{\circ} 30'$ East 249.73 feet; thence North $75^{\circ} 45'$ West 86.67 feet; thence South $14^{\circ} 15'$ West 335.83 feet to a point on said Sanitary District boundary and on said northerly line of Vineyard Road; thence along said Sanitary District boundary and along said northerly line of Vineyard Road North $60^{\circ} 51' 36''$ East 124 feet, more or less, to the point of beginning.

Annex.
1956-1

154
3 O.R. 54

N 75° 45' W
86.67'

N 13° 30' E
249.73'

S 14° 15' W
335.83'

pob

N 60° 51' 36" E
124' ±

S 89° 34' 36" W
8.9'

610.45'

S 60° 51' 36" W

EUCALYPTUS AVE

Annex. 1964-5



KEY: Existing District Boundary
 Proposed District Boundary

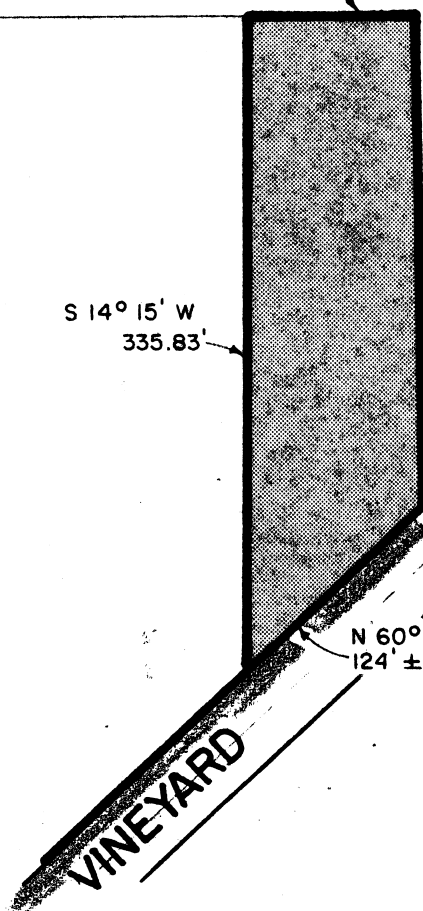

NOVATO SANITARY DISTRICT

(SANITARY DISTRICT NO. 6)

MARIN COUNTY CALIFORNIA

SCALE: 1" = 100'

APPROVED BY

DRAWN BY RLB

DATE: 11-9-70

Manager - Engineer

Chk'd By RLB

VINEYARD RD. ANNEX. 1970-7

DRAWING NUMBER