

LOCAL AGENCY FORMATION COMMISSION OF MARIN COUNTY

RESOLUTION NO. 78-36

RESOLUTION MAKING DETERMINATIONS AND APPROVING ANNEXATION
WITH WAIVER OF NOTICE, HEARING, AND ELECTION
TO NOVATO SANITARY DISTRICT

OLIVE AVENUE ANNEXATION 1978-14

WHEREAS, a proposal for the annexation of certain territory to the Novato Sanitary District, in the County of Marin, has been filed with the Executive Officer of this Commission; and,

WHEREAS, said proposal was made in the form of Resolution No. 1738, a resolution of application adopted by the Board of Directors of the Sanitary District, and requesting the initiation of annexation proceedings pursuant to the District Reorganization Act of 1965, Division 1 (commencing with Section 56000) of Title 6 of the Government Code; and,

WHEREAS, said resolution of application was accompanied by written consent signed by all owners of land within the territory proposed to be annexed; and,

WHEREAS, pursuant to Government Code Section 56261, when a resolution of application is accompanied by written consent of all owners of land within the territory proposed to be annexed, this Commission may make determinations with respect to said annexation without notice and hearing,

NOW, THEREFORE, the Local Agency Formation Commission of the County of Marin, DOES HEREBY RESOLVE, DETERMINE AND ORDER as follows:

Section 1. Subject to the terms and conditions hereinafter specified, the proposal made by Resolution No. 1738, adopted by the Board of Directors of the Novato Sanitary District, is approved.

Section 2. The boundaries of the territory proposed to be annexed shall be those set forth in Exhibit A, attached hereto and incorporated herein; and, said territory shall be designated as the "Olive Avenue Annexation 1978-14" and is found to be uninhabited.

Section 3. Any resolution ordering the annexation approved by this resolution shall provide that such annexation is ordered subject to the terms and conditions specified in the resolution of application.

Section 4. The Novato Sanitary District is designated as the conducting district for further proceedings, and the Board of Directors of said District is hereby directed to initiate proceedings in compliance with this resolution and is authorized to take further proceedings upon said annexation with waiver of notice, hearing, and election in compliance with applicable provisions of state law.

Section 5. The environmental documents relevant to the proposed annexation have been reviewed and considered by the Commission in making its final determination. Pursuant to the California Environmental Quality Act and the Commission's Environmental Guidelines, Lafco hereby certifies the adequacy of these documents.

Section 6. The Executive Officer is hereby authorized and directed to mail certified copies of the resolution in the manner prescribed by Section 56272 of the Government Code.

PASSED AND ADOPTED by the Marin County Local Agency Formation Commission on this 14th day of February 1979 by the following vote;

AYES: Commissioners Haehl, Rice, U'Ren, Wilhelm and Violich

NOES: None

ABSENT: None

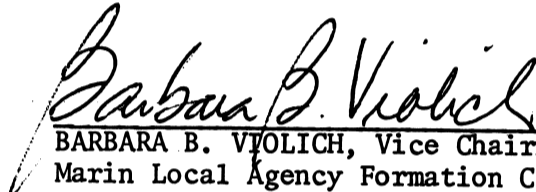
BARBARA B. VIOLICH, Vice Chairman
Marin Local Agency Formation Commission

ATTEST:

WARREN K. NELSON, Executive Officer

DATE: February 15, 1979

NOVATO SANITARY DISTRICT
OLIVE AVENUE ANNEXATION 1978-14

EXHIBIT "A"

Beginning at a point on the existing boundary of Novato Sanitary District, said point being on the northeasterly line of Olive Avenue (Olive Street) at its intersection with the dividing line between Lots 14 and 16 as said Avenue and Lots are shown upon that certain map entitled "Map of East Part Rancho De Novato, Marin County, California", filed March 22, 1889 in Rack 2, Pull 3, Marin County Records; thence leaving said Sanitary District boundary and running along said northeasterly line of Olive Avenue South $82^{\circ} 50'$ East (Magnetic) 1109.5 feet to its intersection with the easterly line of said Lot 14; thence leaving said northeasterly line of Olive Avenue and running along said easterly line of Lot 14 North $5^{\circ} 07'$ West (Magnetic) 1455 feet, more or less, to the northeasterly corner of said Lot; thence running along the northerly line of said Lot South 60° West (Magnetic) 461.96 feet; thence North $81^{\circ} 40'$ West (Magnetic) 198 feet; thence North $39^{\circ} 45'$ West (Magnetic) 258.3 feet; thence South $85^{\circ} 15'$ West (Magnetic) 198 feet; thence North $37^{\circ} 30'$ West (Magnetic) 264 feet to a point on said Sanitary District boundary and on the easterly line of said Lot 16; thence leaving said northerly line and running along said Sanitary District boundary and along said dividing line between Lots 14 & 16 southerly to the point of beginning.

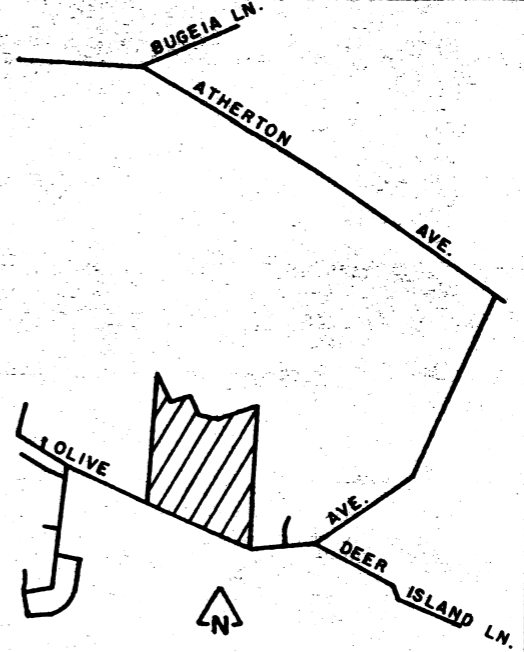
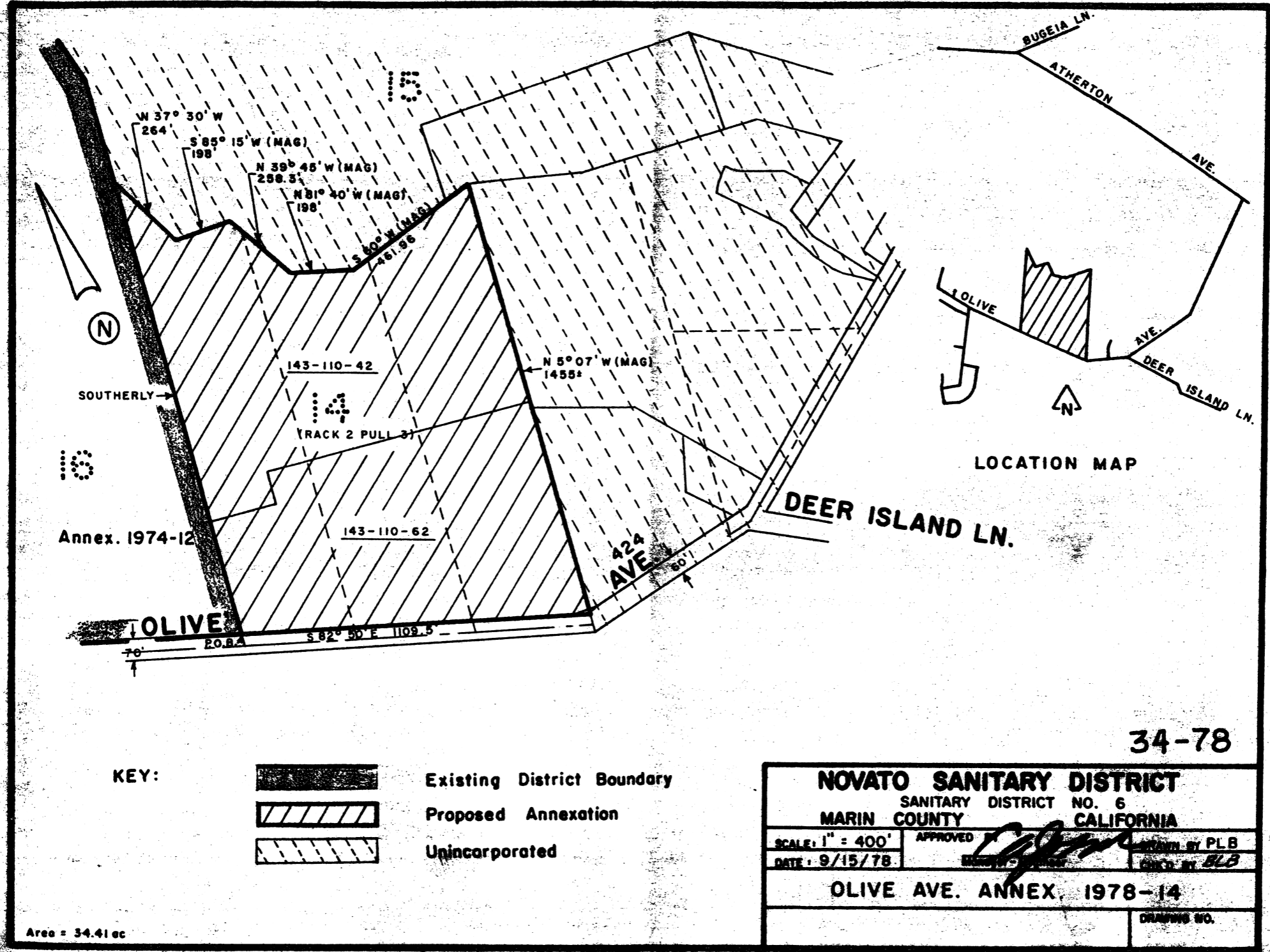

CONTAINING 34.41 acres



LOCATION MAP

Annex. 1974-12

KEY:

-  Existing District Boundary
-  Proposed Annexation
-  Unincorporated

Area = 34.41 ac

34-78

NOVATO SANITARY DISTRICT	
SANITARY DISTRICT NO. 6	
MARIN COUNTY CALIFORNIA	
SCALE: 1" = 400'	APPROVED 
DATE: 9/15/78	DRAWN BY PLB CHECKED BY BLB
OLIVE AVE. ANNEX, 1978-14	
DRAWING NO.	