

LOCAL AGENCY FORMATION COMMISSION OF THE COUNTY OF MARIN

RESOLUTION NO. 68-23

RESOLUTION APPROVING THE ANNEXATION OF TERRITORY TO
SANITARY DISTRICT NO. 6:

MARION AVENUE ANNEXATION 1968-3

WHEREAS, a resolution of application No. 1014 has been filed by
Sanitary District No. 6 together with evidence of written
consent of all owners of property within the proposed annexation; and

WHEREAS, the Commission has found the territory to be annexed to be un-
inhabited; and

WHEREAS, the Sanitary District No. 6
has not requested the Commission to hold a noticed public hearing in accordance
with Government Code Section 56261.

NOW, THEREFORE, BE IT RESOLVED by the Marin County Local Agency Forma-
tion Commission, in accordance with the District Reorganization Act of 1965, that
it does hereby approve the annexation of territory known as Marion Avenue
Annexation 1968-3 to Sanitary District No. 6
with the following determinations:

1. Sanitary District No. 6 shall
be the conducting District for further proceedings to annex this territory and
the Board of Directors of that District is directed to initiate annexation pro-
ceedings in compliance with this resolution and the resolution of application.
Such proceedings may be without notice of hearing and without election.

2. The territory proposed for annexation shall be designated as
Marion Avenue Annexation 1968-3.

PASSED AND ADOPTED by the Marin County Local Agency Formation Commission
on this 3rd day of October, 1968 by the following vote:

AYES: Commissioners Peter H. Behr, Jan Paul Dyk, H. G. Marchant, Thomas T. Storer
and J. Wayne Womack

NOES: None

ABSENT: None

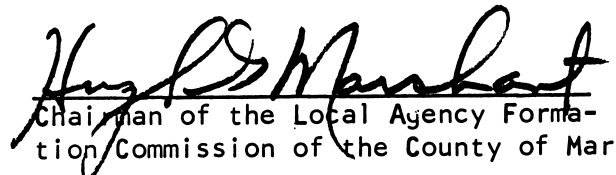
Chairman of the Local Agency Forma-
tion Commission of the County of Marin

ATTEST:



Executive Officer

SANITARY DISTRICT NO. 6 OF MARIN COUNTY

MARION AVENUE ANNEX 1968-3

EXHIBIT "A"

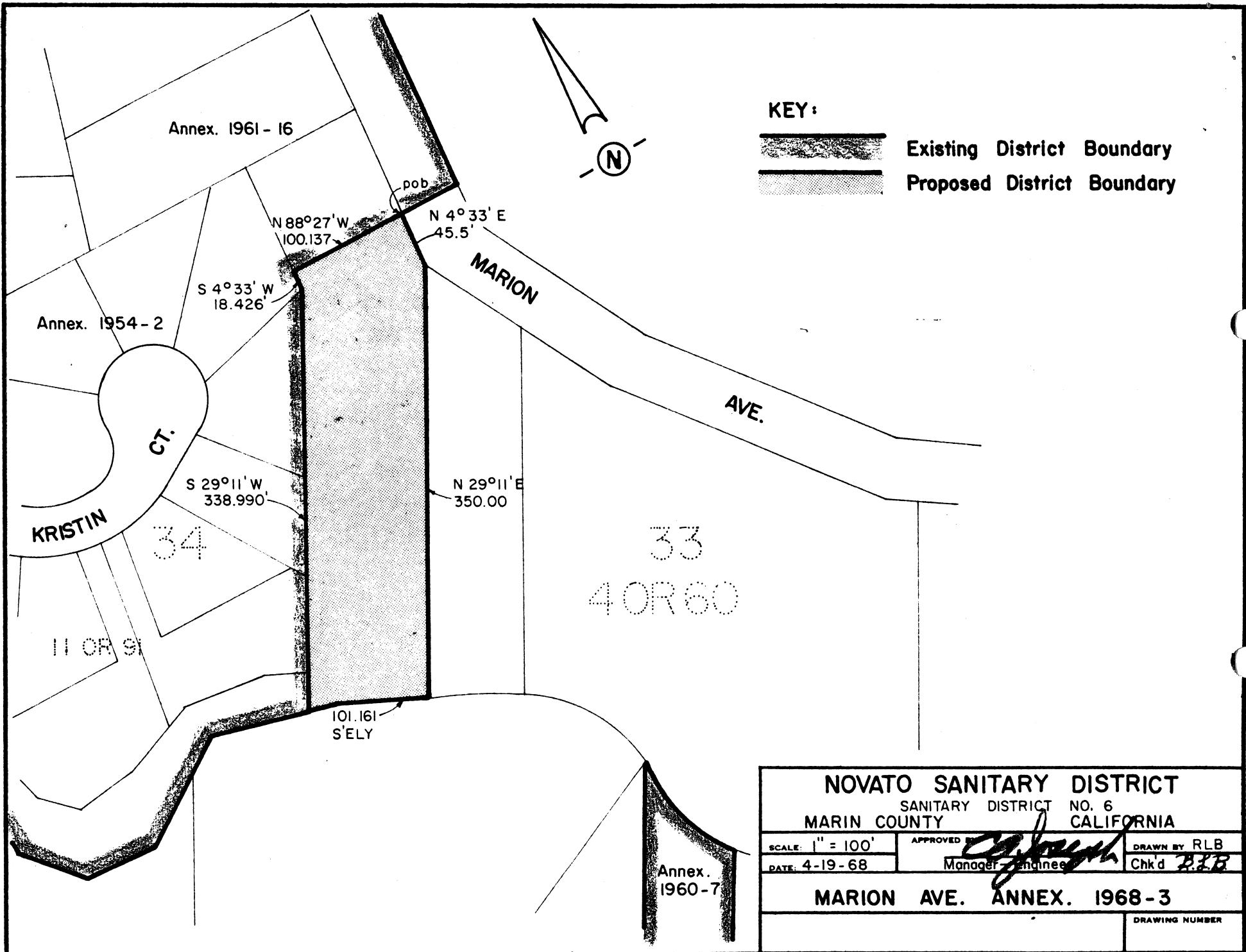
BEGINNING at a point on the existing boundary of Sanitary District No. 6 of Marin County, said point being on the Westerly line of Marion Avenue distant thereon North 4° 33' East 45.5 feet from the intersection of said Westerly line of Marion Avenue with the Easterly line of Lot 34 as said Avenue and Lot are shown upon that certain map entitled, "Subdivision Three Sweetser Ranch, Novato, California", filed November 14, 1913 in Liber 4 of Maps at Page 60, Marin County Records; thence leaving said Westerly line of Marion Avenue and running along said Sanitary District boundary North 88° 27' West 100.137 feet; thence South 4° 33' West 18.426 feet; thence South 29° 11' West 338.990 feet to a point on the Southerly line of said Lot 34; thence leaving said Sanitary District boundary and running along said Southerly line of Lot 34, Southeasterly 101.161 feet to the Southeasterly corner of said Lot 34; thence along the Easterly line of said Lot 34 North 29° 11' East 350.00 feet to its intersection with said Westerly line of Marion Avenue; thence along said Westerly line of Marion Avenue North 4° 33' East 45.5 feet to the point of beginning.



KEY:



Existing District Boundary
Proposed District Boundary

NOVATO SANITARY DISTRICT
SANITARY DISTRICT NO. 6
MARIN COUNTY CALIFORNIA

SCALE: 1" = 100'
DATE: 4-19-68

APPROVED BY: *[Signature]*
Manager-Engineer

DRAWN BY: RLB
CHK'd: RLB

MARION AVE. ANNEX. 1968-3

DRAWING NUMBER