

LOCAL AGENCY FORMATION COMMISSION OF THE COUNTY OF MARIN

RESOLUTION NO. 73-37

RESOLUTION MAKING DETERMINATIONS AND APPROVING THE ANNEXATION OF TERRITORY
DESIGNATED AS NOVATO BOULEVARD ANNEXATION 1973-10 TO
SANITARY DISTRICT NO. 6

WHEREAS, a proposal for the annexation of certain territories to Sanitary District No. 6 in the County of Marin has been filed with the Executive Officer of this Commission; and

WHEREAS, said proposal was made in the form of Resolution No. 1418, a resolution of application adopted by the Board of Directors of Sanitary District No. 6, and was accompanied by written consent signed by all owners of land within the territory proposed to be annexed; and

WHEREAS, pursuant to Government Code Section 56261, when a resolution of application is accompanied by written consent of all owners of land within the territory proposed to be annexed, this Commission may make determinations with respect to such application without notice and hearing.

NOW, THEREFORE, the Local Agency Formation Commission of the County of Marin, DOES HEREBY RESOLVE, DETERMINE AND ORDER as follows:

1. Subject to the terms and conditions hereinafter specified, the proposal made by Resolution No. 1418 adopted by the Board of Directors of Sanitary District No. 6 is approved.
2. The boundaries of the territory proposed to be annexed shall be those set forth in the proposal filed with this Commission; and said territory shall be designated as Novato Boulevard Annexation 1973-10 and is found to be uninhabited.

3. Any resolution ordering the annexation approved by this resolution shall provide that such annexation is ordered subject to the terms and conditions specified in the resolution of application.

4. Sanitary District No. 6 is designated as the conducting district for further proceedings, and the Board of Directors of said District is hereby directed to initiate proceedings in compliance with this resolution; and is authorized to proceed without notice and hearing pursuant to Government Code Section 56261.

5. The Executive Officer is hereby authorized and directed to mail certified copies of this resolution in the manner and as prescribed by Section 56272 of the Government Code.

PASSED AND ADOPTED by the Marin County Local Agency Formation Commission on this 19th day of December, 1973, by the following vote:

AYES: Commissioners Arrigoni, Baptiste, Jones, Mulryan, and Marchant

NOES: None

ABSENT: None

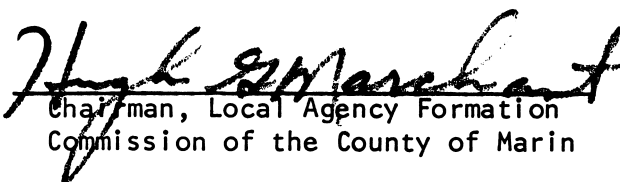
Chairman, Local Agency Formation
Commission of the County of Marin

ATTEST:



Executive Officer

LS:iq

SANITARY DISTRICT NO. 6 OF MARIN COUNTY

NOVATO BOULEVARD ANNEXATION - 1973-10

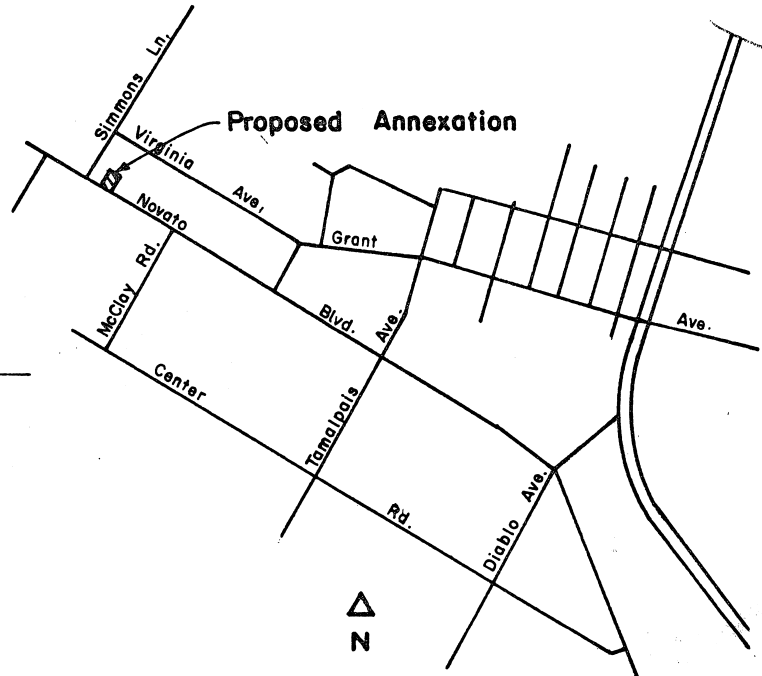
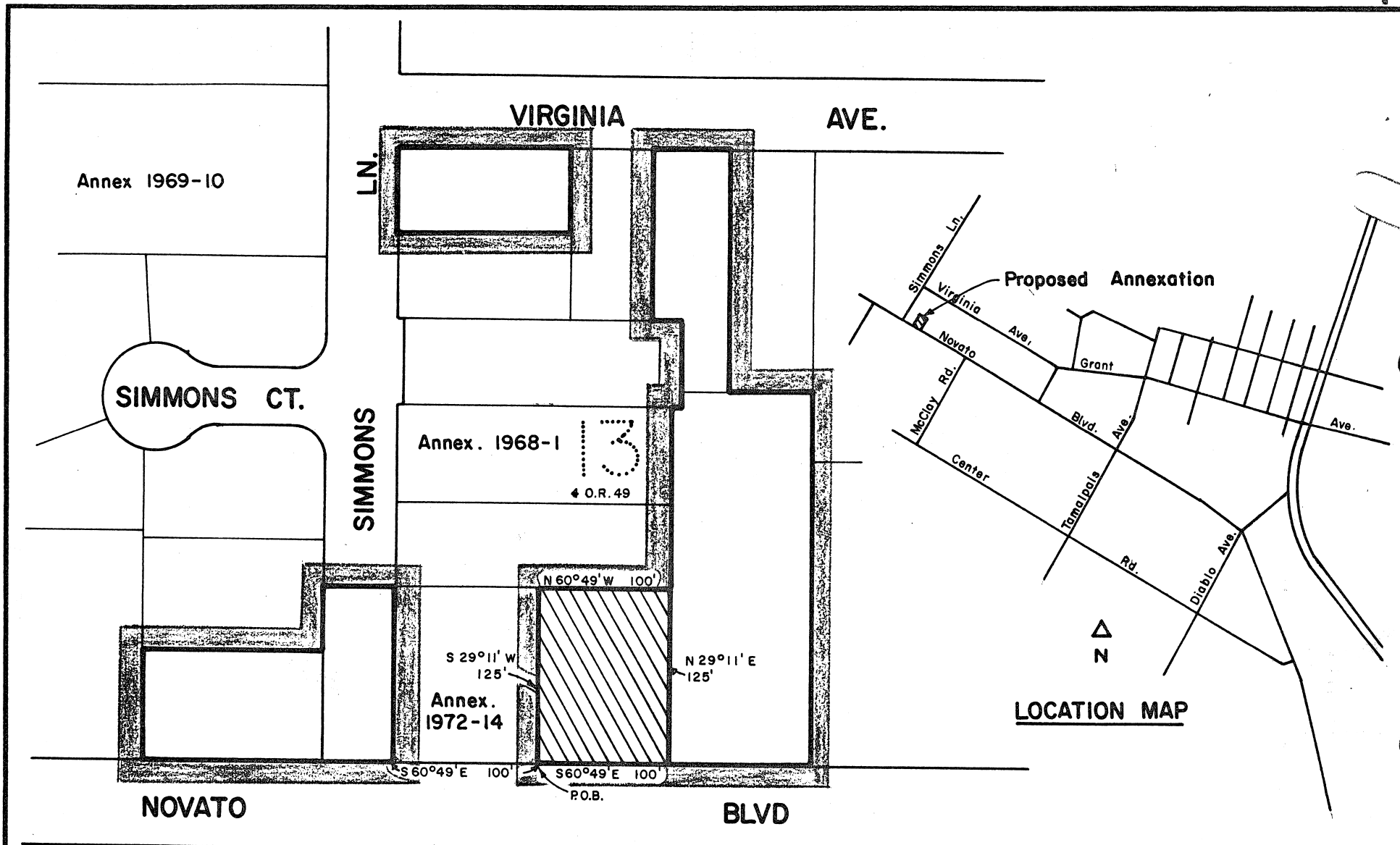

EXHIBIT "A"

BEGINNING at a point on the existing boundary of Sanitary District No. 6 of Marin County, said point being on the northeasterly line of Novato Boulevard, distant thereon South 60° 49' East 100 feet from its intersection with the southeasterly line of Simmons Lane, as said Boulevard and Lane are shown upon that certain map entitled "Subdivision One Sweetser Ranch, Novato, California", filed July 15, 1913 in Liber 4 of Maps at Page 49, Marin County Records, running thence along said Sanitary District boundary and along said northeasterly line of Novato Boulevard South 60° 49' East 100 feet; thence leaving said Sanitary District boundary and said northeasterly line of Novato Boulevard North 29° 11' East 125 feet to a point on said Sanitary District boundary; thence continuing along said Sanitary District boundary North 60° 49' West 100 feet; thence South 29° 11' West 125 feet to the point of beginning.





LOCATION MAP

Annex 1964-22

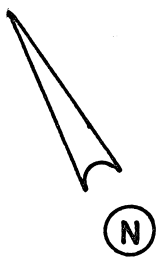
KEY:  Existing District Boundary
 Proposed Annexation



Area = 0.29 ac.

NOVATO SANITARY DISTRICT		
SANITARY DISTRICT No. 6		
MARIN COUNTY CALIFORNIA		
SCALE: 1" = 100'	APPROVED BY: 	DRAWN BY RLB
DATE: 10-2-73	Manager - Engineer	CHK'D BY 
NOVATO BLVD. ANNEX. 1973-10		
		DRAWING NUMBER