

LOCAL AGENCY FORMATION COMMISSION OF MARIN COUNTY

RESOLUTION NO. 78-26

RESOLUTION MAKING DETERMINATIONS APPROVING ANNEXATION OF THE
REDWOOD BLVD. - SEVENTH STREET ISLAND ANNEXATION

WHEREAS, the City Council representing the City of Novato adopted a resolution initiating proceedings No. 102-78 and submitted same to the Executive Officer of this Commission; and,

WHEREAS, said resolution proposed annexation of unincorporated island territory to the City of Novato in compliance with state law; and,

WHEREAS, the Executive Officer of this Commission has issued a certificate of filing, accepting said legal documents completed by the City of Novato and,

WHEREAS, legal notice of hearing was published and mailed notice of hearing was provided in accordance with state requirements; and,

WHEREAS, the Marin Local Agency Formation Commission conducted a public hearing, at which time all persons present were given an opportunity to speak and be heard regarding this annexation proposal; and,

WHEREAS, the Commission considered the Executive Officer's report and recommendations.

NOW, THEREFORE, the Local Agency Formation Commission of the County of Marin, DOES HEREBY RESOLVE, DETERMINE AND ORDER as follows:

Section 1. The boundaries of the uninhabited territory proposed to be annexed shall be those set forth in Exhibit A, attached hereto and incorporated herein, and said territory shall be designated as "Redwood Blvd. - Seventh Street Island Annexation".

Section 2. The Marin Local Agency Formation Commission hereby adopts the following findings of fact: The subject territory contained in this proposal (a) does not exceed 100 acres in area, which area constitutes the entire island; (b) is surrounded by the city; (c) is developing; (d) is not prime agricultural land; and, (e) will benefit from municipal annexation.

Section 3. The Redwood Blvd. - Seventh Street Island Annexation is hereby approved.

Section 4. In accordance with applicable provisions contained in the adopted Marin Lafco environmental guidelines and procedures, the City of Novato is the appropriate lead agency, has conducted an initial study incorporating concerns of said Commission, a responsible agency, and has issued a Negative Declaration. Lafco hereby certifies that the Commission has considered said documents.

Section 5. The Marin County Board of Supervisors is hereby determined to be the appropriate conducting authority, to direct complete annexation proceedings, and authorized to proceed.

Section 6. The Executive Officer is hereby authorized to mail certified copies of this resolution in the manner and as prescribed by law.

PASSED AND ADOPTED by the Marin Local Agency Formation Commission on this 13th day of December 1978 by the following vote:

AYES: Commissioners Baptiste, Haehl and Mulryan

NOES: Commissioners Rice and Violich

ABSENT: None

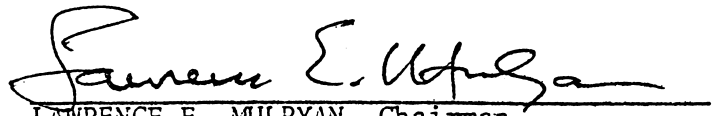
LAWRENCE E. MULRYAN, Chairman
Marin Local Agency Formation Commission

ATTEST:

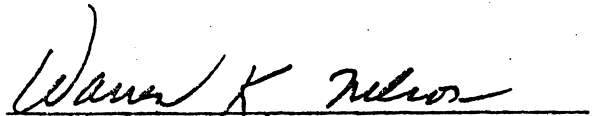
WARREN K. NELSON, Executive Officer

DATE: December 14, 1978

EXHIBIT "A"

Legal Description

"Redwood Boulevard - Seventh Street
Island Annexation"

Beginning at the northwest corner of Lot 1 per "Map of M & S Seventh Street Subdivision" recorded in Book 9 of Maps at Page 22, Marin County Records, said corner being on the Novato City Limits Line; thence along said City Limits Line, North 35°40'00" West 80.00 feet; thence North 13°16'00" West 156.90 feet; thence North 25°27'00" East 375.90 feet; thence North 25°41'00" West 233.00 feet; thence North 17°14'00" East 81.70 feet; thence North 1°03'00" West 247.20 feet; thence North 9°49'00" West 180.70 feet; thence 00°34'00" West 156.50 feet; thence North 5°57'00" West 169.10 feet; thence North 47°58'00" West 399.10 feet; thence North 7°41'00" West 317.40 feet; thence North 20°51'00" East 639.80 feet to the southerly right-of-way line of San Marin Drive; thence along said right-of-way line South 81°28'00" East 403.10 feet; thence North 87°11'00" East 292.10 feet; thence North 72°57'00" East 374.30 feet; thence leaving the southerly right-of-way line of San Marin Drive South 7°38'00" West 1365.00 feet to the northwest corner of Parcel B of a division of land recorded in Book 4 of Parcel Maps at Page 29, Marin County Records; thence South 73°52'00" East 2246.22 feet to the westerly corner of that parcel of land granted to Joseph F. Simontacchi and Shirley E. Simontacchi, his wife, by deed recorded in Book 1906 at Page 585, Marin County Records; thence North 14°03'00" East 109.00 feet; thence North 38°53'00" East 43.00 feet; thence North 46°58'00" East 45.50 feet; thence North 82°48'00" East 161.20 feet; thence North 89°27'00" East 112.50 feet to the westerly right-of-way line of Redwood Boulevard; thence along the arc of a curve to the right having a radius of 4874.00 feet, through a central angle of 3°53'04", an arc distance of 330.44 feet; thence South 44°46'00" West 172.17 feet; thence South 14°12'00" West 144.55 feet; thence South 18°03'00" East 164.74 feet; thence South 16°42'00" West 679.44 feet; thence leaving said westerly right-of-way line of Redwood Boulevard North 73°52'00" West 1295.60 feet; thence North 14°17'00" East 286.40 feet; thence North 73°52'00" West 457.72 feet; thence North 7°46'00" East 660.67 feet; thence North 73°52'00" West 696.84 feet; thence South 7°38'00" West 950.00 feet; thence South 58°21'00" West 535.85 feet to the point of beginning.

Said parcel containing 97.5 acres more or less.

CORPORATED

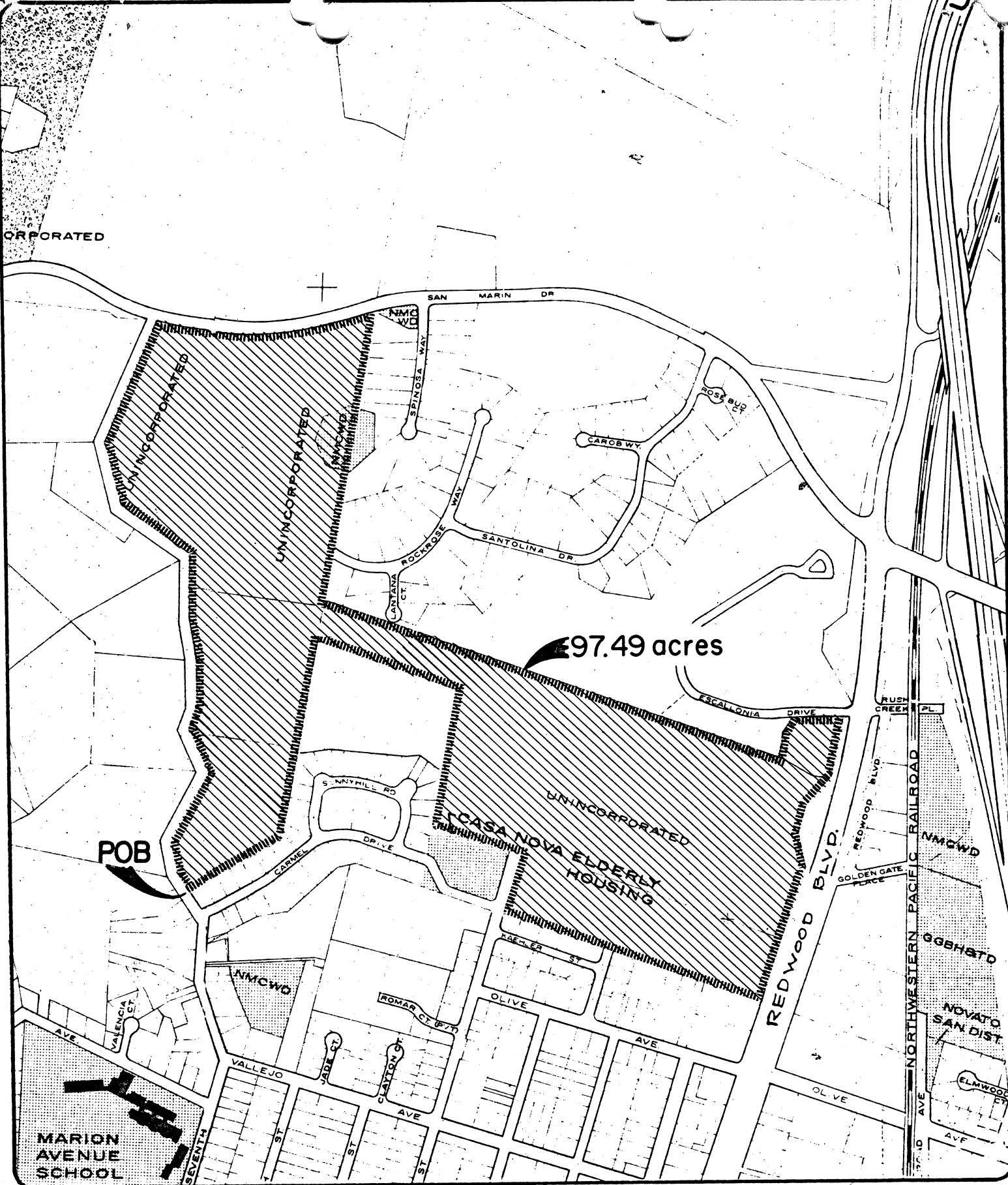

97.49 acres

POB

CASA NOVA ELDERLY HOUSING

MARION AVENUE SCHOOL

NOVATO PLANNING DEPARTMENT	
REDWOOD BOULEVARD - SEVENTH STREET	scale: 1" = 600 FT.
ISLAND ANNEXATION	date: JUNE 1970

 NORTH
no. 104 A

EXHIBIT "A"

Legal Description

"Redwood Boulevard - Seventh Street
Island Annexation"

Beginning at the northwest corner of Lot 1 per "Map of M & S Seventh Street Subdivision" recorded in Book 9 of Maps at Page 22, Marin County Records, said corner being on the Novato City Limits Line; thence along said City Limits Line, North 35°40'00" West 80.00 feet; thence North 13°16'00" West 156.90 feet; thence North 25°27'00" East 375.90 feet; thence North 25°41'00" West 233.00 feet; thence North 17°14'00" East 81.70 feet; thence North 1°03'00" West 247.20 feet; thence North 9°49'00" West 180.70 feet; thence 00°34'00" West 156.50 feet; thence North 5°57'00" West 169.10 feet; thence North 47°58'00" West 399.10 feet; thence North 7°41'00" West 317.40 feet; thence North 20°51'00" East 639.80 feet to the southerly right-of-way line of San Marin Drive; thence along said right-of-way line South 81°28'00" East 403.10 feet; thence North 87°11'00" East 292.10 feet; thence North 72°57'00" East 374.30 feet; thence leaving the southerly right-of-way line of San Marin Drive South 7°38'00" West 1365.00 feet to the northwest corner of Parcel B of a division of land recorded in Book 4 of Parcel Maps at Page 29, Marin County Records; thence South 73°52'00" East 2246.22 feet to the westerly corner of that parcel of land granted to Joseph F. Simontacchi and Shirley E. Simontacchi, his wife, by deed recorded in Book 1906 at Page 585, Marin County Records; thence North 14°03'00" East 109.00 feet; thence North 38°53'00" East 43.00 feet; thence North 46°58'00" East 45.50 feet; thence North 82°48'00" East 161.20 feet; thence North 89°27'00" East 112.50 feet to the westerly right-of-way line of Redwood Boulevard; thence along the arc of a curve to the right having a radius of 4874.00 feet, through a central angle of 3°53'04", an arc distance of 330.44 feet; thence South 44°46'00" West 172.17 feet; thence South 14°12'00" West 144.55 feet; thence South 18°03'00" East 164.74 feet; thence South 16°42'00" West 679.44 feet; thence leaving said westerly right-of-way line of Redwood Boulevard North 73°52'00" West 1295.60 feet; thence North 14°17'00" East 286.40 feet; thence North 73°52'00" West 457.72 feet; thence North 7°46'00" East 660.67 feet; thence North 73°52'00" West 696.84 feet; thence South 7°38'00" West 950.00 feet; thence South 58°21'00" West 535.85 feet to the point of beginning.

Said parcel containing 97.5 acres more or less.