

LOCAL AGENCY FORMATION COMMISSION OF MARIN COUNTY

RESOLUTION NO. 74-31

RESOLUTION MAKING DETERMINATIONS AND APPROVING THE ANNEXATION OF
TERRITORY DESIGNATED AS LEESE LANE ANNEXATION 1974-6
TO SANITARY DISTRICT NO. 6

WHEREAS, a proposal for the annexation of certain territory to Sanitary District No. 6 in the County of Marin, has been filed with the Executive Officer of this Commission; and

WHEREAS, said proposal was made in the form of Resolution No. 1462, a resolution of application adopted by the Board of Directors of Sanitary District No. 6, and requesting the initiation of annexation proceedings pursuant to the District Regorganization Act of 1965, Division 1 (commencing with Section 56000) of Title 6 of the Government Code; and

WHEREAS, said resolution of application was accompanied by written consent signed by all owners of land within the territory proposed to be annexed; and

WHEREAS, pursuant to Government Code Section 56261, when a resolution of application is accompanied by written consent of all owners of land within the territory proposed to be annexed, this Commission may make determinations with respect to said application without notice and hearing,

NOW, THEREFORE, the Local Agency Formation Commission of the County of Marin, DOES HEREBY RESOLVE, DETERMINE AND ORDER as follows:

1. Subject to the terms and conditions hereinafter specified the proposal made by Resolution No. 1462 adopted by the Board of Directors of Sanitary District No. 6 is approved.

2. The boundaries of the territory proposed to be annexed shall be those set forth in the proposal filed with this Commission; and said territory shall be designated as Leese Lane Annexation 1974-6 and is found to be uninhabited.

3. Any resolution ordering the annexation approved by this resolution shall provide that such annexation is ordered subject to terms and conditions specified in the resolution of application.

4. Sanitary District No. 6 is designated as the conducting district for further proceedings; and the Board of Directors of said district is hereby directed to initiate proceedings in compliance with this resolution, and is authorized to proceed without notice or hearing pursuant to Government Code Section 56261.

5. The Executive Officer is hereby authorized and directed to mail certified copies of this resolution in the manner and as described in Section 56272 of the Government Code.

PASSED AND ADOPTED by the Marin County Local Agency Formation Commission on this 17th day of July, 1974, by the following vote:

AYES: Commissioners Baptiste, Jones, Mulryan and Marchant

NOES: None

ABSENT: Commissioner Giacomini

ABSTAIN:

ATTEST:

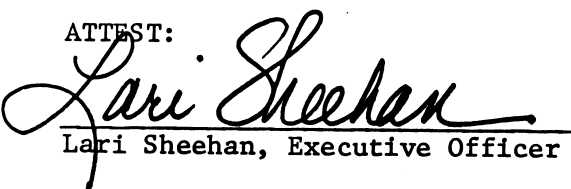
Lari Sheehan, Executive Officer

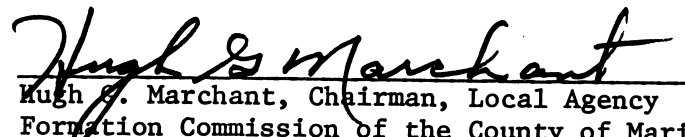
Hugh S. Marchant, Chairman, Local Agency
Formation Commission of the County of Marin

SANITARY DISTRICT NO. 6 OF MARIN COUNTY

LEESE LANE ANNEXATION 1974-6

EXHIBIT "A"

Beginning at a point on the existing boundary of Sanitary District No. 6 of Marin County, said point being on the southwesterly line of Leese Lane at its intersection with the northwesterly line of Lot 47 as said Lane and Lot are shown upon that certain map entitled "Subdivision Two, Sweetser Ranch, Novato, California", filed November 14, 1913 in Liber 4 of Maps at page 59, Marin County Records; running thence along said southwesterly line of Leese Lane and along said Sanitary District boundary South $60^{\circ} 49'$ East 120.8 feet; thence leaving said southwesterly line of Leese Lane and continuing along said Sanitary District boundary South $14^{\circ} 50'$ West 47.15 feet; thence South $7^{\circ} 34'$ East 32.55 feet; thence South $16^{\circ} 36'$ East 139.60 feet; thence South $1^{\circ} 15'$ East 98.35 feet; thence South $3^{\circ} 43' 15''$ West 105.25 feet (called South $4^{\circ} 45'$ West 99.54 feet on previous annexation); thence leaving said Sanitary District boundary South $4^{\circ} 45'$ West 91.66 feet; thence South $82^{\circ} 23'$ West 63.5 feet; thence South $65^{\circ} 15'$ West 71.9 feet; thence South $11^{\circ} 29'$ West 36.76 feet to a point on said Sanitary District boundary; thence running along said Sanitary District boundary North $60^{\circ} 49''$ West 301.07 feet to a point on said northwesterly line of Lot 47; thence running along said northwesterly line and continuing along said Sanitary District boundary North $29^{\circ} 11'$ East 561 feet to the point of beginning.

For the
D
L
K
S

Faint, illegible text, possibly bleed-through from the reverse side of the page.



1942

THESE THINGS ARE NOT TO BE

REPRODUCED OR TRANSMITTED IN ANY FORM OR BY ANY MEANS

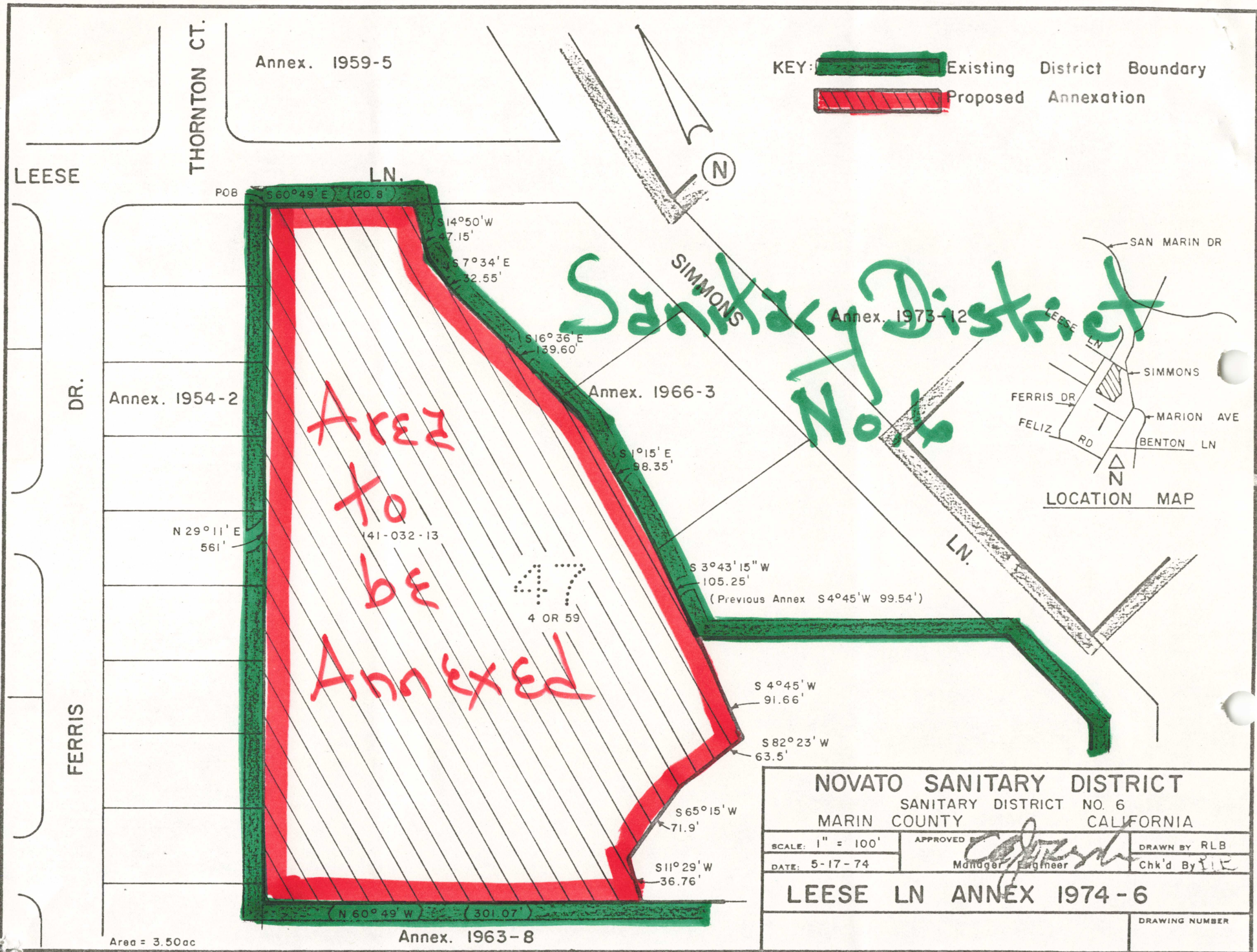

KEY: Existing District Boundary
 Proposed Annexation

Sanitary District No. 6

Area to be Annexed

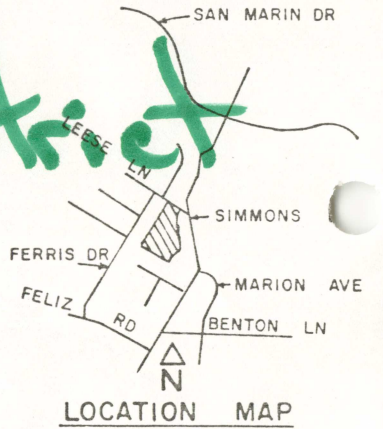

NOVATO SANITARY DISTRICT		
SANITARY DISTRICT NO. 6		
MARIN COUNTY CALIFORNIA		
SCALE: 1" = 100'	APPROVED: <i>[Signature]</i>	DRAWN BY RLB
DATE: 5-17-74	Manager Engineer	Chk'd By RLB
LEESE LN ANNEX 1974-6		
		DRAWING NUMBER

Area = 3.50ac

Annex. 1963-8

