

LOCAL AGENCY FORMATION COMMISSION OF THE COUNTY OF MARIN

RESOLUTION NO. 69-32

RESOLUTION APPROVING THE ANNEXATION OF TERRITORY TO  
SANITARY DISTRICT NO. 6

FOURTH STREET ANNEX. 1969-11

WHEREAS, a resolution of application No. 1089 has been filed by  
Sanitary District No. 6, together with evidence of written  
consent of all owners of property within the proposed annexation; and

WHEREAS, the Commission has found the territory to be annexed to be  
uninhabited; and

WHEREAS, the Sanitary District No. 6  
has not requested the Commission to hold a noticed public hearing in accordance  
with Government Code Section 56261.

NOW, THEREFORE, BE IT RESOLVED by the Marin County Local Agency Forma-  
tion Commission, in accordance with the District Reorganization Act of 1965, that  
it does hereby approve the annexation of territory known as Fourth Street  
Annex. 1969-11 to Sanitary District No. 6  
with the following determinations:

1. Sanitary District No. 6 shall  
be the conducting District for further proceedings to annex this territory and  
the Board of Directors of that District is directed to initiate annexation pro-  
ceedings in compliance with this resolution and the resolution of application.  
Such proceedings may be without notice, without hearing, and without election.

2. The territory proposed for annexation shall be designated as  
Fourth Street Annex. 1969-11.

PASSED AND ADOPTED by the Marin County Local Agency Formation Commission  
on this 14th day of August, 1969 by the following vote:

AYES: Commissioners Dyk, Arrigoni, Wornum, Marchant

NOES: None

ABSENT: Commissioner Womack

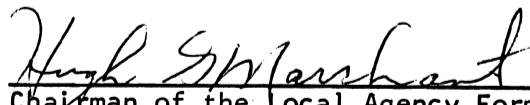
  
Chairman of the Local Agency Formation  
Commission of the County of Marin

ATTEST:

  
Executive Officer

SANITARY DISTRICT NO. 6 OF MARIN COUNTY

FOURTH ST. ANNEX 1969-11



EXHIBIT "A"

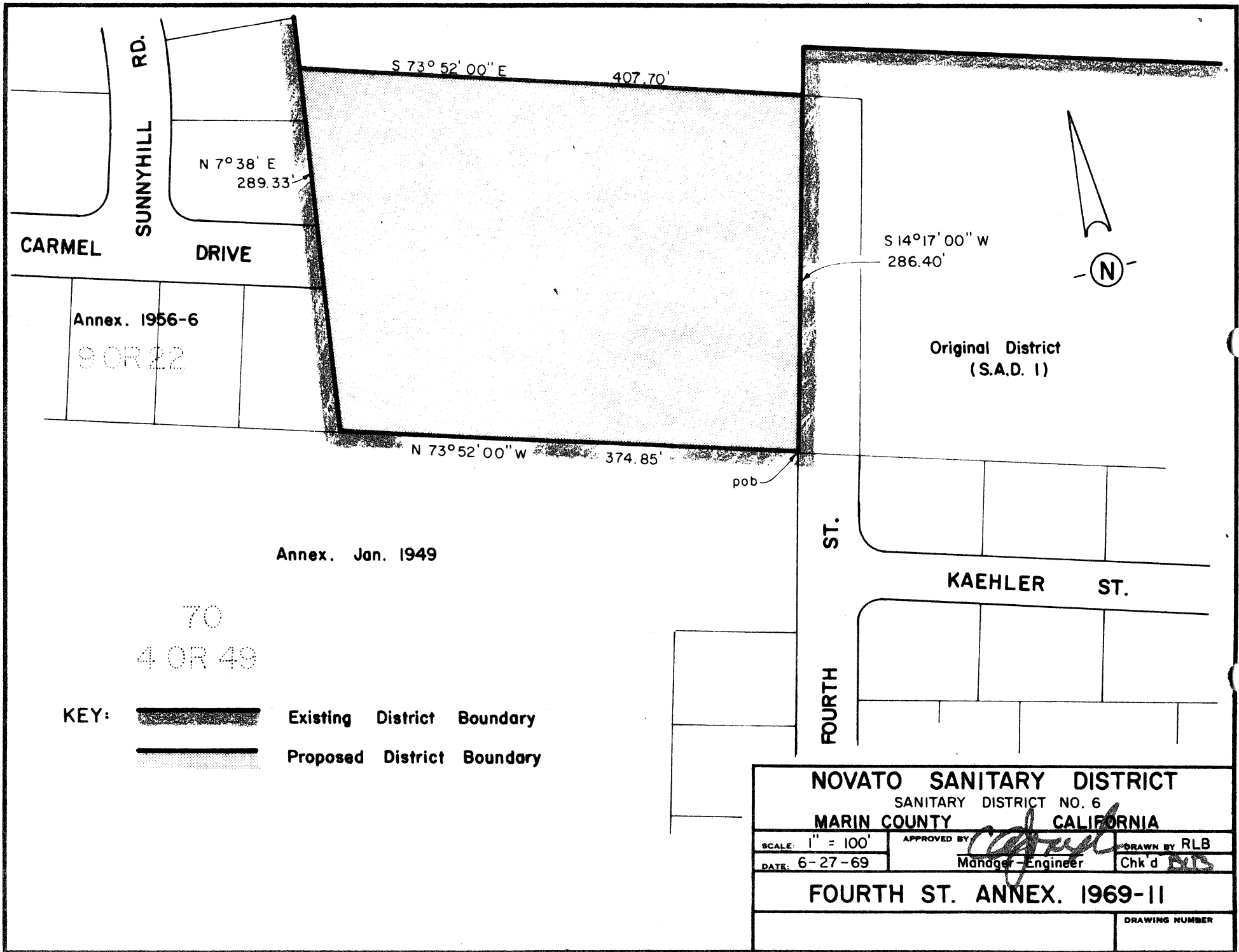

Beginning at a point on the existing boundary of Sanitary District No. 6 of Marin County, said point being on the Westerly line of Fourth St. at its intersection with the Northerly line of Lot 70 as said Street and Lot are shown upon that certain map entitled, "Subdivision One, Sweetser Ranch, Novato, California", filed July 15, 1913 in Liber 4 of Maps at Page 49, Marin County Records; running thence from said point of beginning along said Sanitary District boundary and along said Northerly line of Lot 70 North  $73^{\circ} 52' 00''$  West 374.85 feet to the most Southeasterly corner of that certain map entitled, "Map of M & S Seventh Street Subdivision, Novato, California", filed April 9, 1956 in Volume 9 of Maps at Page 22, Marin County Records; thence leaving said Northerly line of Lot 70 and running along the Easterly boundary of the last map hereinabove mentioned (9 O.R. 22) North  $7^{\circ} 38'$  East 289.33 feet, thence leaving said Sanitary District boundary and said Easterly boundary (9 O.R. 22) South  $73^{\circ} 52' 00''$  East 407.70 feet to a point on said Sanitary District boundary; thence along said Sanitary District boundary South  $14^{\circ} 17' 00''$  West 286.40 feet to the point of beginning.



Annex. Jan. 1949

70  
4 OR 49

KEY:  Existing District Boundary  
 Proposed District Boundary

<b>NOVATO SANITARY DISTRICT</b>		
SANITARY DISTRICT NO. 6		
MARIN COUNTY		CALIFORNIA
SCALE: 1" = 100'	APPROVED BY 	DRAWN BY RLB
DATE: 6-27-69	Manager-Engineer	Chk'd 
<b>FOURTH ST. ANNEX. 1969-11</b>		
		DRAWING NUMBER