





SANITARY DISTRICT NO. 6 OF MARIN COUNTY

MARION AVENUE ANNEX 1970-4

EXHIBIT "A"

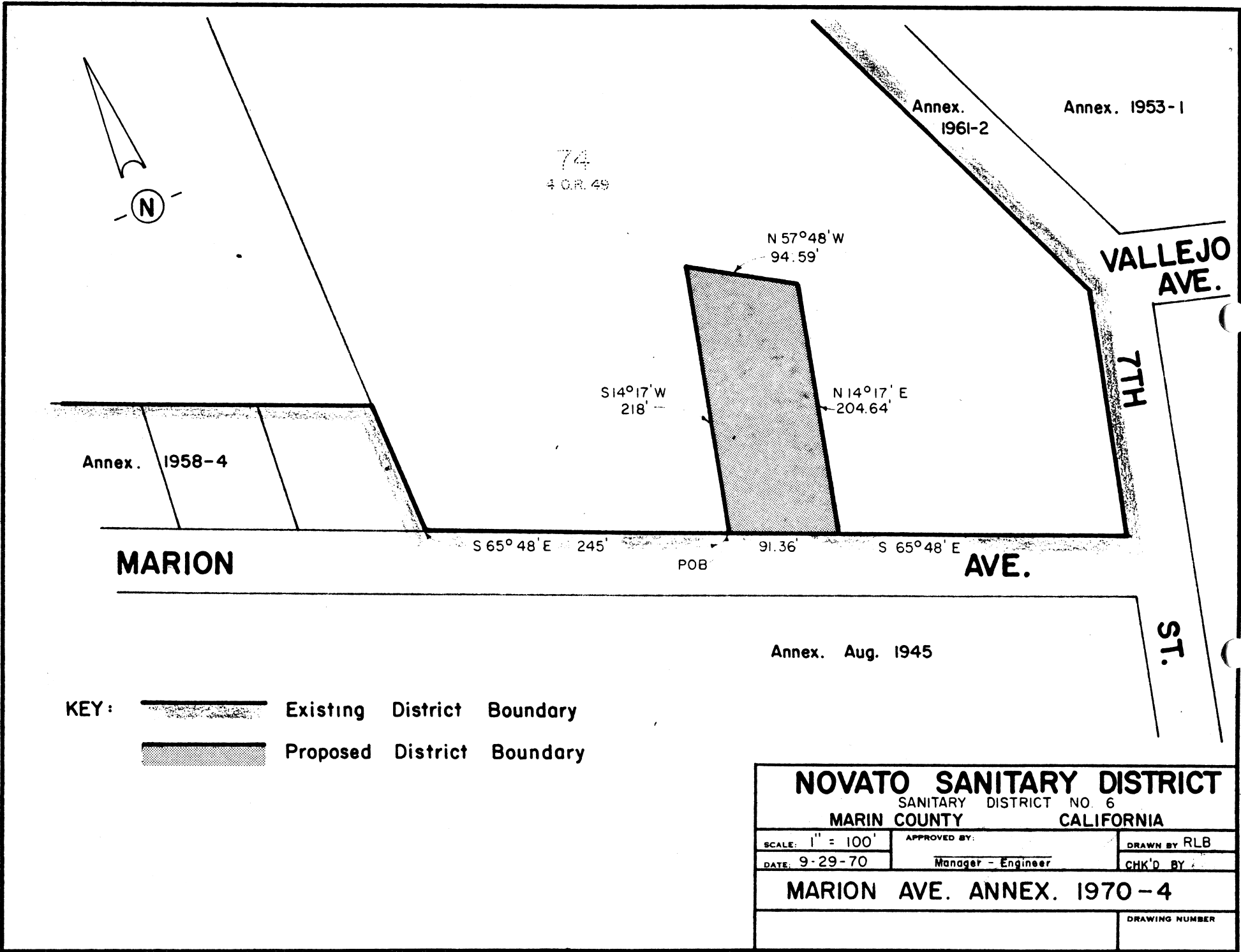
BEGINNING at a point on the existing boundary of Sanitary District No. 6 of Marin County, said point being on the northerly line of Marion Avenue, distant thereon South 65° 48' East 245 feet from the intersection of the westerly line of Lot 74 with said northerly line of Marion Avenue, as said Lot and Avenue are shown upon that certain map entitled "Subdivision One, Sweetser Ranch, Novato, California", filed July 15, 1913 in Liber 4 of Maps at Page 49, Marin County Records; running thence from said point of beginning along said Marion Avenue and along said Sanitary District boundary South 65° 48' East 91.36 feet; thence leaving said northerly line of Marion Avenue and said Sanitary District boundary North 14° 17' East 204.64 feet; thence North 57° 48' West 94.59 feet; thence South 14° 17' West 218 feet to the point of beginning.



KEY:  Existing District Boundary  
 Proposed District Boundary

<b>NOVATO SANITARY DISTRICT</b>		
SANITARY DISTRICT NO. 6		
MARIN COUNTY		CALIFORNIA
SCALE: 1" = 100'	APPROVED BY:	DRAWN BY RLB
DATE: 9-29-70	Manager - Engineer	CHK'D BY
<b>MARION AVE. ANNEX. 1970-4</b>		
		DRAWING NUMBER