

LOCAL AGENCY FORMATION COMMISSION OF THE COUNTY OF MARIN

RESOLUTION NO. 66-23

RESOLUTION APPROVING THE ANNEXATION OF TERRITORY TO
SANITARY DISTRICT NO. 6
JACKSON ANNEXATION (1966-8)

WHEREAS, a resolution of application has been filed, together with evidence of written consent of all owners of property within the proposed annexation; and

WHEREAS, the Commission has found the territory to be annexed to be uninhabited; and

WHEREAS, the Sanitary District No. 6
has not requested the Commission to hold a noticed public hearing in accordance with Government Code Section 56261.

NOW, THEREFORE, BE IT RESOLVED by the Marin County Local Agency Formation Commission, in accordance with the District Reorganization Act of 1965, that it does hereby approve the annexation of territory known as Jackson Annexation (1966-8) to Sanitary District No. 6 with the following determinations:

1. Sanitary District No. 6
shall be the conducting District for further proceedings to annex this territory and the Board of Directors of that District is directed to initiate annexation proceedings in compliance with this resolution. Such proceedings may be without notice of hearing and without election.

2. The territory proposed for annexation shall be designated as Jackson Annexation (1966-8).

PASSED AND ADOPTED by the Marin County Local Agency Formation Commission on this 4th day of August, 1966 by the following vote:

Ayes: Commissioners Jan Paul Dyk, H. G. Marchant and J. Wayne Womack.

Noes: None.

Absent: Commissioners Peter H. Behr and Byron W. Leydecker.

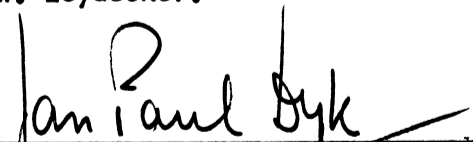
CHAIRMAN OF THE LOCAL AGENCY FORMATION
COMMISSION OF THE COUNTY OF MARIN

ATTEST:

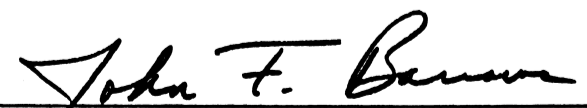

EXECUTIVE OFFICER

SANITARY DISTRICT NO. 6 OF MARIN COUNTY

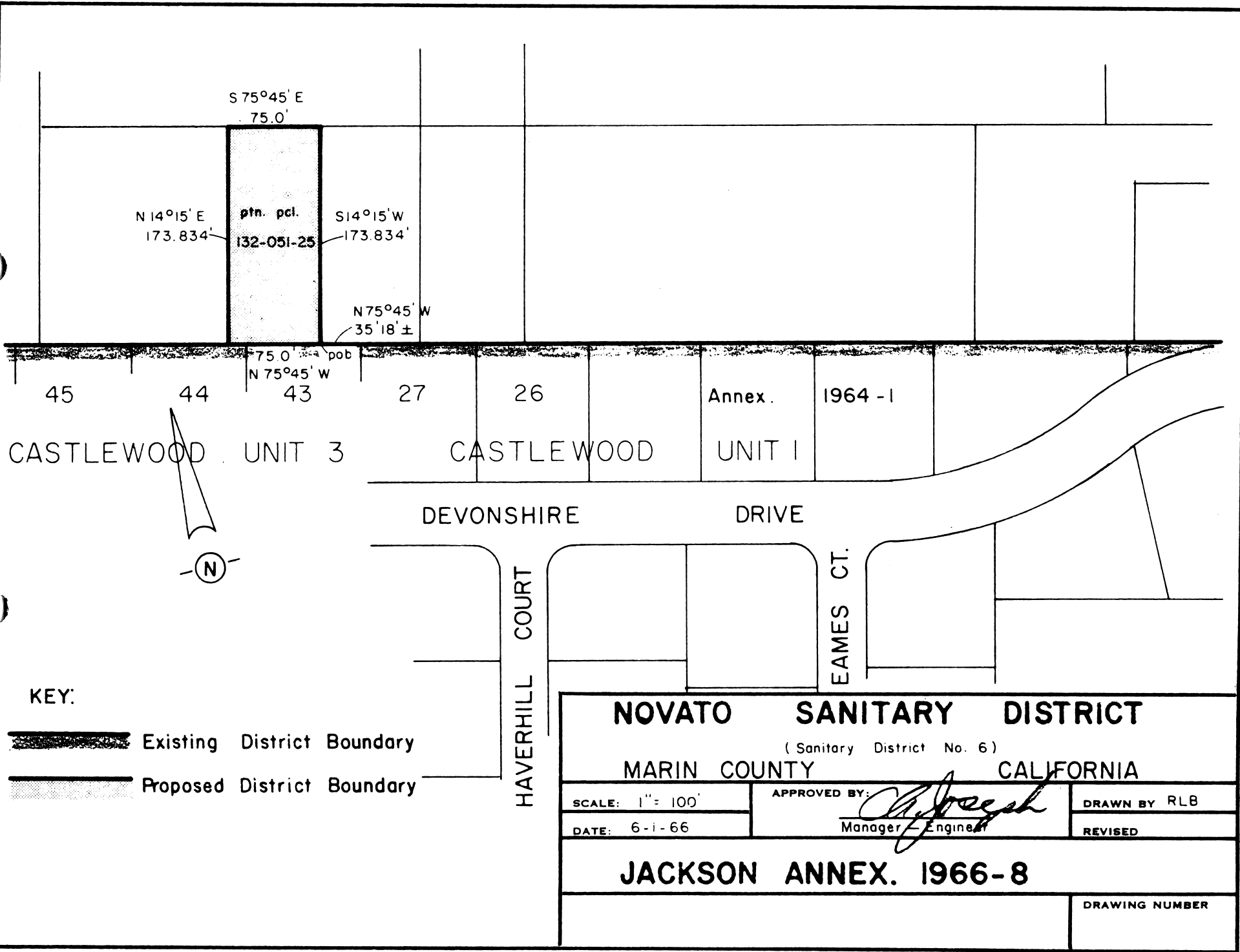

JACKSON ANNEX 1966-8

EXHIBIT "A"

BEGINNING at a point on the existing boundary of Sanitary District No. 6 of Marin County, said point being the most Southerly corner of that certain parcel described in the instrument from Dewayne Grace Smith to Cliff Jackson, et ux, recorded June 22, 1962 in Book 1583 at Page 229, Marin County Records, said point also being distant North 75° 45' West 35.18 feet, more or less, from the most Easterly corner of Lot 43, as shown on that certain map entitled, "Map of Castlewood Unit 3", filed September 7, 1965 in Volume 13 of Maps at Page 38, Marin County Records; running thence from said point of beginning along said Sanitary District boundary North 75° 45' West 75.0 feet; thence leaving said Sanitary District boundary North 14° 15' East 173.834 feet; thence South 75° 45' East 75.0 feet; thence South 14° 15' West 173.834 feet to the point of beginning.

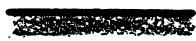

KEY:

-  Existing District Boundary
-  Proposed District Boundary

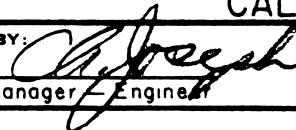
NOVATO SANITARY DISTRICT		
(Sanitary District No. 6)		
MARIN COUNTY		CALIFORNIA
SCALE: 1" = 100'	APPROVED BY: 	DRAWN BY: RLB
DATE: 6-1-66	Manager - Engineer	REVISED
JACKSON ANNEX. 1966-8		
		DRAWING NUMBER