

LOCAL AGENCY FORMATION COMMISSION OF MARIN COUNTY

RESOLUTION NO. 85-3

RESOLUTION MAKING DETERMINATIONS AND APPROVING ANNEXATION
WITH WAIVER OF NOTICE, HEARING AND ELECTION
TO THE NOVATO SANITARY DISTRICT

"DIABLO AVENUE ANNEXATION 1984-10"

WHEREAS, a proposal for the annexation of certain territory to the Novato Sanitary District in the County of Marin has been filed with the Executive Officer of this Commission; and

WHEREAS, said proposal was made in the form of Resolution No. 2102, a resolution of application adopted by the Board of Directors of the Novato Sanitary District, and requesting the initiation of annexation proceedings pursuant to the District Reorganization Act of 1965, Division 1, (commencing with Section 56000) of Title 6 of the Government Code; and

WHEREAS, said resolution of application was accompanied by written consent signed by all owners of land within the territory proposed to be annexed; and

WHEREAS, pursuant to Government Code Section 56261, when a resolution of application is accompanied by written consent of all owners of land within the territory proposed to be annexed, this Commission may make determinations with respect to said annexation without notice and hearing.

NOW, THEREFORE, the Local Agency Formation Commission of the County of Marin DOES HEREBY RESOLVE, DETERMINE AND ORDER as follows:

Section 1. Subject to the terms and conditions hereinafter specified, the proposal made by Resolution No. 2102, adopted by the Board of Directors of the Novato Sanitary District, is approved.

Section 2. The boundaries of the territory proposed to be annexed shall be those set forth in Exhibit A, attached hereto and incorporated herein; and said territory shall be designated as the "Diablo Avenue Annexation 1984-10."

Section 3. Said territory is found to be uninhabited.

Section 4. Any resolution ordering the annexation approved by this resolution shall provide that such annexation is ordered subject to the terms and conditions of Novato Sanitary District as set forth in Exhibit B, attached hereto and incorporated herein.

Section 5. The Novato Sanitary District is designated as the conducting district for further proceedings, and the Board of Directors of said

"Diablo Avenue Annexation 1984-10" Resolution No. 85-3

District is hereby directed to initiate proceedings in compliance with this resolution and is authorized to proceed without notice, hearing, or election, pursuant to Government Code Section 56261.

Section 6. In accordance with applicable provisions contained in the adopted Marin Local Agency Formation Commission Environmental Guidelines and Procedures, the City of Novato is the appropriate lead agency, has conducted an Initial Study incorporating concerns of said Commission, a responsible agency, and has issued a Negative Declaration. The Marin Local Agency Formation Commission hereby certifies that the Commission has considered said documents.

Section 7. The Executive Officer is hereby authorized and directed to mail certified copies of the resolution in the manner prescribed by Section 56272 of the Government Code.

PASSED AND ADOPTED by the Marin County Local Agency Formation Commission on this 14th day of February 1985 by the following vote:

AYES: Commissioners Boessenecker, Breiner, Giacomini, Stockwell and McCart.

NOES: None

ABSENT: None



MARTHA McCART, Chairman
Marin Local Agency Formation Commission

ATTEST:

WARREN K. NELSON, Executive Officer

DATED: February 15, 1985

85018836

November 5, 1984

NOVATO SANITARY DISTRICT
DIABLO AVE. ANNEX 1984-10
Exhibit "A"

Beginning at a point on the existing boundary of Novato Sanitary District, said point being on the easterly line of Diablo Ave. at its intersection with the northerly line of Lot 97, as said Avenue and Lot are shown upon that certain map entitled "Map of Subdivisions 'A' and 'B' of the Novato Ranch, Marin County, Calif.", filed November 18, 1909 in Book 3 of Maps at Page 36, Marin County Records; running thence along said northerly line and along said Sanitary District boundary Southeasterly to the most easterly corner of said Lot; thence continuing along said Sanitary District boundary and running along the easterly line of said Lot Southwesterly to the centerline of the Drainage Ditch (Warner Creek) as said Ditch is shown on said Map (3 O.R. 36); thence leaving said easterly line of Lot 97 and running along said Drainage Ditch Northwesterly to its intersection with said easterly line of Diablo Ave.; running thence along said easterly line North-easterly to the point of beginning.

Containing 1.16 acres, more or less.

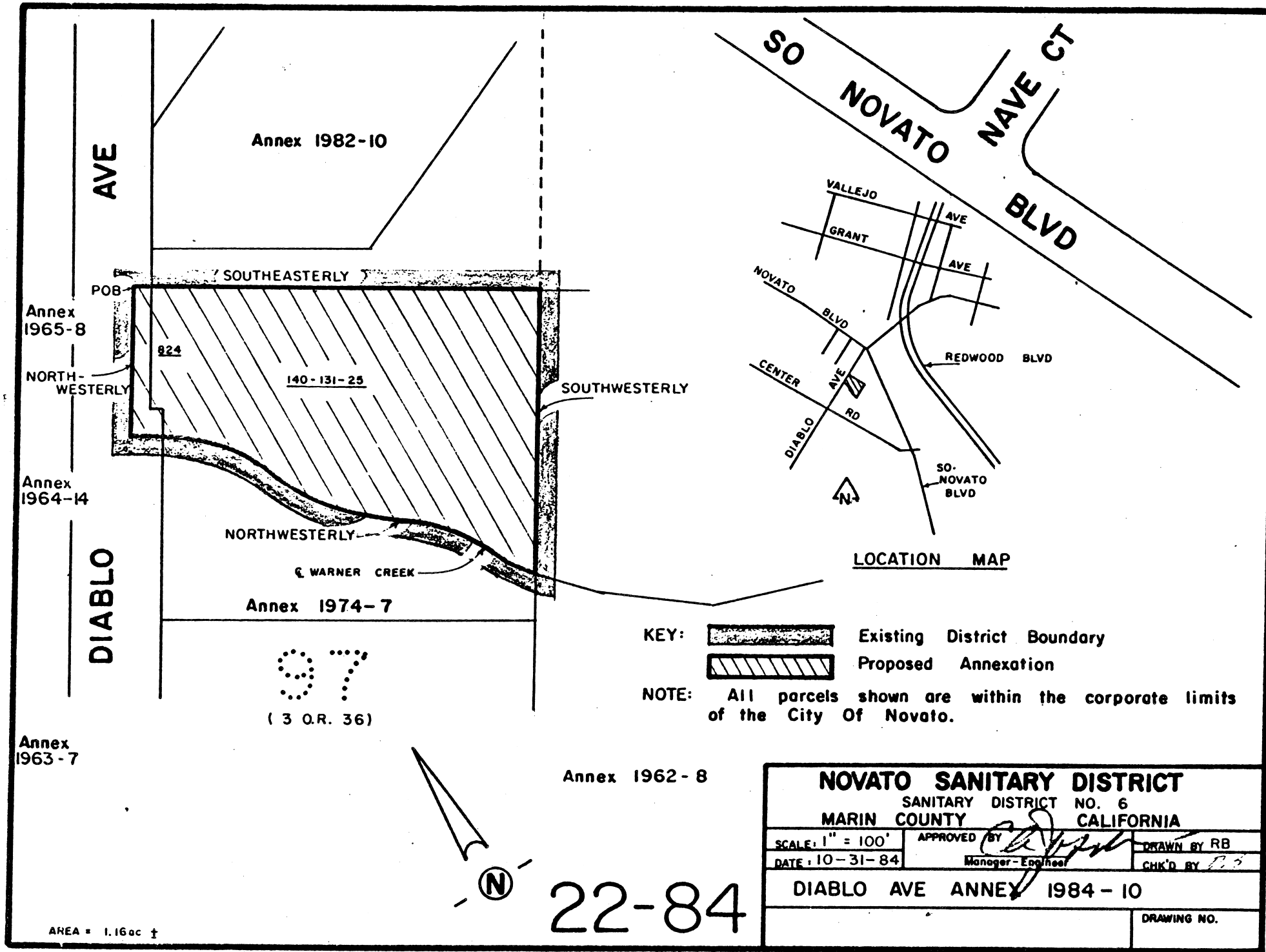

Annex 1965-8

NORTH-WESTERLY

Annex 1964-14

DIABLO AVE

Annex 1982-10

SOUTHEASTERLY

824

140-131-25

SOUTHWESTERLY

NORTHWESTERLY

WARNER CREEK

Annex 1974-7

97
(3 O.R. 36)

Annex 1962-8

KEY: Existing District Boundary
 Proposed Annexation

NOTE: All parcels shown are within the corporate limits of the City Of Novato.

LOCATION MAP

NOVATO SANITARY DISTRICT		
SANITARY DISTRICT NO. 6		
MARIN COUNTY CALIFORNIA		
SCALE: 1" = 100'	APPROVED BY	DRAWN BY RB
DATE: 10-31-84	Manager-Engineer	CHK'D BY RB
DIABLO AVE ANNEY 1984-10		
		DRAWING NO.

22-84

AREA = 1.16 ac ±

85018836