

LOCAL AGENCY FORMATION COMMISSION OF THE COUNTY OF MARIN

RESOLUTION NO. 72-55

RESOLUTION APPROVING THE ANNEXATION OF TERRITORY TO  
SANITARY DISTRICT NO. 6

SIMMONS LANE ANNEXATION 1972-14

WHEREAS, a resolution of application No. 1340 has been filed by Sanitary District No. 6, together with evidence of written consent to all owners of property within the proposed annexation; and

WHEREAS, the Commission has found the territory to be annexed to be uninhabited; and

WHEREAS, the Sanitary District No. 6 has not requested the Commission to hold a noticed public hearing in accordance with Government Code Section 56261.

NOW, THEREFORE, BE IT RESOLVED by the Marin County Local Agency Formation Commission, in accordance with the District Reorganization Act of 1965, that it does hereby approve the annexation of territory known as Simmons Lane Annexation 1972-14 to the Sanitary District No. 6 with the following determination:

1. Sanitary District No. 6 shall be the conducting District for further proceedings to annex this territory and the Board of Directors of that District is directed to initiate annexation proceedings in compliance with this resolution and the resolution of application. Such proceedings may be without notice, without hearing, and without election.

2. The territory proposed for annexation shall be designated as Simmons Lane Annexation 1972-14.

PASSED AND ADOPTED by the Marin County Local Agency Formation Commission on this 13th day of December, 1972, by the following vote:

AYES: Commissioners Baptiste, Baar, Jones, Marchant

NOES: None

ABSENT: Commissioner Mulryan

ATTEST

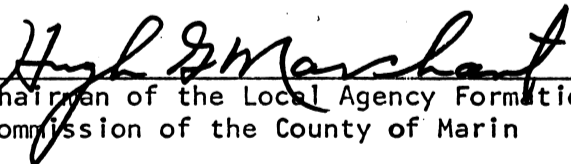
  
Chairman of the Local Agency Formation  
Commission of the County of Marin

  
Executive Officer

SANITARY DISTRICT NO. 6 OF MARIN COUNTY



SIMMONS LANE ANNEXATION 1972-14

EXHIBIT "A"

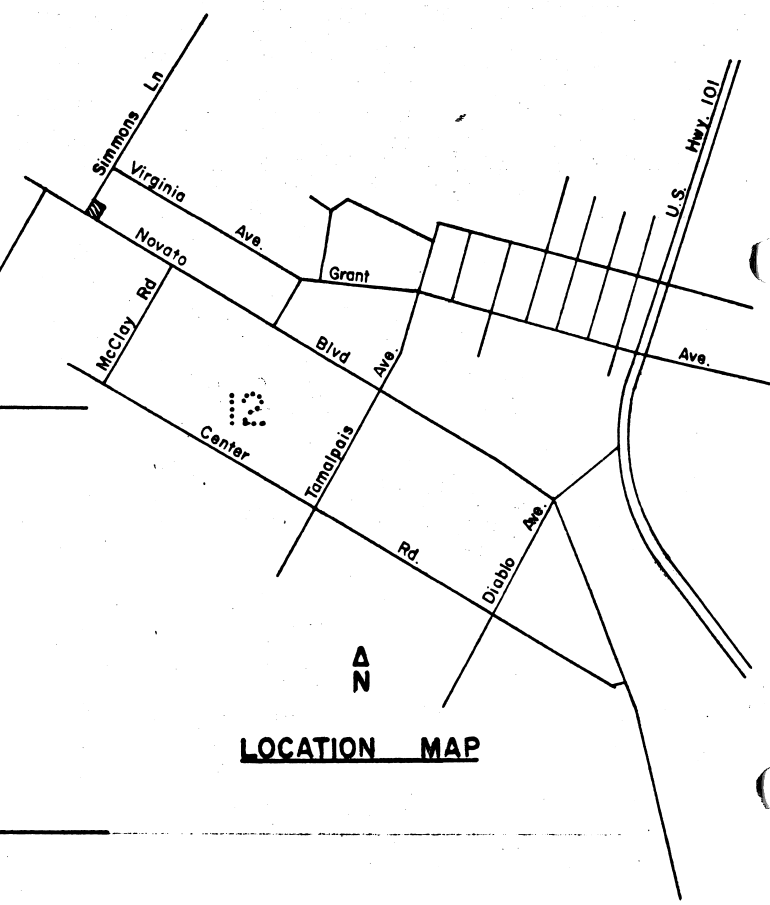
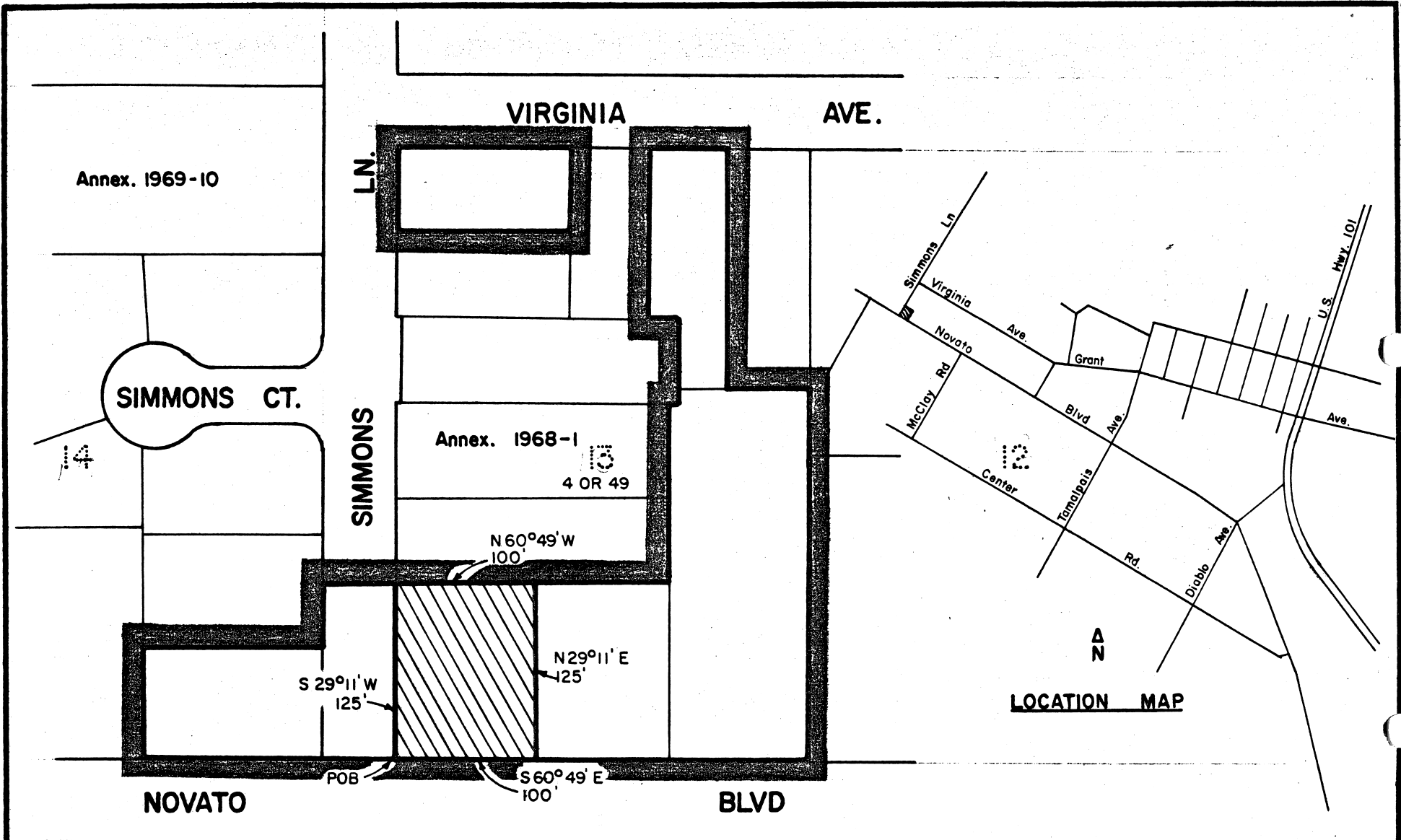

BEGINNING at a point on the existing boundary of Sanitary District No. 6 of Marin County, said point being at the intersection of the southeasterly line of Simmons Lane with the northeasterly line of Novato Boulevard (Formerly DeLong Avenue) as said Lane and Avenue are shown upon that certain map entitled "Subdivision One, Sweetser Ranch, Novato, California", filed July 15, 1913 in Liber 4 of Maps at page 49, Marin County Records; running thence from said point of beginning along said Sanitary District boundary and along said Novato Boulevard South  $60^{\circ} 49'$  East 100 ft; thence leaving said Sanitary District boundary and said northeasterly line of Novato Boulevard North  $29^{\circ} 11'$  East 125 feet to a point on said Sanitary District boundary; thence running along said Sanitary District boundary North  $60^{\circ} 49'$  West 100 feet to a point on said southeasterly line of Simmons Lane; thence leaving said Sanitary District boundary and running along said southeasterly line of Simmons Lane South  $29^{\circ} 11'$  West 125 feet to the point of beginning.

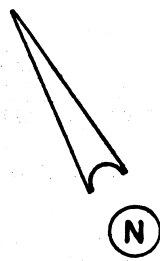

Annex. 1964-22

KEY:  Existing District Boundary  
 Proposed District Boundary



<b>NOVATO SANITARY DISTRICT</b>		
SANITARY DISTRICT NO. 6 MARIN COUNTY CALIFORNIA		
SCALE: 1" = 100'	APPROVED BY: 	DRAWN BY: RLB
DATE: 11-8-72	Manager/Engineer	CHK'D BY: 
<b>SIMMONS LN. ANNEX. 1972-14</b>		
		DRAWING NUMBER