

LOCAL AGENCY FORMATION COMMISSION OF MARIN COUNTY

RESOLUTION 84-10

RESOLUTION MAKING DETERMINATIONS AND APPROVING ANNEXATION  
WITH WAIVER OF NOTICE, HEARING AND ELECTION  
TO SANITARY DISTRICT NO. 2 (CORTE MADERA)

PARADISE DRIVE/ROBIN DRIVE ANNEXATION

WHEREAS, a proposal for the annexation of certain territory to Sanitary District No. 2 (Corte Madera) in the County Marin has been filed with the Executive Officer of this Commission; and

WHEREAS, said proposal was made in the form of a petition filed by James Grayson, representing the Independent Learning School, and Nicholas Cox requesting the initiation of annexation proceedings pursuant to the District Reorganization Act of 1965, Division 1, (commencing with Section 56000) of Title 6 of the Government Code; and

WHEREAS, following review of the proposal and its boundary configuration, the Executive Officer determined that the boundary should be amended so as to include two additional parcels (AP Nos. 26-241-19 and 26-231-48); and

WHEREAS, notice of a LAFCo public hearing was provided in accordance with the law; and

WHEREAS, on September 6, 1984, said Commission conducted a public hearing affording all persons an opportunity to speak and be heard on the proposal and the recommended boundary amendment; and

WHEREAS, said amended proposal received written consent signed by all owners of land within the territory proposed to be annexed; and

WHEREAS, pursuant to Government Code Section 56261, when a resolution of application is accompanied by written consent of all owners of land within the territory proposed to be annexed, this Commission may authorize the conducting district to order annexation without notice and hearing.

NOW, THEREFORE, the Local Agency Formation Commission of the County of Marin DOES HEREBY RESOLVE, DETERMINE AND ORDER as follows:

Section 1. Subject to the terms and conditions hereinafter specified, the amended proposal is approved.

Section 2. The boundaries of the territory proposed to be annexed shall be those set forth in Exhibit A, attached hereto and incorporated herein; and said territory shall be designated as the "Paradise Drive/Robin Drive Annexation."

Section 3. Said territory is found to be uninhabited.

Section 4. The Sanitary District No. 2 is designated as the conducting district for further proceedings, and the Board of Directors of said District is hereby directed to initiate proceedings in compliance with this resolution and is authorized to proceed without notice, hearing or election, pursuant to Government Code Section 56261.

Section 5. The project is Categorically Exempt, pursuant to authorization specified in Section 15319 of the Public Resources Code.

Section 6. The Executive Officer is hereby authorized and directed to mail certified copies of the resolution in the manner prescribed by Section 56272 of the Government Code.

PASSED AND ADOPTED by the Marin County Local Agency Formation Commission on this 6th day of September 1984 by the following vote:

AYES: Commissioners Boessenecker, Breiner, Stockwell and McCart

NOES: None

ABSENT: Commissioner Giacomini



MARTHA McCART, Chairman  
Marin Local Agency Formation Commission

ATTEST:



WARREN K. NELSON, Executive Officer

DATED: September 7, 1984

Exhitit A

December 1984

PARADISE DRIVE/ROBIN DRIVE  
ANNEXATION TO SANITARY DISTRICT 2

Commencing at the northeasterly corner of Tide Lot 18 as said Lot is shown on Salt Marsh and Tideland Map No. 2; thence SOUTH 220 feet and east 75 feet to the TRUE POINT OF BEGINNING, said point being on the existing boundary of Sanitary District No. 2; thence leaving said district boundary EAST 609.99 feet to another point on said existing Sanitary District boundary; thence southerly, westerly and northerly along said existing district line to the point of beginning.

Contains 6.39 acres more or less.

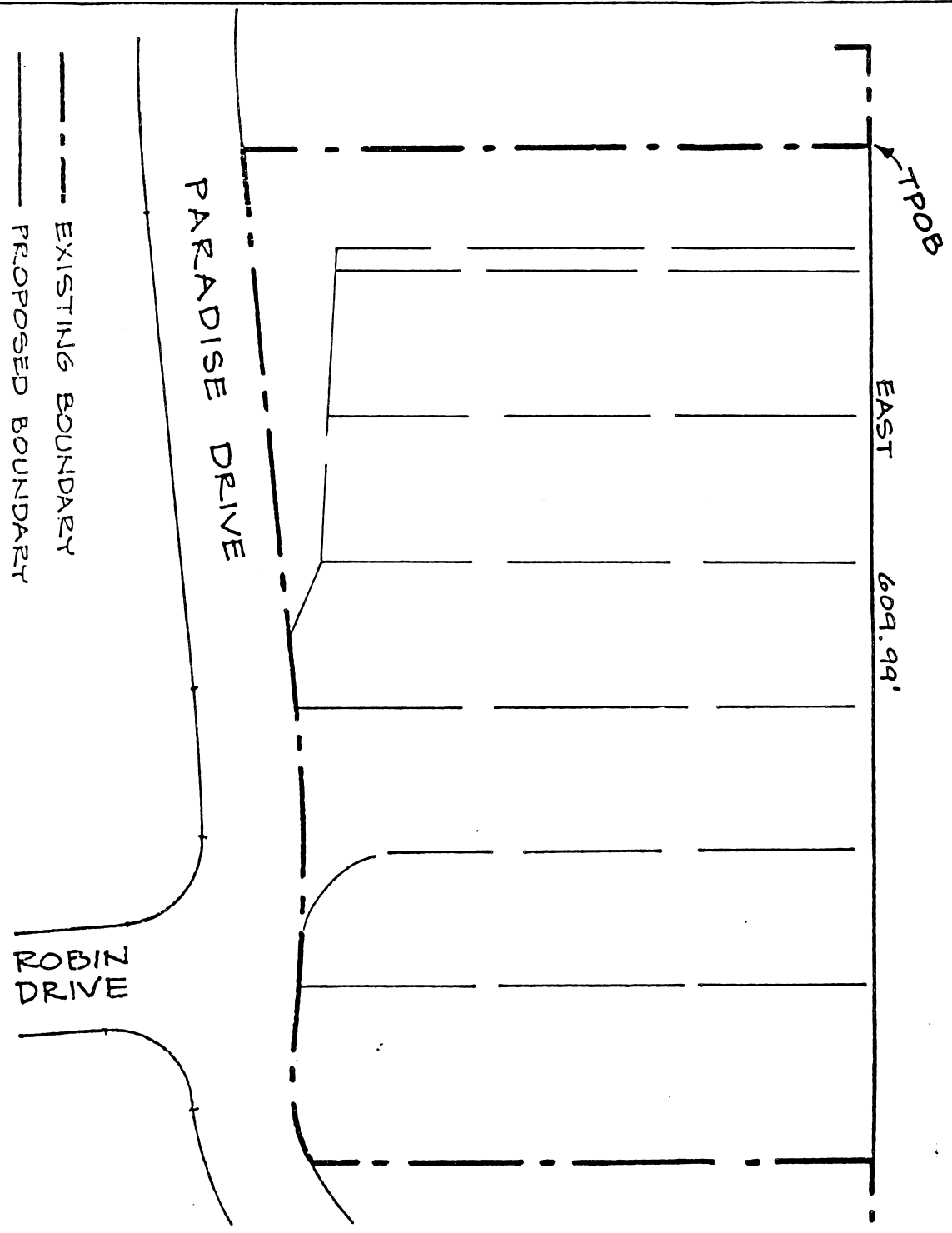
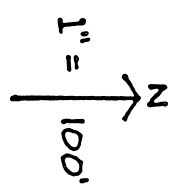
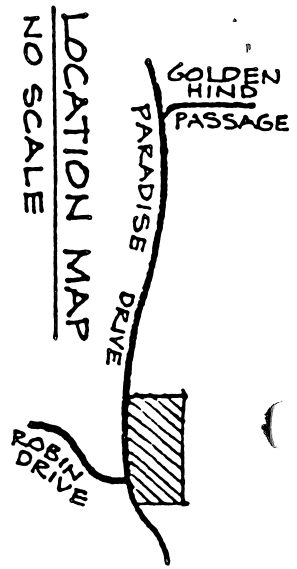

PARADISE DRIVE/ROBIN DRIVE  
ANNEXATION TO  
SANITARY DISTRICT # 2