

LOCAL AGENCY FORMATION COMMISSION OF THE COUNTY OF MARIN

RESOLUTION NO.72-49

RESOLUTION APPROVING THE ANNEXATION OF TERRITORY TO  
SANITARY DISTRICT NO. 6  
INDIAN VALLEY ROAD ANNEXATION 1972-8

WHEREAS, a resolution of application No. 1322 has been filed by Sanitary District No. 6, together with evidence of written consent to all owners of property within the proposed annexation; and

WHEREAS, the Commission has found the territory to be annexed to be uninhabited; and

WHEREAS, the Sanitary District No. 6 has not requested the Commission to hold a noticed public hearing in accordance with Government Code Section 56261.

NOW, THEREFORE, BE IT RESOLVED by the Marin County Local Agency Formation Commission, in accordance with the District Reorganization Act of 1965, that it does hereby approve the annexation of territory known as Indian Valley Road Annexation 1972-8 to the Sanitary District No. 6 with the following determination:

1. Sanitary District No. 6 shall be the conducting District for further proceedings to annex this territory and the Board of Directors of that District is directed to initiate annexation proceedings in compliance with this resolution and the resolution of application. Such proceedings may be without notice, without hearing, and without election.

2. The territory proposed for annexation shall be designated as Indian Valley Road Annexation 1972-8.

PASSED AND ADOPTED by the Marin County Local Agency Formation Commission on this 8th day of November, 1972, by the following vote:

AYES: Commissioners Baar, Brixon, Jones and Marchant

NOES: None

ABSENT: Commissioner Baptiste

ATTEST:

  
\_\_\_\_\_  
Chairman of the Local Agency Formation  
Commission of the County of Marin

  
\_\_\_\_\_  
Executive Officer

SANITARY DISTRICT NO. 6 OF MARIN COUNTY

INDIAN VALLEY RD. ANNEX 1972-8

EXHIBIT "A"

BEGINNING at a point on the existing boundary of Sanitary District No. 6 of Marin County, said point being on the easterly line of Indian Valley Road, 40 feet wide, (formerly Arroyo Avichi Rd.) at its intersection with the southerly line of Lot 189 as said Rd. and Lot are shown upon that certain map entitled, "Map of Subdivisions A and B of the Novato Ranch, Marin County, Calif.", filed November 18, 1909 in Book 3 of Maps at Page 36, Marin County Records; running thence from said point of beginning along said Sanitary District boundary and along said easterly line of Indian Valley Rd. North  $15^{\circ}15'$  East 256.20 feet; thence leaving said Sanitary District boundary and said easterly line of Indian Valley Rd. South  $60^{\circ}45'$  East 125 feet; thence North  $15^{\circ}15'$  East 20.78 feet; thence South  $60^{\circ}45'$  East ~~87.45~~ feet to the easterly line of said Lot 189; thence running along said easterly Lot line South  $29^{\circ}15'$  West 268.75 feet to the most southerly corner of said Lot 189; thence along the southerly line of said Lot North  $60^{\circ}45'$  West 144.39 feet to the point of beginning.

Annex. 1953-10

Annex. 1965-6

HILL

RD.

INDIAN VALLEY RD.

EXISTING DISTRICT BOUNDARY

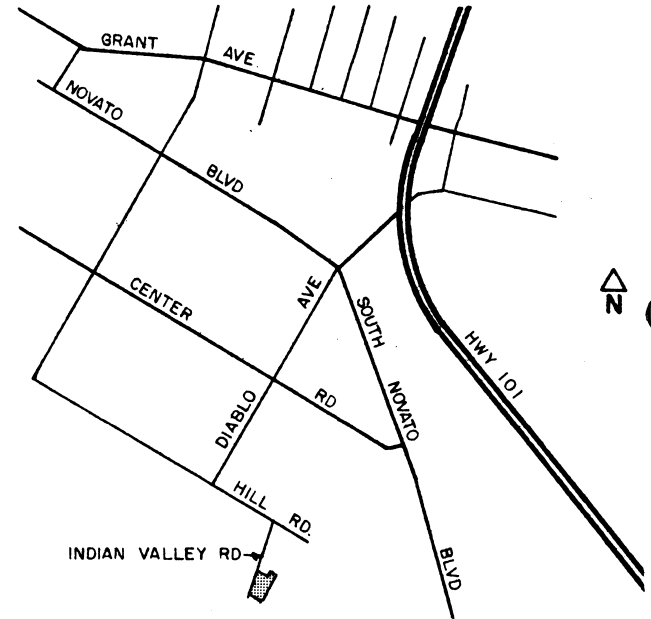

LOCATION MAP

188  
Annex. 1966-12

189  
(3 OR 36)

190

Annex. 1963-9

N 15° 15' E  
20.78'

S 60° 45' E  
87.46'

S 60° 45' E 125'



S 29° 15' W  
268.75'

N 15° 15' E  
256.20'

PROPOSED ANNEXATION 2

N 60° 45' W 144.39'

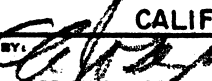
KEY:  Existing District Boundary  
 Proposed District Boundary

<b>NOVATO SANITARY DISTRICT</b>		
SANITARY DISTRICT NO. 6		
MARIN COUNTY CALIFORNIA		
SCALE: 1" = 100'	APPROVED BY: 	DRAWN BY: RLB
DATE: 7-28-72	MANAGER/ENGINEER	CHK'D BY: 
<b>INDIAN VALLEY RD. ANNEX. 1972-8</b>		
		DRAWING NUMBER

Area = 1.18 ac.

POB