

LOCAL AGENCY FORMATION COMMISSION OF MARIN COUNTY

RESOLUTION NO. 76-44

RESOLUTION MAKING DETERMINATIONS AND APPROVING THE ANNEXATION OF
TERRITORY DESIGNATED AS "WILSON AVENUE ANNEXATION (1976-6)"
TO SANITARY DISTRICT NO. 6

WHEREAS, a proposal for the annexation of certain territory to Sanitary District No. 6 in the County of Marin, has been filed with the Executive Officer of this Commission; and

WHEREAS, said proposal was made in the form of Resolution No. 1581, a resolution of application adopted by the Board of Directors of Sanitary District No. 6, and requesting the initiation of annexation proceedings pursuant to the District Reorganization Act of 1965, Division 1 (commencing with Section 56000) of Title 6 of the Government Code; and

WHEREAS, said resolution of application was accompanied by written consent signed by all owners of land within the territory proposed to be annexed; and

WHEREAS, pursuant to Government Code Section 56261, when a resolution of application is accompanied by written consent of all owners of land within the territory proposed to be annexed, this Commission may make determinations with respect to said application without notice and hearing,

NOW, THEREFORE, the Local Agency Formation Commission of the County of Marin, DOES HEREBY RESOLVE, DETERMINE AND ORDER as follows:

1. Subject to the terms and conditions hereinafter specified, the proposal made by Resolution No. 1581 adopted by the Board of Directors of Sanitary District No. 6 is approved.

2. The boundaries of the territory proposed to be annexed shall be those set forth in Exhibit A attached hereto and incorporated herein; and said territory shall be designated as "Wilson Avenue Annexation (1976-6)", and is found to be uninhabited.

3. Any resolution ordering the annexation approved by this resolution shall provide that such annexation is ordered subject to the terms and conditions specified in the resolution of application.

4. Sanitary District No. 6 is designated as the conducting district for further proceedings; and the Board of Directors of said District is hereby directed to initiate proceedings in compliance with this resolution, and is authorized to proceed without notice or hearing pursuant to Government Code Section 56261.

5. The environmental documents relevant to the proposal have been reviewed and considered by the Commission in making its final determination.

6. The Executive Officer is hereby authorized to mail certified copies of this resolution in the manner as prescribed by law.

PASSED AND ADOPTED by the Marin Local Agency Formation Commission on this 20th day of October, 1976, by the following vote:

AYES: Commissioners Arrigoni, Mulryan, Violich and Jones

NOES: None

ABSENT: Commissioner Giacomini

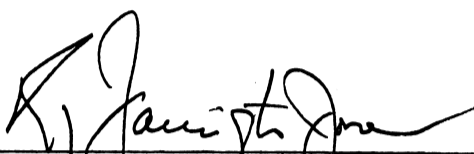

ROY FARRINGTON JONES, Chairman

ATTEST:



LARI I. SHEEHAN, Executive Officer

SANITARY DISTRICT NO. 6 OF MARIN COUNTY

WILSON AVENUE ANNEXATION 1976-6

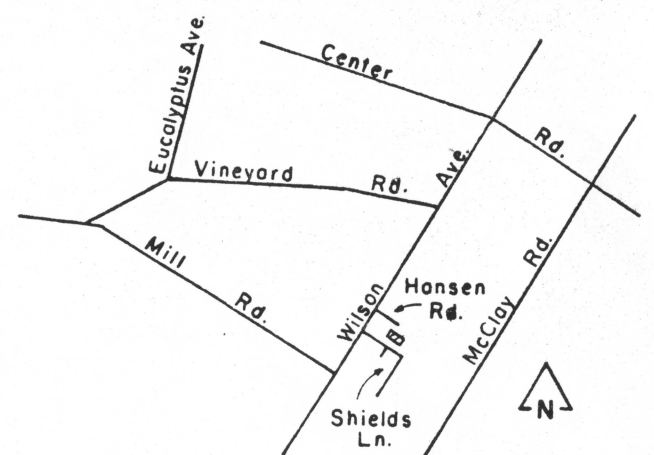
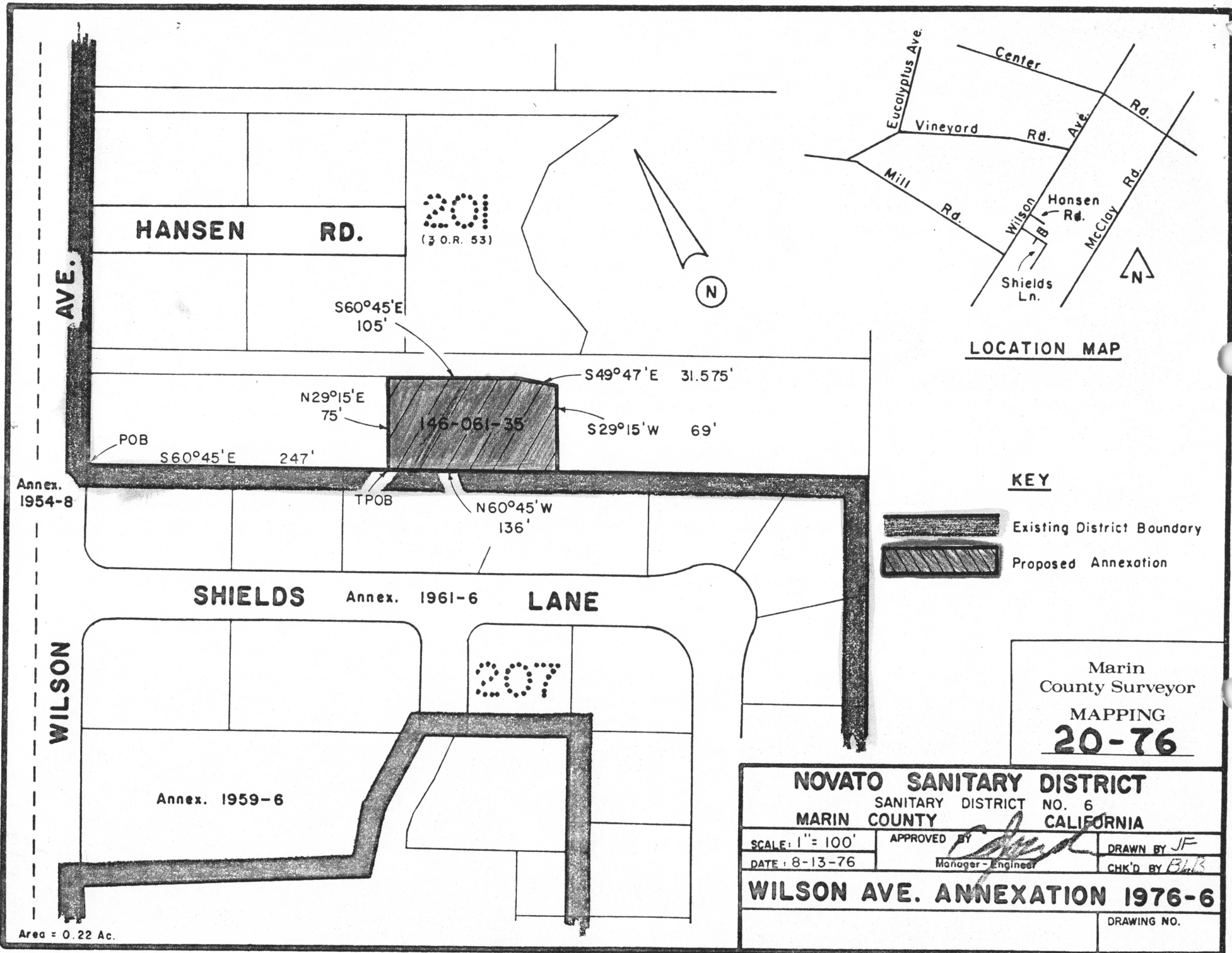

EXHIBIT "A"

Beginning at a point on the existing boundary of Sanitary District No. 6 of Marin County, said point being on the southeasterly line of Wilson Avenue, as widened to 40 feet, at its intersection with the dividing line between Lots 201 and 207 as said Avenue and Lots are shown upon that certain map entitled "Amended Map No. 1 of Subdivision 'C' of the Novato Ranch, Marin County, California", filed July 6, 1910 in Book 3 of Maps at Page 53, Marin County Records; running thence along said Sanitary District boundary and along said dividing line South 60° 45' East 247 feet to the TRUE POINT OF BEGINNING; thence leaving said Sanitary District boundary and said dividing line North 29° 15' East 75 feet; thence South 60° 45' East 105 feet; thence South 49° 47' East 31.575 feet; thence South 29° 15' West 69 feet to a point on said Sanitary District boundary and on said dividing line; thence running along said Sanitary District boundary and along said dividing line North 60° 45' West 136 feet to the TRUE POINT OF BEGINNING.



LOCATION MAP

KEY

-  Existing District Boundary
-  Proposed Annexation

Marin
County Surveyor
MAPPING
20-76

NOVATO SANITARY DISTRICT		
SANITARY DISTRICT NO. 6		
MARIN COUNTY CALIFORNIA		
SCALE: 1" = 100'	APPROVED BY 	DRAWN BY JF
DATE: 8-13-76	Manager - Engineer	CHK'D BY BJK
WILSON AVE. ANNEXATION 1976-6		
		DRAWING NO.

Annex. 1954-8

Annex. 1959-6

Annex. 1961-6

201
(3 O.R. 53)

207

146-061-35

Area = 0.22 Ac.