

LOCAL AGENCY FORMATION COMMISSION OF MARIN COUNTY

RESOLUTION NO. 93-11

RESOLUTION MAKING DETERMINATIONS AND APPROVING ANNEXATION
WITH WAIVER OF NOTICE, HEARING AND ELECTION
TO THE NOVATO SANITARY DISTRICT

"VINEYARD ROAD ANNEXATION 1993-4"

WHEREAS, a proposal for the annexation of certain territory to the Novato Sanitary District, in the County of Marin, has been filed with the Executive Officer of this Local Agency Formation Commission pursuant to Title 5, Division 3, commencing with Section 56000 of the Government Code; and

WHEREAS, said proposal was made in the form of a Resolution No. 2484, a Resolution of Application adopted by the Board of Directors of the Novato Sanitary District; and

WHEREAS, said Resolution of Application was accompanied by written consent signed by all owners of land within the territory proposed to be annexed; and

WHEREAS, pursuant to Government Code Section 56837, when a Resolution of Application is accompanied by written consent of all owners of land within the territory proposed to be annexed, this Commission may make determinations with respect to said annexation without notice and hearing; and

WHEREAS, the Executive Officer has reviewed the proposal and prepared a report, including her recommendation thereon, the proposal and report having been presented to and considered by this Commission.

NOW, THEREFORE, the Local Agency Formation Commission of the County of Marin DOES HEREBY RESOLVE, DETERMINE AND ORDER as follows:

Section 1. Subject to the terms and conditions hereinafter specified, the proposal made by Resolution No. 2484, adopted by the Board of Directors of the Novato Sanitary District, is approved.

Section 2. The boundaries, as set forth in the proposal, are hereby approved as submitted and are as described in Exhibit "A," attached hereto and by this reference incorporated herein.

Section 3. The territory includes .47 acre, is found to be uninhabited, and is assigned the following distinctive short form designation: "Vineyard Road Annexation 1993-4" to the Novato Sanitary District.

Section 4. The proposal is consistent with the spheres of influence of affected local agencies.

Section 5. Any resolution authorizing the annexation approved by this resolution shall impose the terms and conditions, as set forth in Exhibit "B," attached hereto and incorporated herein.

Section 6. The Novato Sanitary District is designated as the conducting district for further proceedings, and the Board of said District is hereby directed to initiate proceedings in compliance with this resolution and is authorized to proceed without notice, or election, pursuant to Government Code Section 56837.

Section 7. The project is categorically exempt pursuant to provisions of the California Environmental Quality Act and the Commission's Environmental Guidelines

Section 8. The Executive Officer is hereby authorized and directed to mail certified copies of the resolution in the manner prescribed by Section 56853 of the Government Code.

PASSED AND ADOPTED by the Marin County Local Agency Formation Commission on the 5th day of August 1993 by the following vote:

AYES: Commissioners Breiner, Giacomini, Richardson and Williams

NOES: None

ABSENT: Commissioner Bevis

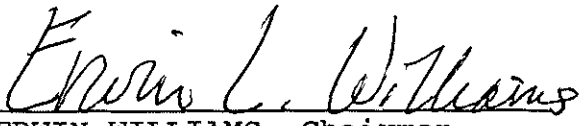
ERWIN WILLIAMS, Chairman
Marin Local Agency Formation
Commission

ATTEST:

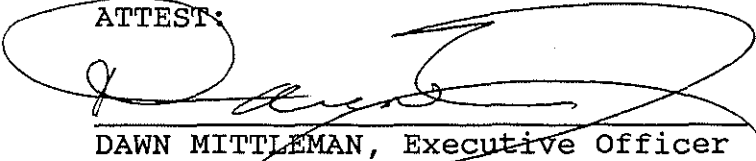
DAWN MITTLEMAN, Executive Officer

Dated: August 5, 1993

NOVATO SANITARY DISTRICT



Vineyard Road Annex 1993-4

Exhibit "A"

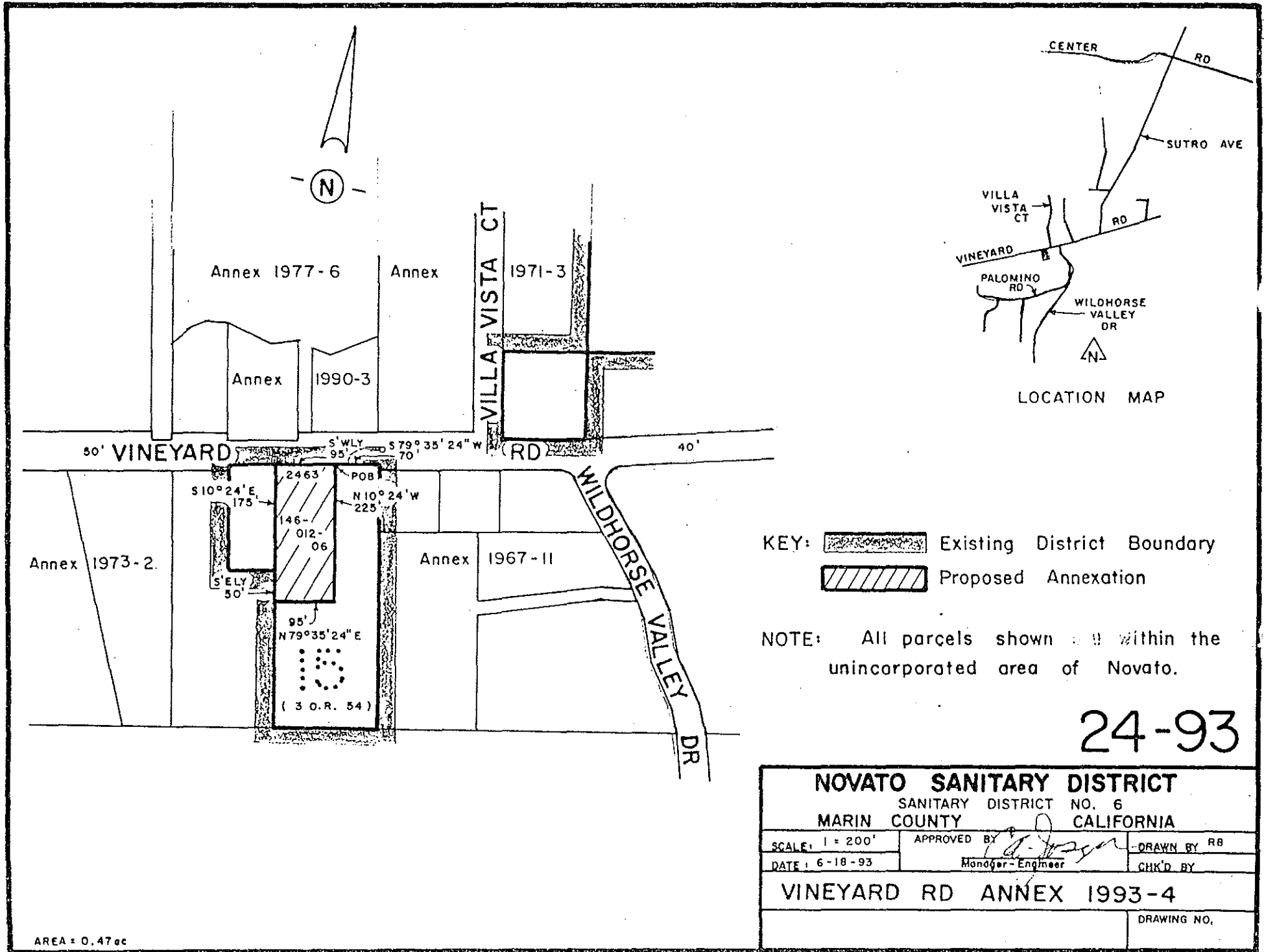
BEGINNING at a point on the existing boundary of Novato Sanitary District, said point being on the southerly line of Vineyard Road distant thereon south $79^{\circ}35'24''$ West 70 feet from its intersection with the easterly line of Lot 15 as said Road and Lot are shown upon that certain map entitled "Amended Map No. 1 of Subdivision 'E' of the Novato Ranch, Marin County, California" filed July 6, 1910 in Book 3 of Maps at page 54, Marin county Records; running thence along said southerly line of Vineyard Road and along said Sanitary District boundary Southwesterly 95 feet; thence leaving said southerly line of Vineyard Road and said Sanitary District boundary south $10^{\circ}24'$ East 175 feet to a point on said Sanitary District boundary; thence continuing along said Sanitary District boundary Southeasterly 50 feet; thence leaving said Sanitary District boundary North $79^{\circ}35'24''$ East 95 feet; thence North $10^{\circ}24'$ West 225 feet to the point of beginning. Containing 0.47 acres, more or less.

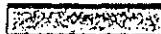

AREA : 0.47 ac

KEY:  Existing District Boundary
 Proposed Annexation

NOTE: All parcels shown are within the unincorporated area of Novato.

24-93

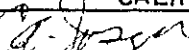
NOVATO SANITARY DISTRICT		
SANITARY DISTRICT NO. 6		
MARIN COUNTY CALIFORNIA		
SCALE: 1" = 200'	APPROVED BY 	DRAWN BY RB
DATE: 6-18-93	Manager-Engineer	CHK'D BY
VINEYARD RD ANNEX 1993-4		
		DRAWING NO.