

SANITARY DISTRICT NO. 6 OF MARIN COUNTY

CENTER ROAD ANNEX 1971-4

EXHIBIT "A"

BEGINNING at a point on the existing boundary of Sanitary District No. 6 of Marin County, said point being on the northerly line of Center Road, distant thereon South 75° 45' East 140.0 feet from its intersection with the westerly line of Lot 75 as said Road and Lot are shown upon that certain map entitled "Amended Map No. 1 of Subdivision 'E' of the Novato Ranch, Marin County, California", filed July 6, 1910 in Book 3 of Maps at Page 54, Marin County Records, running thence from said point of beginning, along said Sanitary District boundary leaving said northerly line of Center Road, North 14° 15' East 289.89 feet; thence South 80° 03' East 135 feet; thence leaving said Sanitary District boundary South 14° 15' West 315.85 feet to said northerly line of Center Road and to a point on said Sanitary District boundary; thence running along said northerly line of Center Road and along said Sanitary District boundary North 75° 45' West 135 feet to the point of beginning.

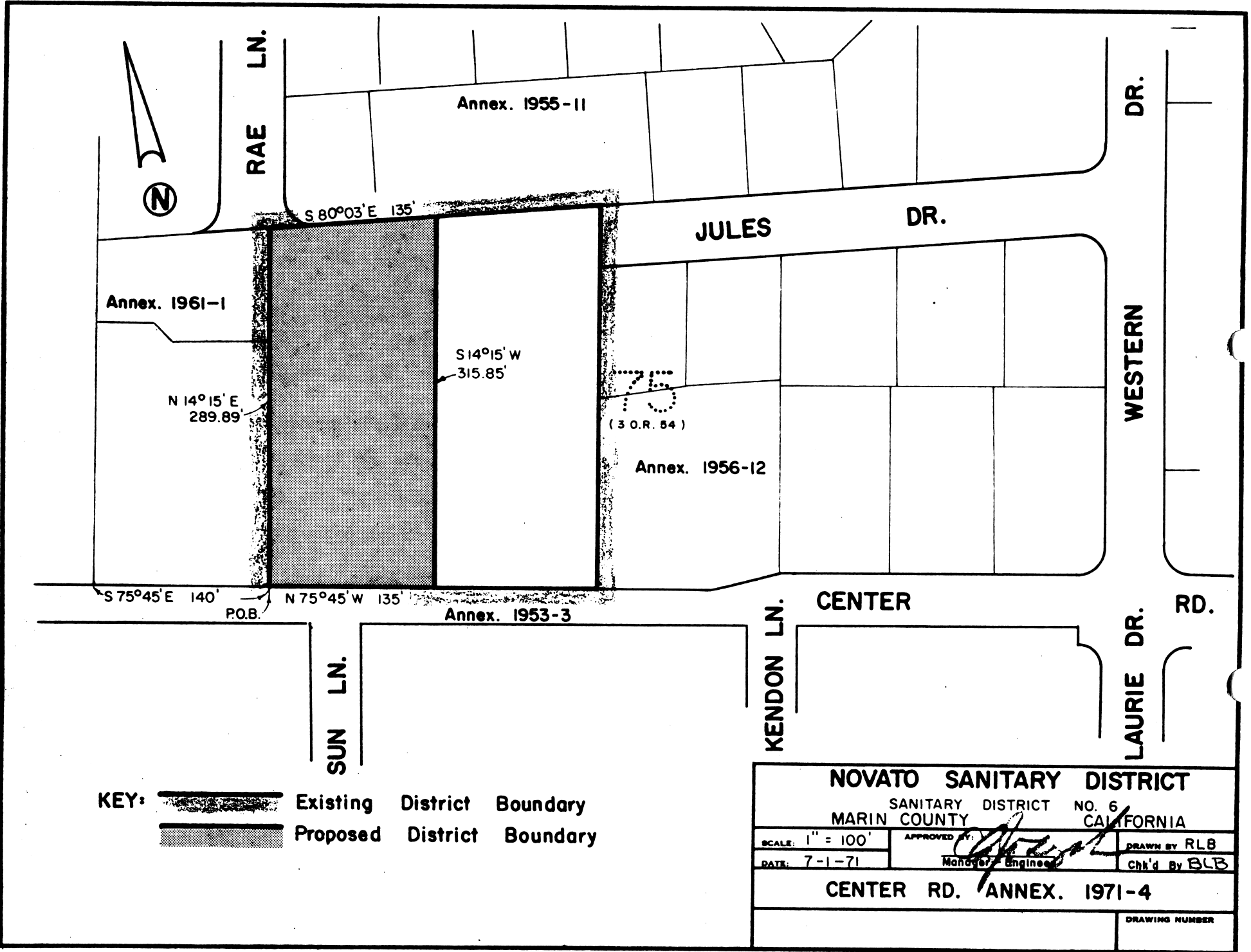

KEY:  Existing District Boundary
 Proposed District Boundary

NOVATO SANITARY DISTRICT		
SANITARY DISTRICT NO. 6		
MARIN COUNTY CALIFORNIA		
SCALE: 1" = 100'	APPROVED BY: 	DRAWN BY RLB
DATE: 7-1-71	MANAGER/ENGINEER	CHK'd BY BLB
CENTER RD. ANNEX. 1971-4		
		DRAWING NUMBER