

LOCAL AGENCY FORMATION COMMISSION OF MARIN COUNTY

RESOLUTION NO. 79-5

RESOLUTION MAKING DETERMINATIONS AND APPROVING ANNEXATION
WITH WAIVER OF NOTICE, HEARING, AND ELECTION
TO NOVATO SANITARY DISTRICT

VINEYARD ROAD ANNEXATION 1978-16

WHEREAS, a proposal for the annexation of certain territory to the Novato Sanitary District, in the County of Marin, has been filed with the Executive Officer of this Commission; and,

WHEREAS, said proposal was made in the form of Resolution No. 1745, a resolution of application adopted by the Board of Directors of the Sanitary District, and requesting the initiation of annexation proceedings pursuant to the District Reorganization Act of 1965, Division 1 (commencing with Section 56000) of Title 6 of the Government Code; and,

WHEREAS, said resolution of application was accompanied by written consent signed by all owners of land within the territory proposed to be annexed; and,

WHEREAS, pursuant to Government Code Section 56261, when a resolution of application is accompanied by written consent of all owners of land within the territory proposed to be annexed, this Commission may make determinations with respect to said annexation without notice and hearing.

NOW, THEREFORE, the Local Agency Formation Commission of the County of Marin, DOES HEREBY RESOLVE, DETERMINE AND ORDER as follows:

Section 1. Subject to the terms and conditions hereinafter specified, the proposal made by Resolution No. 1745, adopted by the Board of Directors of the Novato Sanitary District, is approved.

Section 2. The boundaries of the territory proposed to be annexed shall be those set forth in Exhibit A, attached hereto and incorporated herein; said territory shall be designated as the "Vineyard Road Annexation 1978-16" and is found to be uninhabited.

Section 3. Any resolution ordering the annexation approved by this resolution shall provide that such annexation is ordered subject to the terms and conditions specified in the resolution of application.

Section 4. The Novato Sanitary District is designated as the conducting district for further proceedings; and, the Board of Directors of said District is hereby directed to initiate proceedings in compliance with this resolution, and is authorized to proceed without notice or hearing pursuant to Government Code Section 56261.

Section 5. The City of Novato has assumed Lead Agency for two separate projects involving divisions of land, has conducted environmental reconnaissance, completed an Initial Study, and issued the projects Negative Declarations. Lafco has considered the agency's environmental documents and certifies their adequacy.

Section 6. The Executive Officer is hereby authorized to mail certified copies of this resolution in the manner and as prescribed by law.

PASSED AND ADOPTED by the Marin Local Agency Formation Commission on this 14th day of February 1979 by the following vote:

AYES: Commissioners Haehl, Rice, U'Ren, Wilhelm and Violich

NOES: None

ABSENT: None

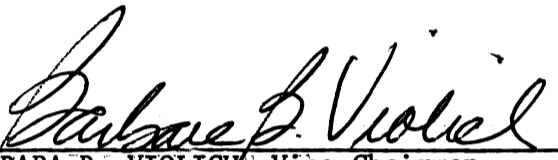

BARBARA B. VIOLICH, Vice Chairman
Marin Local Agency Formation Commission

ATTEST:

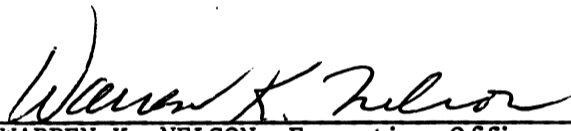

WARREN K. NELSON, Executive Officer

DATE: February 15, 1979

NOVATO SANITARY DISTRICT



VINEYARD ROAD ANNEXATION 1978-16

EXHIBIT "A"

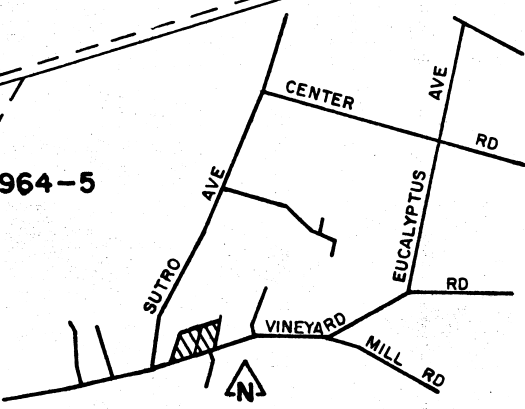
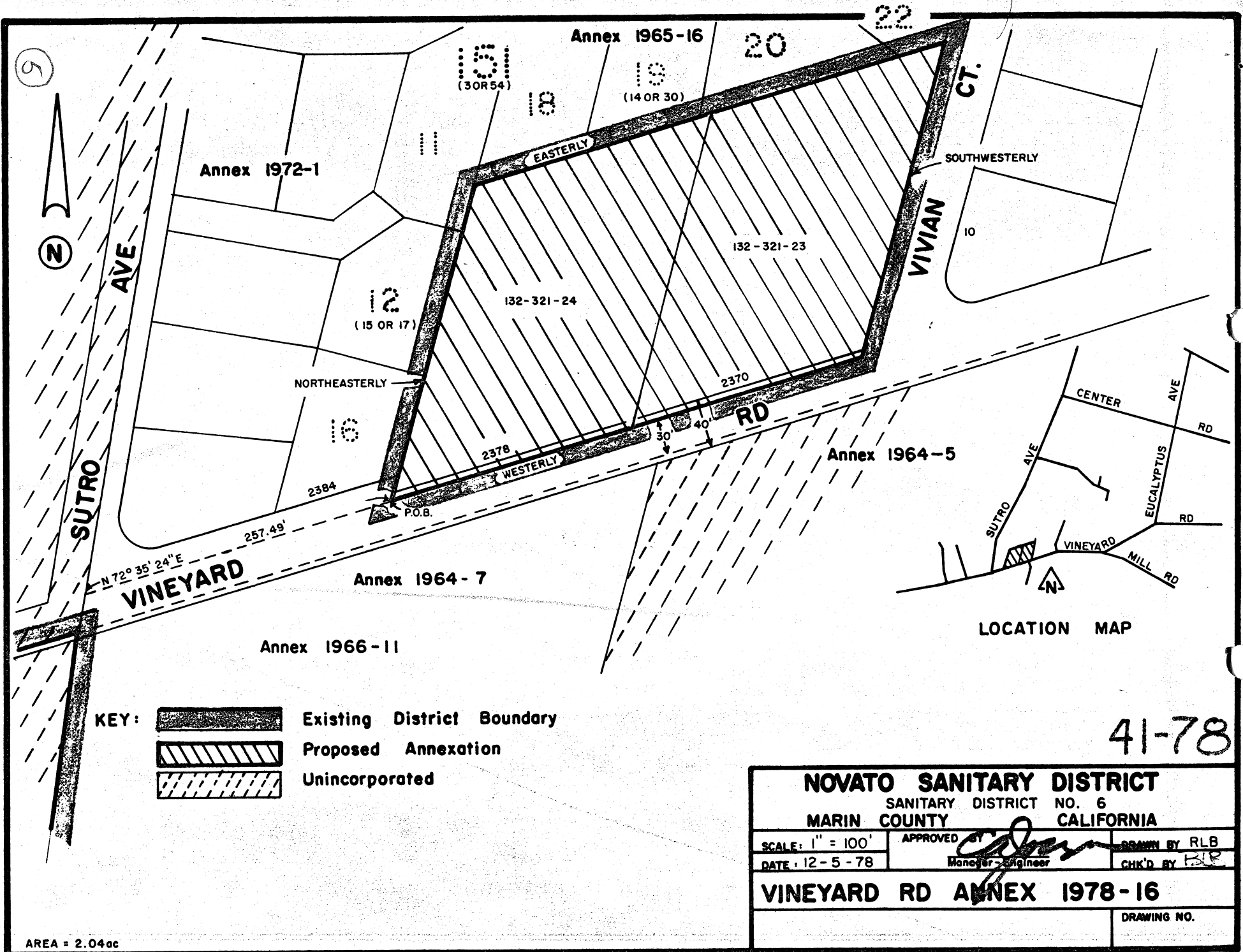

Beginning at a point on the existing boundary of Novato Sanitary District, said point being on the northerly line of Vineyard Road (30 feet wide) distant thereon North 72° 35' 24" East 257.49 feet from its intersection with the easterly line of Sutro Avenue, as said Road and Avenue are shown upon that certain map entitled "Amended Map No. 1 of Subdivision 'E' of the Novato Ranch, Marin County, California" filed July 6, 1910 in Book 3 of Maps at Page 54, Marin County Records, said point also being a point on the Southerly extension of the Easterly line of Tamak Estates as said line is shown upon that certain map entitled "Map of Tamak Estates, Novato, Marin County, California", filed April 27, 1972 in Volume 15 of Maps at Page 17, Marin County Records; thence leaving said northerly line of Vineyard Road and running along said easterly line of Tamak Estates Northeasterly to its intersection with the southerly line of Lot 18 as said Lot is shown upon that certain map entitled "Map of Vineyard Manor, Novato, Marin County, California", filed March 20, 1968 in Volume 14, of Maps at Page 30, Marin County Records; thence leaving said easterly line of Tamak Estates and running along said Sanitary District boundary and along said southerly line of Lot 18 and the southerly line of Lots 19, 20 and 22 as shown on said map of Vineyard Manor Easterly to the westerly line of Vivian Court; thence continuing along said Sanitary District boundary and along said westerly line of Vivian Court Southwesterly to its intersection with said northerly line of Vineyard Road (30 feet wide), thence continuing along said Sanitary District boundary and along said northerly line of Vineyard Road Westerly to the point of beginning.

CONTAINING 2.04 acres, more or less

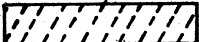

- KEY:**
-  Existing District Boundary
 -  Proposed Annexation
 -  Unincorporated

41-78

NOVATO SANITARY DISTRICT		
SANITARY DISTRICT NO. 6		
MARIN COUNTY		CALIFORNIA
SCALE: 1" = 100'	APPROVED BY 	DRAWN BY RLB
DATE: 12-5-78	Manager-Engineer	CHK'D BY 
VINEYARD RD ANNEX 1978-16		
		DRAWING NO.

AREA = 2.04ac