

LOCAL AGENCY FORMATION COMMISSION OF THE COUNTY OF MARIN

RESOLUTION NO. 83-3

RESOLUTION MAKING DETERMINATIONS AND APPROVING WITH WAIVER OF NOTICE HEARING AND ELECTION THE REORGANIZATION INVOLVING ANNEXATION OF TERRITORY TO THE CITY OF NOVATO AND THE NOVATO SANITARY DISTRICT

BEL MARIN KEYS BLVD. REORGANIZATION 1982-3

WHEREAS, a proposal for a reorganization involving the annexation of certain territory to the City of Novato and the Novato Sanitary District has been filed with the Executive Officer of this Commission; and

WHEREAS, said proposal was made in the form of Resolution No. 106-82, a resolution of application adopted by the Council of the City of Novato requesting initiation of proceedings pursuant to the District Reorganization Act of 1965, Division 1 (commencing with Section 56000) of the Government Code; and

WHEREAS, pursuant to Government Code Section 56261 and 56261.1 when an application making a proposal for a reorganization is signed by owners of all affected properties, this Commission may make determinations with respect to said proposal without notice and hearing.

NOW, THEREFORE, the Local Agency Formation Commission of the County of Marin DOES HEREBY RESOLVE, DETERMINE AND ORDER as follows:

Section 1. Subject to the terms and conditions hereinafter specified, the reorganization proposal is approved as amended. Said amendment incorporates land commonly known as "Pacheco Pond," listed under the ownership of the Marin County Flood Control and Water Conservation District, into said proposal.

Section 2. The boundaries of the territory proposed for reorganization shall be those set forth in Exhibit A, attached hereto and incorporated herein. The reorganization consists of the following changes of organization: annexation to the City of Novato and annexation to the Novato Sanitary District. The territory shall be designated as the "Bel Marin Keys Blvd. Reorganization 1982-3."

Section 3. Any resolution authorizing the reorganization approved shall impose the Novato Sanitary District's standard terms and conditions as set forth in Exhibit B, attached hereto and incorporated herein.

Section 4. Said territory is found to be uninhabited.

Section 5. The City of Novato, pursuant to Section 56271.1 of the Government Code, is designated as the conducting agency for further proceedings

and is hereby directed to initiate such proceedings in compliance with this resolution and is authorized to take such proceedings upon said reorganization without notice or hearing pursuant to Government Code Section 56261.

Section 6. In accordance with applicable provisions contained in the adopted Marin Local Agency Formation Commission Environmental Guidelines and Procedures, the City of Novato is the appropriate lead agency and has deemed this proposal categorically exempt pursuant to provisions of the California Environmental Quality Act.

Section 7. The Executive Officer is hereby authorized and directed to mail certified copies of this resolution in the manner prescribed in Section 56272 of the Government Code.

PASSED AND ADOPTED by the Local Agency Formation Commission of the County of Marin on this 10th day of March 1983 by the following vote:

AYES: Commissioners Boucke, Breiner, Stockwell and Boessenecker

NOES: None

ABSENT: Commissioner Giacomini

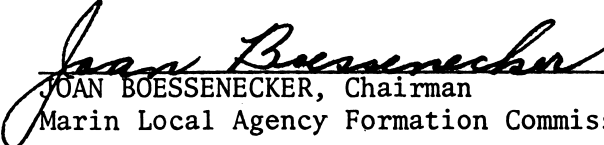
JOAN BOESSENECKER, Chairman
Marin Local Agency Formation Commission

ATTEST:

WARREN K. NELSON, Executive Officer

DATE:

March 11, 1983

LEGAL DESCRIPTION
 BEL MARIN KEYS BOULEVARD REORGANIZATION 1982-3

PARCEL ONE
 ANNEXATION TO THE CITY OF NOVATO AND THE NOVATO SANITARY DISTRICT

Beginning at a point on the existing boundary of Novato Sanitary District and City of Novato, said point being on the easterly line of that certain 13.929 acre parcel of land described as Parcel 1 in deed from Clarence Leveroni and others to Pacific Gas and Electric Company, a California corporation, said deed having been recorded in Book 1664 at Page 377, Marin County Records, distant thereon South 22°49'30" East 137.70 feet from the most northerly corner of said Parcel 1; thence leaving said easterly line of said parcel and said Sanitary District boundary and said City of Novato boundary North 67°10'30" East 550.77 feet; thence South 33°21'15" East 226.52 feet, to a point on said Sanitary District boundary and on said City of Novato boundary; thence running along said Sanitary District and said City of Novato boundaries southwesterly to a point on said easterly line of Parcel 1; thence running along said easterly line and continuing along said Sanitary District and said City of Novato boundaries northwesterly to the point of beginning.

Containing 1.48 acres, more or less.

PARCEL TWO
 ANNEXATION TO THE CITY OF NOVATO

Beginning at a point at the most easterly terminus of the line which bears North 67°48'15" East, 228.18 feet, said line being on the northerly boundary of Parcel 3A, the same as shown on that certain Parcel Map, entitled "Land Division - Parcel 3 of 9 P.M. 44, being a portion of Parcel 2 of Ignacio Industrial Park, Unit One, 7 P.M. 119, Marin County, California", recorded December 28, 1973, in Book 9 of Parcel Maps, at page 46, Marin County Records, said line being also the southerly boundary of Bel Marin Keys Boulevard as recorded March 26, 1963 in Book 1670 of Official Records, at page 419, Marin County Records and shown on said Parcel Map (9 P.M. 46); thence leaving the said boundary of Parcel 3A (9 P.M. 46) and running thence along the said southerly boundary of said Bel Marin Keys Boulevard (1670 O.R. 419) the following courses and distances: North 67°48'15" East, 1279.64 feet; thence along a tangent curve to the right, having a radius of 453 feet, through a central angle of 10°22'20", an arc length of 82.01 feet; thence North 78°10'35" East, 252.47 feet; thence along a tangent curve to the left, having a radius of 547 feet, through a central angle of 6°50'20", an arc length of 65.29 feet; thence North 71°20'15" East, 399.98 feet; thence along a tangent curve to the left, having a radius of 547 feet, through a central angle of 1°30'35", an arc length of 14.41 feet to a point on the described boundary of that certain parcel of land from Pine and Co. to Manuel T. Pimentel and Mary C. Pimentel as recorded in Book 753 of Official Records at page 346, Marin County Records, said point being North 27°22'15" West, 243.13 feet from the intersection of the courses called South 28°32'30" East, 270.25 feet" and "South 64°35'30" East, 162.74 feet" (753 O.R. 346); thence leaving the said southerly boundary of said Bel Marin Keys Boulevard (1670 O.R. 419) and running thence along the boundary of said Pimentel (753 O.R. 346) South 27°22'15" East, 243.13 feet (South 28°32'30" East, 753 O.R. 346); thence South 63°25'15" East, 162.74 feet (South 64°35'30" East, 753 O.R. 346); thence South 21°35'15" East, 1279.77 feet (South 22°45'30" East, 753 O.R. 346); thence South 36°07'45" West, 141.92 feet (South 34°57'30" West, 753 O.R. 346); thence South 13°16'15" East, 243.25 feet (South 14°26'30" East, 753 O.R. 346); thence South 33°51'45" East, 612.38 feet (South 35°02' East, 753 O.R. 346); thence South 41°40'45" East, 102.95 feet (South 42°51' East, 753 O.R. 346); thence South 69°13'45" East, 306.46 feet (South 70°24' East, 753 O.R. 346); thence South 55°18'45" East, 614.71 feet (South 56°29' East, 463.15 feet), (753 O.R. 346) more or less to a point on the northerly boundary line of the property described in deed from California Packing Corporation, a corporation, to the United States of America, dated April 21, 1943, recorded May 17, 1943, in Book 443 of Official Records at Page 480, Marin County Records, said point also being on the Novato City Limits Line; thence continuing along the said boundary of said Pimentel (753 O.R. 346) and the said northerly boundary line of said United States of America (443 O.R. 480) and the said Novato City Limits Line, Southwesterly, Northwesterly and Northeasterly to the point of beginning.

Said parcel containing 124.54 acres, more or less.

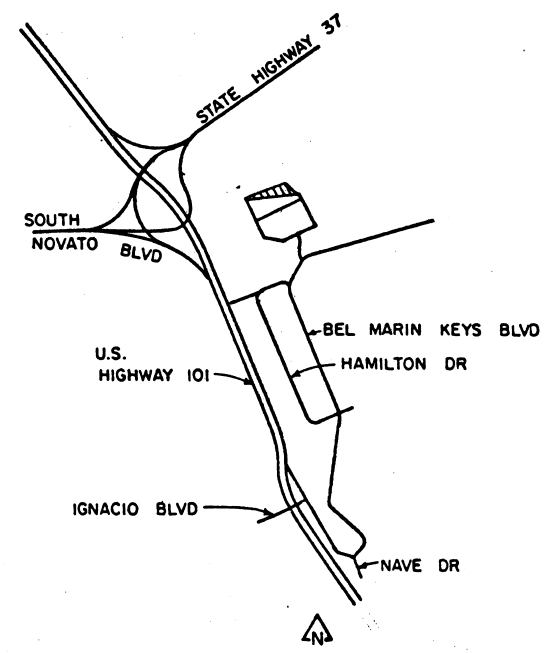
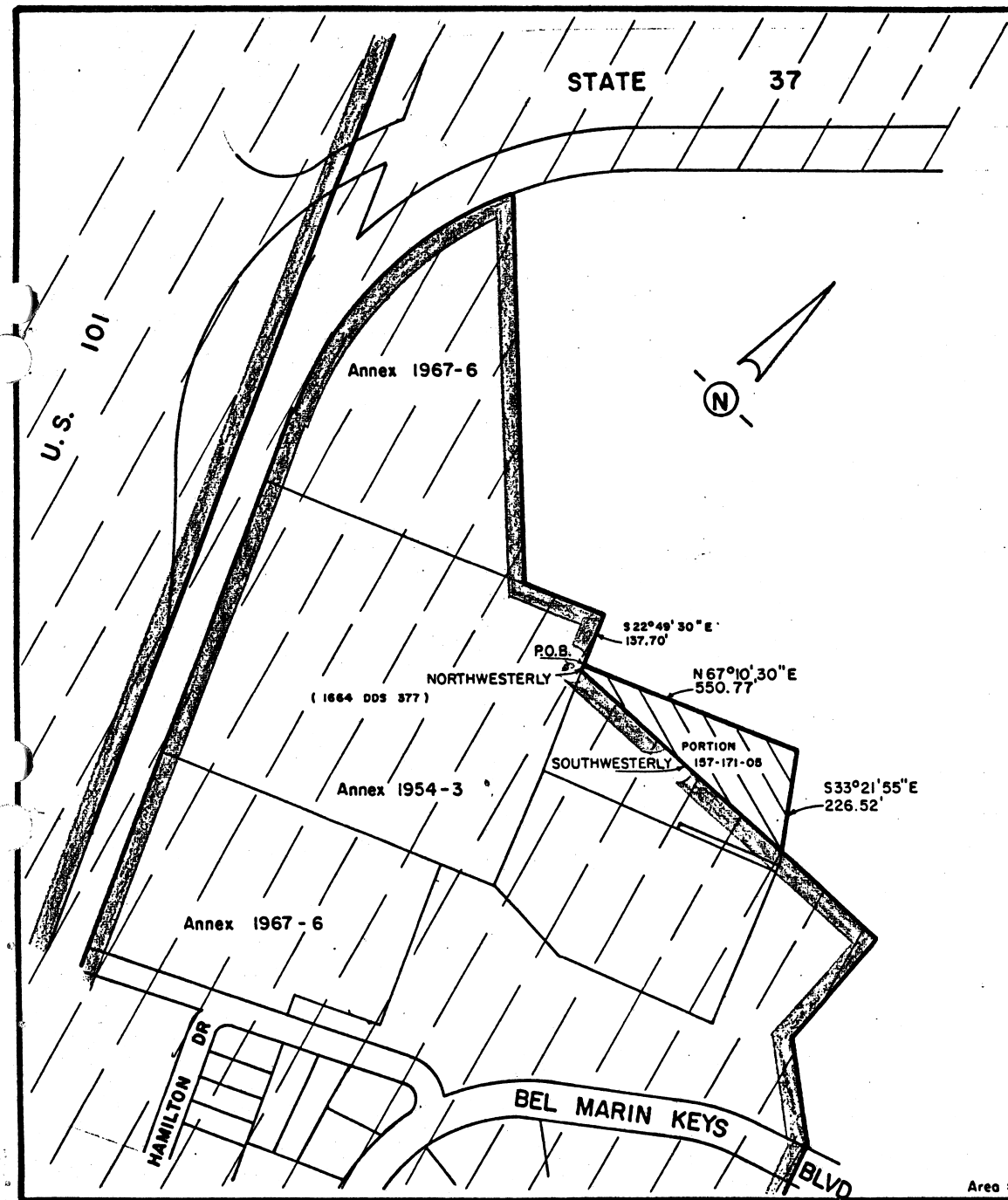

LOCATION MAP

- KEY:
- Existing District Boundary
 - Proposed Reorganization
 - Existing City Boundary

NOVATO SANITARY DISTRICT		
SANITARY DISTRICT NO. 6		
MARIN COUNTY		CALIFORNIA
BEL MARIN KEYS BLVD REORGANIZATION		
1982-3		
SCALE: 1" = 300'	APPROVED BY: MANAGER-ENGINEER	DATE: 5-19-82
DRAWN BY: RB		DRAWING NO.
CHECKED BY: P.S.		

Area = 1.48 ac