

LOCAL AGENCY FORMATION COMMISSION OF THE COUNTY OF MARIN

RESOLUTION NO. 69-7

RESOLUTION APPROVING THE ANNEXATION OF TERRITORY TO
SANITARY DISTRICT NO. 6

VIRGINIA AVENUE ANNEXATION 1969-2

WHEREAS, a resolution of application No. 1052 has been filed by
Sanitary District No. 6, together with evidence of written
consent of all owners of property within the proposed annexation; and

WHEREAS, the Commission has found the territory to be annexed to be
uninhabited; and

WHEREAS, the Sanitary District No. 6
has not requested the Commission to hold a noticed public hearing in accordance
with Government Code Section 56261.

NOW, THEREFORE, BE IT RESOLVED by the Marin County Local Agency Forma-
tion Commission, in accordance with the District Reorganization Act of 1965, that
it does hereby approve the annexation of territory known as Virginia Avenue
Annexation 1969-2 to Sanitary District No. 6
with the following determinations:

1. Sanitary District No. 6 shall
be the conducting District for further proceedings to annex this territory and
the Board of Directors of that District is directed to initiate annexation pro-
ceedings in compliance with this resolution and the resolution of application.
Such proceedings may be without notice, without hearing, and without election.

2. The territory proposed for annexation shall be designated as
Virginia Avenue Annexation 1969-2.

PASSED AND ADOPTED by the Marin County Local Agency Formation Commission
on this 6th day of March, 1969 by the following vote:

AYES: Commissioners Dyk, Arrigoni, Womack, Wornum, Marchant

NOES: None

ABSENT: None

Chairman of the Local Agency Formation
Commission of the County of Marin

ATTEST:



Executive Officer



SANITARY DISTRICT NO. 6 OF MARIN COUNTY

VIRGINIA AVENUE ANNEX 1969-2

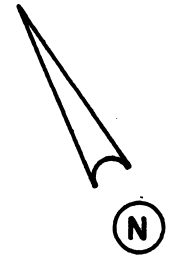
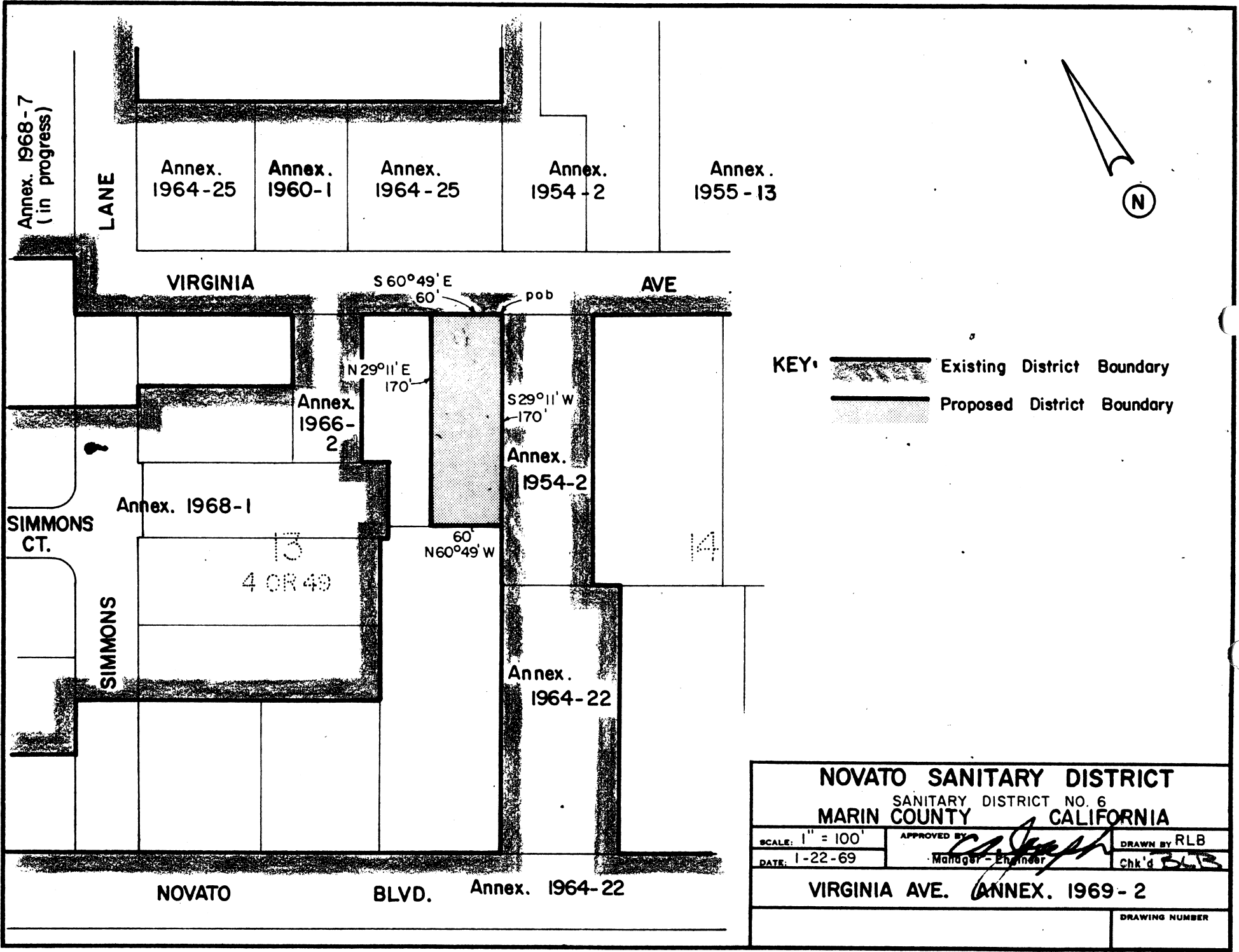
"EXHIBIT A"

BEGINNING at a point on the existing boundary of Sanitary District No. 6 of Marin County, said point being on the Southwesterly line of Virginia Avenue at its intersection with the Southeasterly line of Lot 13 as said Avenue and Lot are shown upon that certain map entitled "Subdivision one, Sweetser Ranch, Novato, California", filed July 15, 1913 in Liber 4 of Maps at Page 49, Marin County Records; thence leaving said Southwesterly line of Virginia Avenue and running along said Sanitary District boundary and along said Southeasterly line of Lot 13 South $29^{\circ} 11'$ West 170 feet; thence leaving said Sanitary District boundary and said Southeasterly line of Lot 13 North $60^{\circ} 49'$ West 60 feet; thence North $29^{\circ} 11'$ East 170 feet to a point on said Sanitary District boundary and on said Southwesterly line of Virginia Avenue; thence along said Sanitary District boundary and said Southwesterly line of Virginia Avenue South $60^{\circ} 49'$ East 60 feet to the point of beginning.



KEY:
 Existing District Boundary
 Proposed District Boundary

NOVATO SANITARY DISTRICT			
SANITARY DISTRICT NO. 6			
MARIN COUNTY		CALIFORNIA	
SCALE: 1" = 100'	APPROVED BY: 	DRAWN BY RLB	
DATE: 1-22-69	Manager - Engineer	Chk'd BLS	
VIRGINIA AVE. ANNEX. 1969-2			
			DRAWING NUMBER