

LOCAL AGENCY FORMATION COMMISSION OF MARIN COUNTY

RESOLUTION NO. 80-1

RESOLUTION MAKING DETERMINATIONS AND APPROVING ANNEXATION
WITH WAIVER OF NOTICE, HEARING, AND ELECTION
TO THE NOVATO SANITARY DISTRICT

OLIVE AVENUE ANNEXATION 1977-1

WHEREAS, a proposal for the annexation of certain territory to the Novato Sanitary District, in the County of Marin, has been filed with the Executive Officer of this Commission; and,

WHEREAS, said proposal was made in the form of Resolution No. 1777, a resolution of application adopted by the Board of Directors of the Sanitary District, and requesting the initiation of annexation proceedings pursuant to the District Reorganization Act of 1965, Division 1 (commencing with Section 56000) of Title 6 of the Government Code; and,

WHEREAS, said resolution of application was accompanied by written consent signed by all owners of land within the territory proposed to be annexed; and,

WHEREAS, pursuant to Government Code Section 56261, when a resolution of application is accompanied by written consent of all owners of land within the territory proposed to be annexed, this Commission may make determinations with respect to said annexation without notice and hearing.

NOW, THEREFORE, the Local Agency Formation Commission of the County of Marin, DOES HEREBY RESOLVE, DETERMINE AND ORDER as follows:

Section 1. Subject to the terms and conditions hereinafter specified, the proposal made by Resolution No. 1777, adopted by the Board of Directors of the Novato Sanitary District, is approved.

Section 2. The boundaries of the territory proposed to be annexed shall be those set forth in Exhibit A, attached hereto and incorporated herein; and said territory shall be designated as the Olive Avenue Annexation 1977-1.

Section 3. Said territory is found to be uninhabited.

Section 4. Any resolution ordering the annexation approved by this resolution shall provide that such annexation is ordered subject to the terms and conditions specified in the resolution of application and subject to the property owner agreement entitled Exhibit B, attached hereto and incorporated herein.

Section 5. The Novato Sanitary District is designated as the conducting district for further proceedings, and the Board of Directors of said District is hereby directed to initiate proceedings in compliance with this resolution and is authorized to proceed without notice or hearing pursuant to Government Code Section 56261.

Section 6. In accordance with applicable provisions contained in the adopted Marin Local Agency Formation Commission Environmental Guidelines and Procedures, the City of Novato is the appropriate lead agency, has conducted an Initial Study incorporating concerns of said Commission, a responsible agency, and has issued a Negative Declaration. The Marin Local Agency Formation Commission hereby certifies that the Commission has considered said documents.

Section 7. The Executive Officer is hereby authorized to mail certified copies of this resolution in the manner and as prescribed by law.

PASSED AND ADOPTED by the Marin Local Agency Formation Commission on this 9th day of January 1980 by the following vote:

AYES: Commissioners U'Ren, Violich, Wilhelm and Mulryan

NOES: None

ABSENT: Commissioner Giacomini

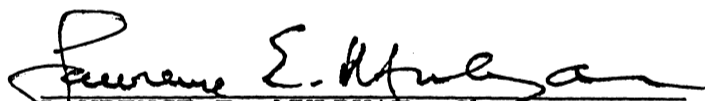
LAWRENCE E. MULRYAN, Chairman
Marin Local Agency Formation Commission

ATTEST:

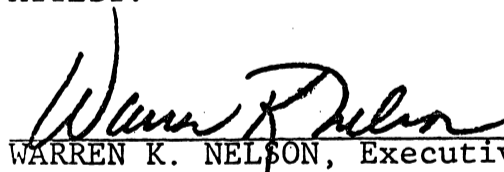
WARREN K. NELSON, Executive Officer

DATE: January 10, 1980

SANITARY DISTRICT NO. 6 OF MARIN COUNTY

OLIVE AVENUE ANNEXATION 1977-1

EXHIBIT "A"

Beginning at a point on the existing boundary of Sanitary District No. 6 of Marin County, said point being on the northeasterly line of Olive Avenue at its intersection with the southwesterly line of lot 16 as said Avenue and Lot are shown upon that certain map entitled "Map of East Part Rancho de Novato, Marin County, California", filed March 22, 1889 in Rack 2 of Maps Pull 3, Marin County Records; running thence along said northeasterly line of Olive Avenue and along said Sanitary District boundary northwesterly to its intersection with the southeasterly boundary of Rudnick Highlands Unit 2 as shown upon that certain map entitled "Map of Rudnick Highlands Subdivision No. Two" filed December 12, 1955 in Book 8 of Maps at Page 109, Marin County Records; thence leaving said northeasterly line of Olive Avenue and continuing along said Sanitary District boundary and crossing to the southwesterly line of Olive Avenue southwest; running thence along said southwesterly line of Olive Avenue and along said Sanitary District boundary southeasterly to the northeasterly corner of Lot 1 as shown upon that certain map entitled "Map of Valley Oak Estates, filed January 31, 1974 in Volume 15 of Maps at Page 94, Marin County Records; thence leaving said southwesterly line of Olive Avenue and continuing along said Sanitary District boundary Southwesterly and Southeasterly to a point on the easterly line of Lot 6 (Rack 2 Pull 3); thence leaving said Sanitary District boundary and running along said easterly line of lot 6 North $6^{\circ} 50'$ East 871 feet to a point on said southwesterly line of Olive Avenue; thence crossing said Olive Avenue northerly 60 feet, more or less to the point of beginning.

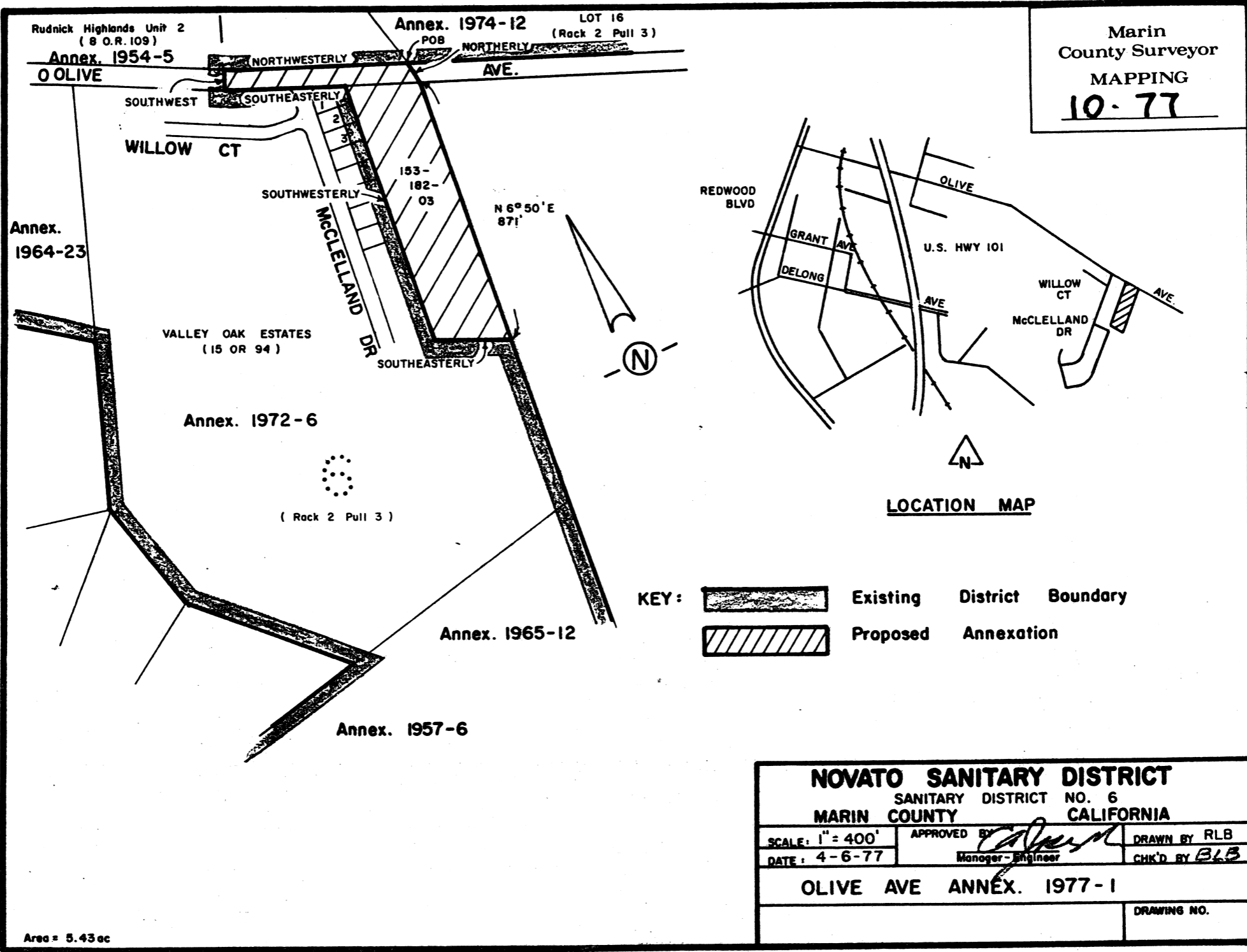

BOOK 3680 PAGE 503

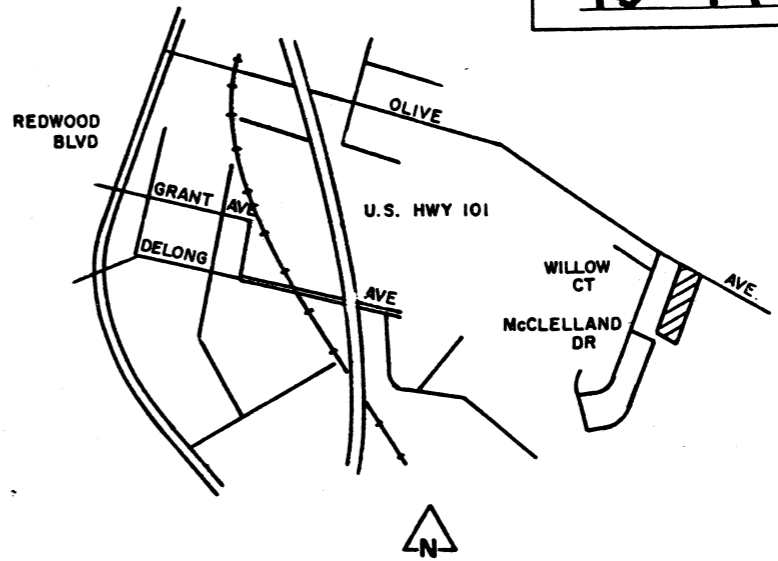

Marin County Surveyor
 MAPPING
 10-77



LOCATION MAP

KEY:  Existing District Boundary
 Proposed Annexation

Area = 5.43 ac

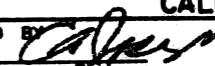
NOVATO SANITARY DISTRICT		
SANITARY DISTRICT NO. 6		
MARIN COUNTY CALIFORNIA		
SCALE: 1" = 400'	APPROVED BY 	DRAWN BY RLB
DATE: 4-6-77	Manager-Engineer	CHK'D BY BLB
OLIVE AVE ANNEX. 1977-1		
		DRAWING NO.