

LOCAL AGENCY FORMATION COMMISSION OF THE COUNTY OF MARIN

RESOLUTION NO. 69-14

RESOLUTION APPROVING THE ANNEXATION OF TERRITORY TO
SANITARY DISTRICT NO. 6

SUTRO AVENUE ANNEX 1969-5

WHEREAS, a resolution of application No. 1063 has been filed by
Sanitary District No. 6, together with evidence of written
consent of all owners of property within the proposed annexation; and

WHEREAS, the Commission has found the territory to be annexed to be
uninhabited; and

WHEREAS, the Sanitary District No. 6
has not requested the Commission to hold a noticed public hearing in accordance
with Government Code Section 56261.

NOW, THEREFORE, BE IT RESOLVED by the Marin County Local Agency Forma-
tion Commission, in accordance with the District Reorganization Act of 1965, that
it does hereby approve the annexation of territory known as Sutro Avenue
Annex 1969-5 to Sanitary District No. 6

with the following determinations:

1. Sanitary District No. 6 shall
be the conducting District for further proceedings to annex this territory and
the Board of Directors of that District is directed to initiate annexation pro-
ceedings in compliance with this resolution and the resolution of application.
Such proceedings may be without notice, without hearing, and without election.

2. The territory proposed for annexation shall be designated as
Sutro Avenue Annex 1969-5.

PASSED AND ADOPTED by the Marin County Local Agency Formation Commission
on this 10th day of April, 1969 by the following vote:

AYES: Commissioners Dyk, Womack, Arrigoni, Marchant

NOES: None

ABSENT: Commissioner Wornum

Chairman of the Local Agency Formation
Commission of the County of Marin

ATTEST:



Executive Officer

SANITARY DISTRICT NO. 6 OF MARIN COUNTY

SUTRO AVENUE ANNEX 1969-5

EXHIBIT "A"

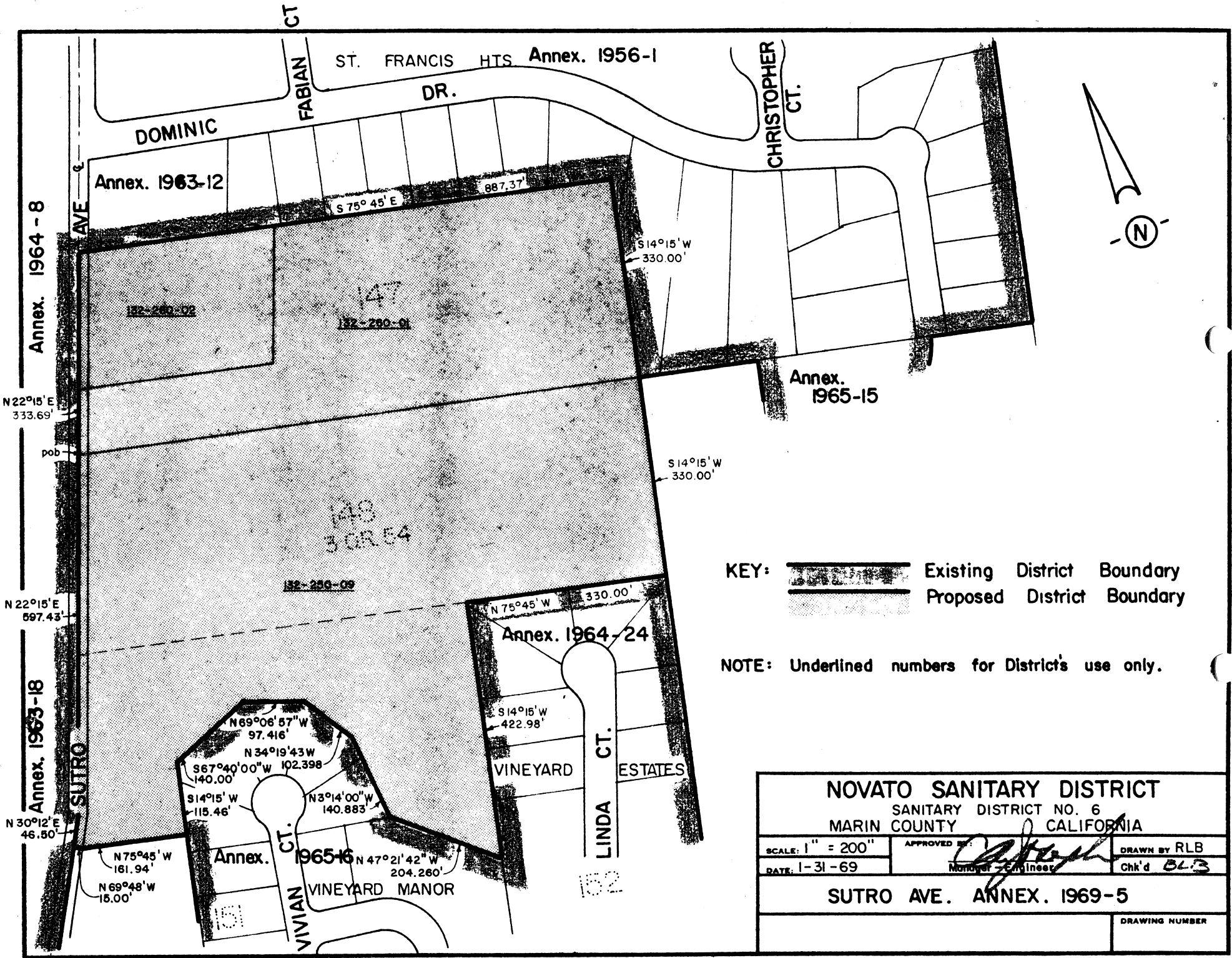
BEGINNING at a point on the existing boundary of Sanitary District No. 6 of Marin County, said point being on the center line of Sutro Avenue at its intersection with the Southerly line of Lot 147, as said Avenue and lot are shown upon that certain map entitled "Amended Map No. 1 of Subdivision 'E' of the Novato Ranch, Marin County, California", filed July 6, 1910 in Book 3 of Maps at Page 54, Marin County Records; thence along said Sanitary District boundary and said center line North 22° 15' East 333.69 feet to the Northwest corner of said Lot 147; thence leaving said center line of Sutro Avenue and running along the Northerly line of said Lot 147 South 75° 45" West 887.37 feet to the Northeasterly corner of said Lot 147; thence along the Easterly line of said Lot 147 South 14° 15' West 330.00 feet to the Southeasterly corner of said Lot 147, said corner also being the Northeasterly corner of Lot 148 as shown upon that certain map hereinabove mentioned; thence leaving said Sanitary District boundary and running along the Easterly line of said Lot 148 South 14° 15' West 330.00 feet to a point on said Sanitary District boundary, said point also being the Southeasterly corner of said Lot 148; thence running along said Sanitary District boundary and along the Southerly line of said Lot 148 North 75° 45' West 330.00 feet to the dividing line between Lot 151 and Lot 152 as said lots are shown upon that certain map hereinabove mentioned; thence leaving said Southerly line of Lot 148 and running along said Sanitary District boundary and said dividing line South 14° 15' West 422.98 feet; thence leaving said dividing line between Lot 151 and Lot 152 and continuing along said Sanitary District boundary North 47° 21' 42" West 204.260 feet; thence North 3° 14' 00" West 140.883 feet; thence North 34° 19' 43" West 102.398 feet; thence North 69° 06' 57" West 97.416 feet; thence South 67° 40' 00" West 140.00 feet; thence South 14° 15' West 115.46 feet; thence leaving said Sanitary District boundary North 75° 45' West 161.94 feet to a point on the Easterly line of said Sutro Avenue; thence leaving said Easterly line of Sutro Avenue North 69° 48' West 15.00 feet to a point on said Sanitary District boundary and said center line of Sutro Avenue; thence along said Sanitary District boundary and said center line of Sutro Avenue North 30° 12' East 46.50 feet to an angle point in said center line of Sutro Avenue; thence North 22° 15' East 597.43 feet to the point of beginning.



KEY:  Existing District Boundary
 Proposed District Boundary

NOTE: Underlined numbers for District's use only.

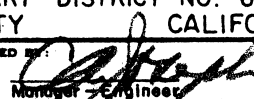
NOVATO SANITARY DISTRICT		
SANITARY DISTRICT NO. 6		
MARIN COUNTY CALIFORNIA		
SCALE: 1" = 200'	APPROVED BY: 	DRAWN BY RLB
DATE: 1-31-69	Monitor - Engineer	Chk'd BLS
SUTRO AVE. ANNEX. 1969-5		
		DRAWING NUMBER