

LOCAL AGENCY FORMATION COMMISSION OF MARIN COUNTY

RESOLUTION NO. 78-24

RESOLUTION MAKING DETERMINATIONS APPROVING ANNEXATION OF THE
SUN LANE ISLAND ANNEXATION

WHEREAS, the City Council representing the City of Novato adopted a resolution initiating proceedings No. 100-78 and submitted same to the Executive Officer of this Commission; and,

WHEREAS, said resolution proposed annexation of unincorporated island territory to the City of Novato in compliance with state law; and,

WHEREAS, the Executive Officer of this Commission has issued a certificate of filing, accepting said legal documents completed by the City of Novato and,

WHEREAS, legal notice of hearing was published and mailed notice of hearing was provided in accordance with state requirements; and,

WHEREAS, the Marin Local Agency Formation Commission conducted a public hearing, at which time all persons present were given an opportunity to speak and be heard regarding this annexation proposal; and,

WHEREAS, the Commission considered the Executive Officer's report and recommendations.

NOW, THEREFORE, the Local Agency Formation Commission of the County of Marin, DOES HEREBY RESOLVE, DETERMINE AND ORDER as follows:

Section 1. The boundaries of the inhabited territory proposed to be annexed shall be those set forth in Exhibit A, attached hereto and incorporated herein, and said territory shall be designated as "Sun Lane Island Annexation".

Section 2. The Marin Local Agency Formation Commission hereby adopts the following findings of fact: The subject territory contained in this proposal (a) does not exceed 100 acres in area, which area constitutes the entire island; (b) is surrounded by the city; (c) is developed ; (d) is not prime agricultural land; and, (e) will benefit from municipal annexation.

Section 3. The Sun Lane Island Annexation is hereby approved.

Section 4. In accordance with applicable provisions contained in the adopted Marin Lafco environmental guidelines and procedures, the City of Novato is the appropriate lead agency, has conducted an initial study incorporating concerns of said Commission, a responsible agency, and has issued a Negative Declaration. Lafco hereby certifies that the Commission has considered said documents.

Section 5. The Marin County Board of Supervisors is hereby determined to be the appropriate conducting authority, to direct complete annexation proceedings, and authorized to proceed.

Section 6. The Executive Officer is hereby authorized to mail certified copies of this resolution in the manner and as prescribed by law.

PASSED AND ADOPTED by the Marin Local Agency Formation Commission on this 13th day of December 1978 by the following vote:

AYES: Commissioners Baptiste, Haehl, Rice, Violich and Mulryan

NOES: None

ABSENT: None

LAWRENCE E. MULRYAN, Chairman
Marin Local Agency Formation Commission

ATTEST:

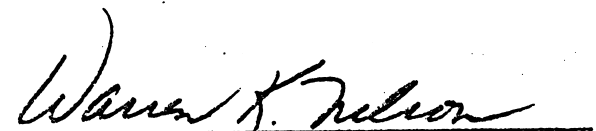
WARREN K. NELSON, Executive Officer

DATE: December 14, 1978

EXHIBIT "A"

Legal Description

Sun Lane Island Annexation

Beginning at the northwest corner of that certain parcel of land granted to Russell Pool and Hazel Pool, his wife, by deed recorded in Book 2123 at Page 95, Official Records, Marin County, California, said corner being on the Novato City Limits Line and also on the southerly right-of-way line of Center Road; thence along said right-of-way line South 75°45'00" East 330.00 feet to the northwest corner of that certain parcel of land granted to Sam E. Mello and Betty W. Mello, his wife, by deed recorded in Book 1951 at Page 314, Marin County Records; thence leaving said right-of-way line, South 14°15'00" West 967.08 feet to the southeast corner of that parcel of land granted to Raymond R. Rediske and Margaret H. Rediske, his wife, by deed recorded in Book 1253 at Page 93, Marin County Records; thence North 80°08'00" West 330.96 feet to the southwest corner of that certain parcel of land granted to George Rae Angus, Jr. and Doris H. Angus, his wife, by deed recorded in Book 2207 at Page 234, Marin County Records; thence North 14°15'00" East 992.49 feet to the point of beginning.

Said parcel containing 7.42 acres more or less.

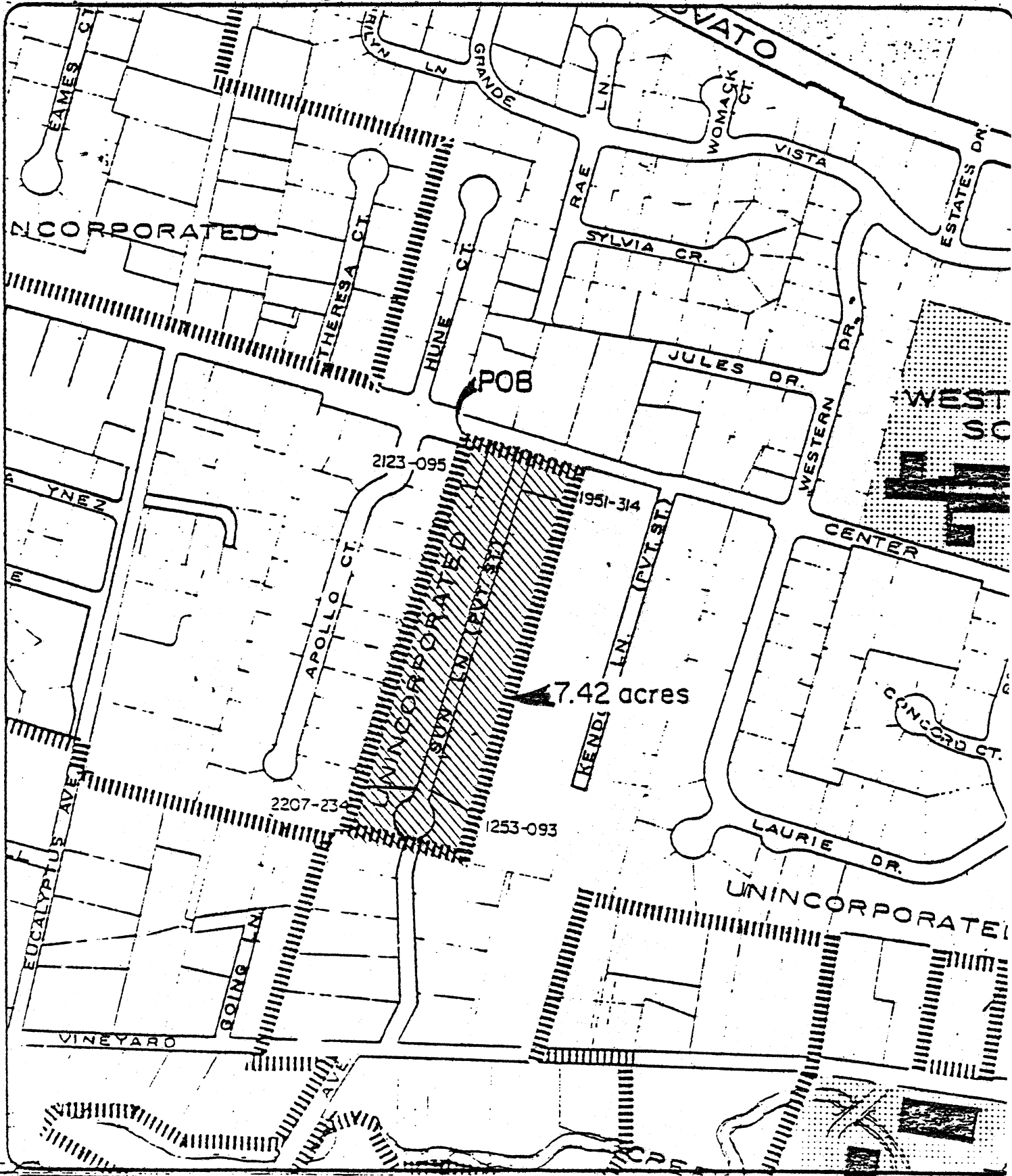

NOVATO PLANNING DEPARTMENT
 SUN LANE ISLAND ANNEXATION
 scale: 1" = 300 FT.
 date: JUNE 1978

 NORTH
 no. 105 A