

LOCAL AGENCY FORMATION COMMISSION OF THE COUNTY OF MARIN

RESOLUTION NO. 66-12

RESOLUTION APPROVING THE ANNEXATION OF TERRITORY TO:

SANITARY DISTRICT NO. 6:

BEECK ANNEXATION (1966-4)

---

WHEREAS, a resolution of application has been filed, together with evidence of written consent of all owners of property within the proposed annexation; and

WHEREAS, the Commission has found the territory to be annexed to be uninhabited; and

WHEREAS, the Sanitary District No. 6 has not requested the Commission to hold a noticed public hearing in accordance with Government Code Section 56261.

NOW, THEREFORE, BE IT RESOLVED by the Marin County Local Agency Formation Commission, in accordance with the District Reorganization Act of 1965, that it does hereby approve the annexation of territory known as Beeck Annexation (1966-4) to the Sanitary District No. 6 with the following determinations:

1. Sanitary District No. 6 shall be the conducting district for further proceedings to annex this territory and the Board of Directors of that District is directed to initiate annexation proceedings in compliance with this resolution. Such proceedings may be without notice of hearing and without election.

2. The territory proposed for annexation shall be designated as Beeck Annexation (1966-4).

PASSED AND ADOPTED by the Marin County Local Agency Formation Commission on this 5th day of May, 1966 by the following vote:

AYES: COMMISSIONERS Peter H. Behr, Wayne Womack, Jan Paul Dyk, and H. G. Marchant.

NOES: COMMISSIONERS None.

ABSENT: COMMISSIONERS Byron W. Leydecker.

  
\_\_\_\_\_  
CHAIRMAN OF THE LOCAL AGENCY FORMATION  
COMMISSION

ATTEST:

  
\_\_\_\_\_  
EXECUTIVE OFFICER



SANITARY DISTRICT NO. 6 OF MARIN COUNTY

BEECK ANNEX 1966-4

EXHIBIT "A"

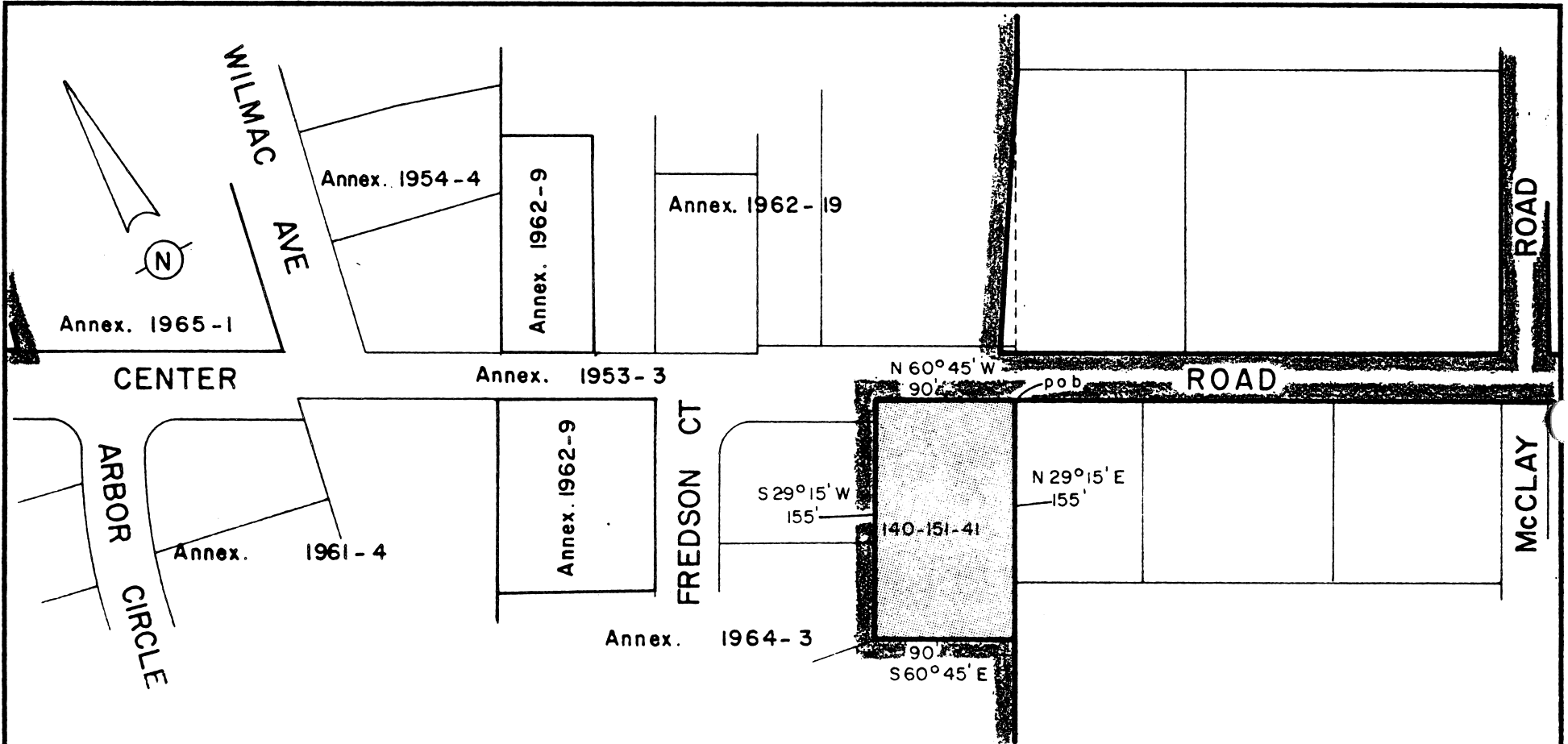
BEGINNING at a point on the existing boundary of Sanitary District No. 6 of Marin County, Calif., said point of beginning being at the intersection of the Southerly line of Center Road with the Easterly line of Lot 124, as said line and lot appear on that certain map entitled, "Map of Subdivision A and B of the Novato Ranch, Marin County, Calif.", filed November 18, 1909 in Book 3 of Maps at Page 36, Marin County Records; running thence along said Sanitary District boundary and said Southerly line of Center Road North  $60^{\circ} 45'$  West 90 feet; thence leaving said Southerly line of Center Road South  $29^{\circ} 15'$  West 155 feet; thence South  $60^{\circ} 45'$  East 90 feet to said Easterly line of Lot 124; thence leaving said Sanitary District boundary and running along said Easterly line of Lot 124 North  $29^{\circ} 15'$  East 155 feet to the point of beginning.

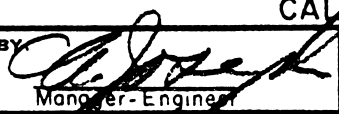

KEY:  Existing District Boundary  
 Proposed District Boundary

<b>NOVATO SANITARY DISTRICT</b>		
( Sanitary District No. 6 )		
MARIN COUNTY		CALIFORNIA
SCALE: 1" = 100'	APPROVED BY 	DRAWN BY RLB
DATE: 3-3-66	Manager-Engineer	REVISED
<b>BEECK ANNEX. 1966-4</b>		
		DRAWING NUMBER