

LOCAL AGENCY FORMATION COMMISSION OF THE COUNTY OF MARIN

RESOLUTION NO. 67-1

SANITARY DISTRICT NO. 6:

BEL MARIN KEYS PUMP STATION NO. 5 SITE ANNEXATION

---

WHEREAS a resolution for the proposed annexation of certain territory to Sanitary District No. 6 in the County of Marin was heretofore filed with the Executive Officer of this Local Agency Formation Commission, and said Executive Officer has examined said resolution and found it to be mandatory; and

WHEREAS at times and in the form and manner provided by law, said Executive Officer has given notice of a public hearing by this Commission upon said resolution; and

WHEREAS, the public hearing by this Commission was held upon the date and at the time and place specified in said notice of public hearing.

NOW, THEREFORE, THE LOCAL AGENCY FORMATION COMMISSION OF THE COUNTY OF MARIN DOES HEREBY RESOLVE, DETERMINE AND ORDER as follows:

1. The resolution of Sanitary District No. 6 proposing annexation of certain territory in Marin County is approved.
2. The territory proposed for annexation is found to be uninhabited.
3. The territory proposed for annexation shall be designated as Bel Marin Keys Pump Station No. 5 Site Annexation.
4. Sanitary District No. 6 shall be the conducting district for further proceedings to annex this territory and the Board of Directors of that district is directed to initiate annexation proceedings in compliance with this resolution, and this annexation may be approved without notice and hearing and without an election.
5. Any resolution of the conducting district ordering such annexation shall provide that the annexation shall be subject to the terms and conditions contained in the resolution of application.
6. The Executive Officer is hereby authorized and directed to mail certified copies of this resolution in the manner as provided in Section 56272 of the Government Code.

PASSED AND ADOPTED by the Marin County Local Agency Formation Commission on this 5th day of January, 1967 by the following vote:

Ayes: Commissioners Jan Paul Dyk, Peter H. Behr, J. Wayne Womack, H. G. Marchant,  
Thomas T. Storer.  
Noes: None.  
Absent: None.

  
\_\_\_\_\_  
Chairman, Local Agency Formation Commission

Attest:

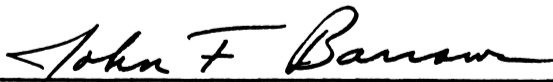
  
\_\_\_\_\_  
Executive Officer



SANITARY DISTRICT NO. 6 OF MARIN COUNTY

BEL MARIN KEYS PUMP STATION NO. 5 SITE ANNEX 1966-13

EXHIBIT "A"

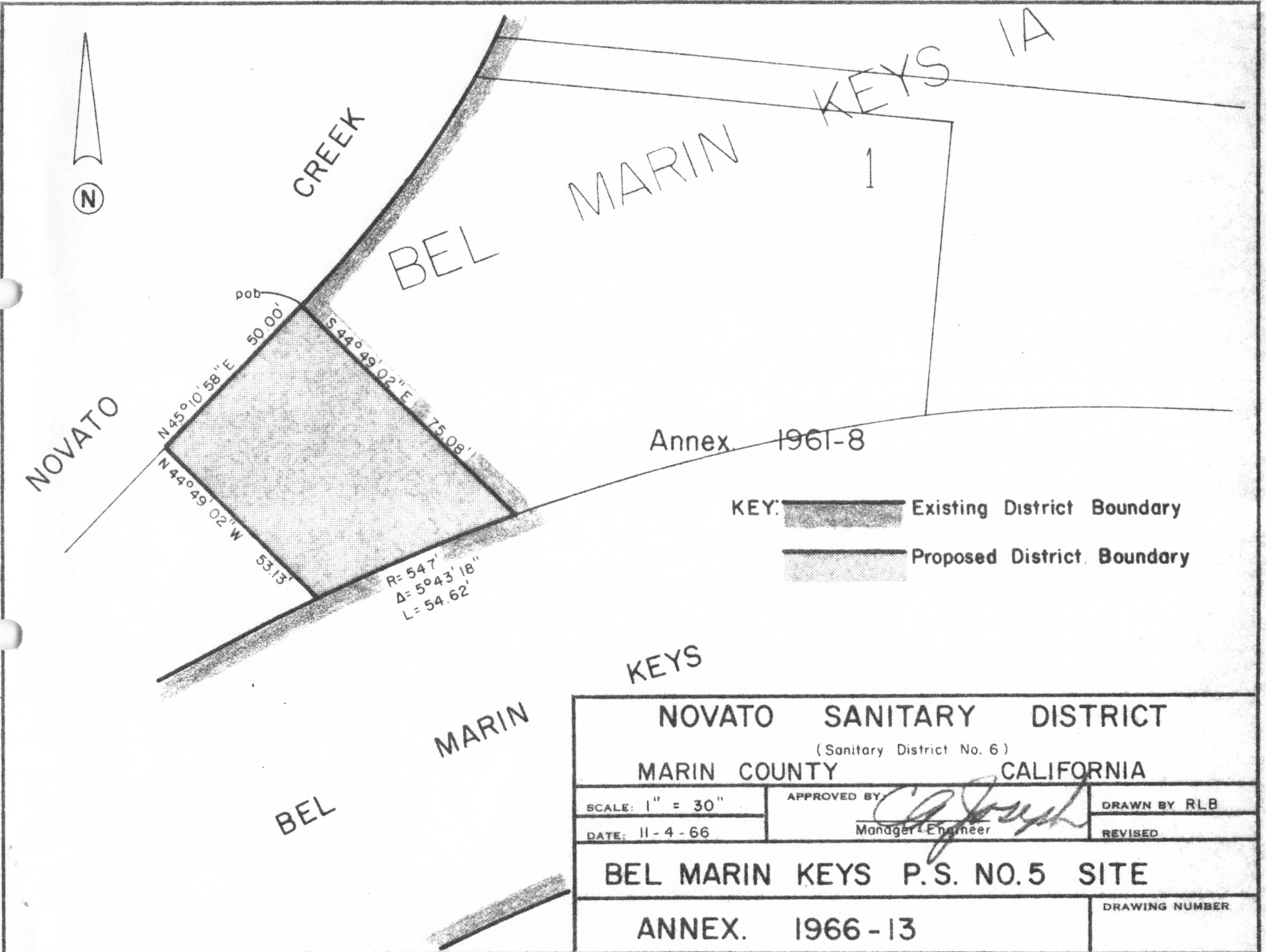
BEGINNING at a point on the existing boundary of Sanitary District No. 6 of Marin County, said point being the most Westerly corner of Lot 1 as shown upon that certain map entitled, "Bel Marin Keys Unit No. 1-A", Marin County, California", filed January 14, 1963 in Volume 11 of Maps at Page 58, Marin County Records; running thence from said point of beginning along said Sanitary District boundary and along the Southwesterly line of said Lot 1 South  $44^{\circ} 49' 02''$  East 75.08 feet to a point on the Northerly line of Bel Marin Keys Boulevard; thence leaving said Southwesterly line of Lot 1 and running along said Northerly line of Bel Marin Keys Boulevard, Southwesterly on a curve to the left, having a radius of 547 feet, through a central angle of  $5^{\circ} 43' 18''$ , a distance of 54.62 feet; thence leaving said Sanitary District boundary and said Northerly line of Bel Marin Keys Boulevard North  $44^{\circ} 49' 02''$  West 53.13 feet; thence North  $45^{\circ} 10' 58''$  East 50.00 feet to the point of beginning.

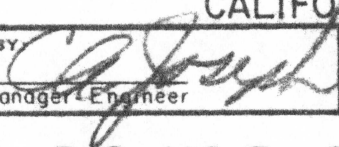

KEY:  Existing District Boundary  
 Proposed District Boundary

<b>NOVATO SANITARY DISTRICT</b> (Sanitary District No. 6) <b>MARIN COUNTY CALIFORNIA</b>		
SCALE: 1" = 30"	APPROVED BY: 	DRAWN BY RLB
DATE: 11-4-66	Manager/Engineer	REVISED
<b>BEL MARIN KEYS P.S. NO. 5 SITE</b>		
ANNEX. 1966-13		DRAWING NUMBER